



## **CURRITUCK COUNTY NORTH CAROLINA**

July 10, 2018

Minutes – Regular Meeting of the Planning Board

### **WORK SESSION**

A work session was held at 3:30 PM in the Senior Center before the regular meeting with staff and board members. Senior Planner Tammy Glave reviewed the text amendment request to allow automotive painting/body shops in the General Business (GB) Zoning District. The work session adjourned at 3:55 PM.

### **CALL TO ORDER**

The Currituck County Planning Board met at 4:00 PM in the Currituck County Senior Center, 103 Community Way, Barco, North Carolina.

<b>Attendee Name</b>	<b>Title</b>	<b>Status</b>	<b>Arrived</b>
Fred Whiteman	Chairman	Absent	
C. Shay Ballance	Vice Chairman	Present	
Carol Bell	Board Member	Present	
Steven Craddock	Board Member	Present	
John McColley	Board Member	Present	
Jeff O'Brien	Board Member	Present	
Jane Overstreet	Board Member	Present	
J. Timothy Thomas	Board Member	Absent	
Laurie LoCicero	Planning and Community Department Director	Present	
Tammy Glave	Planning and Community Development Senior Planner	Present	
Cheri Elliott	Clerk to the Board	Present	

Vice Chairman Ballance called the meeting to order.

#### **A. Pledge of Allegiance & Moment of Silence**

Vice Chairman Ballance asked everyone to stand for the Pledge of Allegiance and a moment of silence.

#### **B. Ask for Disqualifications**

Vice Chairman Ballance asked if any board member had a conflict of interest with the matter coming before the board. Mr. Craddock said he has done business with Mr. Winslow in the past, but that it would not effect his decision. There was no opposition to this disclosure.

#### **C. Announce Quorum Being Met**

Vice Chairman Ballance announced a quorum being met with six board members present.

**D. Approval of Agenda**

Vice Chairman Ballance asked if there were any changes to the agenda for tonight's meeting. With no changes noted, Mr. Craddock motioned to approve the agenda as presented. Mr. O'Brien seconded the motion and the motion carried unanimously.

<b>RESULT:</b>	<b>APPROVED [UNANIMOUS]</b>
<b>AYES:</b>	C. Shay Ballance, Vice Chairman, Carol Bell, Board Member, Steven Craddock, Board Member, John McColley, Board Member, Jeff O'Brien, Board Member, Jane Overstreet, Board Member
<b>ABSENT:</b>	Fred Whiteman, Chairman, J. Timothy Thomas, Board Member

**APPROVAL OF MINUTES FOR JUNE 12, 2018**

Vice Chairman Ballance asked if any changes were needed for the meeting minutes of June 12, 2018. With no changes noted, Mr. Craddock motioned to approve the minutes as presented. Mr. O'Brien seconded the motion and the motion carried unanimously.

<b>RESULT:</b>	<b>APPROVED [UNANIMOUS]</b>
<b>AYES:</b>	C. Shay Ballance, Vice Chairman, Carol Bell, Board Member, Steven Craddock, Board Member, John McColley, Board Member, Jeff O'Brien, Board Member, Jane Overstreet, Board Member
<b>ABSENT:</b>	Fred Whiteman, Chairman, J. Timothy Thomas, Board Member

**OLD BUSINESS**

There was no old business discussed.

**NEW BUSINESS****A. PB 18-17 Jay Winslow and Jason Graham:**

Senior Planner Tammy Glave presented the staff report. The text amendment is requesting painting/body shops be allowed in the General Business (GB) zoning district. Currently automobile repair and servicing is allowed as a permitted use in GB. In the past, the noxious fumes and pollutants emitted from paint booths were an environmental concern and one reason automotive painting/body shops were placed in our industrial zoning districts. The Environmental Protection Agency (EPA) now strictly governs paint and auto body shops to reduce emissions (cadmium, chromium, lead, manganese, and nickel) emitted during the spray application surface coating operation. The EPA requires that all spray booths, stations, and enclosures catch at least 98% of the fumes. Ms. Glave also reviewed the Unified Development Ordinance (UDO) requirements and said painting /body shops standards are within the Light Automobile Repair and Servicing section.

Ms. Overstreet asked the zoning districts currently allowed for painting/body shops and Ms. Glave said the Light Industrial (LI) zoning district and the Heavy Industrial (HI) zoning district.

The applicant, Jay Winslow, came before the board and stated his current address as 115 Deerfield Drive in South Mills.

Mr. O'Brien asked Mr. Winslow his current Environmental Protection Agency (EPA) Compliance Report reading for his spray booth and Mr. Winslow stated 99.3 percent.

Discussion was held on whether the EPA required a yearly testing report for spray booths and Mr. Winslow said it is only required at the start up of the business and is not tested yearly as stated in the staff report. Mr. Glave reviewed the EPA requirements and said she had misread the requirement. She will make the corrections to the staff report memo and the text amendment to reflect the change.

Mr. McColley said he believes this should require a Use Permit. Ms. LoCicero explained the differences in Use Permits and Conditional Rezoning.

Mr. Craddock asked about the landscaping requirements for on the highway and off of the highway businesses of this type. Ms. Glave said both have the same requirements.

Vice Chairman Ballance asked for motion. Mr. Craddock motioned to approve PB 18-17 Jay Winslow and Jason Graham text amendment, striking the section discussed and changing the verbiage concerning the yearly EPA test report. The requested zoning text amendment is consistent with the 2006 Land Use Plan because:

- New and expanding industries and businesses are encouraged, especially those that diversify the local economy, train and use a more highly skilled labor force, and are compatible the environment.
- Small business start-ups are encouraged.
- Site and building design along major highway corridors require improved appearance and development standards (driveway access, landscaping, buffering, signage, lighting, and tree preservation).
- Adequate public facilities must be available to support the request.

Also the request is reasonable and in the public interest because:

- It is consistent with the purpose and intent of Section 1.3 of the UDO.
- It encourages business growth while protecting the aesthetic and environmental aspects of the county.

Mr. O'Brien seconded the motion and the motion carried 5-1 in favor with John McColley voting against the text amendment.

<b>RESULT:</b>	<b>RECOMMENDED APPROVAL [5 TO 1]</b>	<b>Next: 8/6/2018 6:00 PM</b>
<b>AYES:</b>	C. Shay Ballance, Vice Chairman, Carol Bell, Board Member, Steven Craddock, Board Member, Jeff O'Brien, Board Member, Jane Overstreet, Board Member	
<b>NAYS:</b>	John McColley, Board Member	
<b>ABSENT:</b>	Fred Whiteman, Chairman, J. Timothy Thomas, Board Member	

## ANNOUNCEMENTS

There were no announcements.

## ADJOURNMENT

Mr. Craddock motioned to adjourn the meeting. Mr. O'Brien seconded the motion and the motion carried unanimously. Meeting adjourned at 4:24 PM.



## Currituck County

Planning and Community Development Department  
*Planning and Zoning Division*  
 153 Courthouse Road, Suite 110  
 Currituck, North Carolina 27929  
 252-232-3055 FAX 252-232-3026

To: Board of Commissioners

From: Planning Staff

Date: July 11, 2018

Subject: PB 18-17 Jay Winslow and Jason Graham Text Amendment

In the current UDO "Automotive Painting/Body Shop" is only allowed in the LI (Light Industrial) and HI (Heavy Industrial) zoning districts. The applicants are requesting that painting/body shops be allowed in the GB (General Business) zoning district. Currently automobile repair and servicing is allowed as a permitted use in GB. In the past, the noxious fumes and pollutants emitted from paint booths were an environmental concern and one reason automotive painting/body shops were placed in our industrial zoning districts. The EPA (Environmental Protection Agency) now strictly governs paint and auto body shops to reduce emissions (cadmium, chromium, lead, manganese, and nickel) emitted during the spray application surface coating operation. The EPA requires that all spray booths, stations, and enclosures catch at least 98% of the fumes.

In addition to the initial Environmental Protection Agency Compliance Report, the UDO requirements for automobile repair and servicing would apply to automotive painting/body shop to protect neighboring properties:

- (a) The repair facility shall be located at least 125 feet from any residential district, school (except vocational school), or child care center.
- (b) Repair of all vehicles shall occur within an enclosed building. Temporary outdoor vehicle storage may be allowed in an outdoor storage area that is no larger than 25 percent of the buildable area of the lot, located behind or to the side of the principal structure, and screened in accordance with Section 4.3.3.R, Outdoor Storage.
- (c) If gasoline is sold on-site, the use shall also comply with the standards for a gasoline sales use in Section 4.3.3.K Gasoline Sales
- (d) Vehicles shall not be parked or stored as a source of parts or the purpose of sale or lease/rent.
- (e) Vehicles that are repaired and are awaiting removal shall not be stored or parked for more than 30 consecutive days. In cases where a vehicle is abandoned by its lawful owner before or during the repair process, the vehicle may remain on site as long as is necessary after the 30 day period, provided the owner or operator of the establishment demonstrates steps have been taken to remove the vehicle from the premises using the appropriate legal means.

**Staff Recommendation:**

Staff recommends approval of the proposed text amendment due to its consistency with the Land Use Plan and the UDO. The text amendment is reasonable and in the public interest because it promotes economic growth and small business startups while protecting the environment from a previously less regulated, noxious, more intense use. Staff recommends that a copy of the EPA initial compliance report be provided to the county as well as any change notification reports.

**Planning Board Recommendation – July 10, 2018:**

Planning Board recommends approval of the proposed text amendment with a copy of the initial EPA compliance report to be provided to the county as well as any change notification reports.

**Planning Board Motion:**

Mr. Craddock motioned to approve PB 18-17 Jay Winslow and Jason Graham text amendment, striking the section discussed and changing the verbiage concerning the yearly EPA test report. The requested zoning text amendment is consistent with the 2006 Land Use Plan because:

- New and expanding industries and businesses are encouraged, especially those that diversify the local economy, train and use a more highly skilled labor force, and are compatible the environment.
- Small business start-ups are encouraged.
- Site and building design along major highway corridors require improved appearance and development standards (driveway access, landscaping, buffering, signage, lighting, and tree preservation).
- Adequate public facilities must be available to support the request.

Also the request is reasonable and in the public interest because:

- It is consistent with the purpose and intent of Section 1.3 of the UDO.
- It encourages business growth while protecting the aesthetic and environmental aspects of the county.

Mr. O'Brien seconded the motion and the motion carried unanimously.

**RESULT: RECOMMENDED APPROVAL [UNANIMOUS]**

**AYES:** C. Shay Ballance, Vice Chairman, Carol Bell, Board Member, Steven Craddock, Board Member, John McColley, Board Member, Jeff O'Brien, Board Member, Jane Overstreet, Board Member

**ABSENT:** Fred Whiteman, Chairman, J. Timothy Thomas, Board Member

**Planning Board Discussion:**

Senior Planner Tammy Glave presented the staff report. The text amendment is requesting painting/body shops be allowed in the General Business (GB) zoning district. Currently automobile repair and servicing is allowed as a permitted use in GB. In the past, the noxious fumes and pollutants emitted from paint booths were an environmental concern and one

reason automotive painting/body shops were placed in our industrial zoning districts. The Environmental Protection Agency (EPA) now strictly governs paint and auto body shops to reduce emissions (cadmium, chromium, lead, manganese, and nickel) emitted during the spray application surface coating operation. The EPA requires that all spray booths, stations, and enclosures catch at least 98% of the fumes. Ms. Glave also reviewed the Unified Development Ordinance (UDO) requirements and said painting /body shops standards are within the Light Automobile Repair and Servicing section.

Ms. Overstreet asked the zoning districts currently allowed for painting/body shops and Ms. Glave said the Light Industrial (LI) zoning district and the Heavy Industrial (HI) zoning district.

The applicant, Jay Winslow, came before the board and stated his current address as 115 Deerfield Drive in South Mills.

Mr. O'Brien asked Mr. Winslow his current Environmental Protection Agency (EPA) Compliance Report reading for his spray booth and Mr. Winslow stated 99.3 percent.

Discussion was held on whether the EPA required a yearly testing report for spray booths and Mr. Winslow said it is only required at the startup of the business and is not tested yearly as stated in the staff report. Mr. Glave reviewed the EPA requirements and said she had misread the requirement. She will make the corrections to the staff report memo and the text amendment to reflect the change.

Mr. McColley said he believes this should require a Use Permit. Ms. LoCicero explained the differences in Use Permits and Conditional Rezoning.

Mr. Craddock asked about the landscaping requirements for on the highway and off of the highway businesses of this type. Ms. Glave said both have the same requirements.

**PB 18-17**  
**Jay Winslow and Jason Graham**

Amendment to the Unified Development Ordinance Chapter 4: Use Standards, to an automotive paint/body shop in the GB zoning district.

BE IT ORDAINED by the Board of Commissioners of the County of Currituck, North Carolina that the Unified Development Ordinance of the County of Currituck be amended as follows:

**Item 1:** That Chapter 4 is amended by adding the following bold underlined language and deleting the strikethrough language in Section 4.1.2 Use Table:

**TABLE 4.1.1: SUMMARY USE TABLE**

Z = Zoning Compliance Permit; U = Use Permit; MP = Allowed with Master Plan;  
 CZ= Allowed in a Conditional Zoning District blank cell = Prohibited

USE CATEGORY	USE TYPE	ZONING DISTRICT (CURRENT DISTRICT IN PARENTHESIS) [NOTE: OVERLAY OR SUB-DISTRICT REQUIREMENTS MAY FURTHER LIMIT USES]															ADDITIONAL REQ. (4.2.-----)		
		RC	AG	SFM	SFO	SFR	SFI	MXR	GB	LB	CC	VC	LI	HI	PD-R	PD-M		PD-O	
COMMERCIAL USE CLASSIFICATION																			
Vehicle Sales and Services, Light	Automotive parts and installation									Z		Z	Z	Z			M P	M P	4.1.1
	Automobile repair and servicing <i>(without including painting/bodywork)</i>									Z		Z	Z	Z			M P	M P	4.1.2
	Automobile sales or rentals									U		Z	Z	Z			M P	M P	4.1.3
	Car wash or auto detailing									Z		Z	Z	Z		M P	M P	M P	4.1.4
	Taxicab service									Z	Z	Z	Z			M P	M P	M P	4.1.5
Vehicle Sales and Services, Heavy	Aircraft parts, sales, and maintenance													Z	Z				
	<i>Automotive painting/body shop</i>													Z	Z				<i>4.H. 1</i>
	Automotive wrecker service													Z	Z			M P	4.H. 2
	Boat and marine rental, sales, and service									Z				Z	Z				4.H. 3

**Item 2:** That Chapter 4 is amended by deleting the strikethrough language in Section 4.1.2.4 Commercial Uses:

A. Vehicle Sales and Services, Heavy (sections to be renumbered accordingly)

B. ~~Automotive Painting/Body Shop~~

Attachment: 18-17 J and J Autobody Shop TA PB (PB 18-17 Jay Winslow and Jason Graham)



~~Automobile painting/body shop uses shall comply with the following standards:~~

- ~~a. The use shall be located at least 250 feet from any residential district, school (except vocational schools), or child care center.~~
- ~~b. Vehicles shall not be parked or stored as a source of parts or for the purpose of sale or lease/rent.~~
- ~~c. Repair and storage of all vehicles shall occur within an enclosed building. Temporary outdoor vehicle storage may be allowed in an outdoor storage area that is no larger than 25 percent of the buildable area of the lot, located behind or to the side of the principal structure, and screened in accordance with Section 4.3.3.R, Outdoor Storage.~~
- ~~d. Vehicles that are repaired and are awaiting removal shall not be stored or parked for more than 30 consecutive days. In cases where a vehicle is abandoned by its lawful owner before or during the repair process, the vehicle may remain on site as long as is necessary after the 30 day period, provided the owner or operator of the establishment demonstrates steps have been taken to remove the vehicle from the premises using the appropriate legal means.~~

**Item 3: That Chapter 4 is amended by adding the following bold underlined language and deleting the strikethrough language in Section 4.2.4 Commercial Uses:**

**I. Vehicle Sales and Services, Light**

**2) Automotive Repair and Service (~~Without~~ including Painting/Body Shop)**

- (f) Painting/body shop operations must provide the department with the initial Environmental Protection Agency Compliance Report and any subsequent change notification reports.**

**Item 4: Statement of Consistency and Reasonableness:**

The requested zoning text amendment is consistent with the 2006 Land Use Plan because:

- New and expanding industries and businesses are encouraged, especially those that diversify the local economy, train and use a more highly skilled labor force, and are compatible the environment. POLICY ED1
- Small business start-ups are encouraged. POLICY ED4
- Site and building design along major highway corridors require improved appearance and development standards (driveway access, landscaping, buffering, signage, lighting, and tree preservation). POLICY CA1:
- Adequate public facilities must be available to support the request. POLICY PP2:

The request is reasonable and in the public interest because:

- It is consistent with the purpose and intent of Section 1.3 of the UDO.

- It encourages business growth while protecting the aesthetic and environmental aspects of the county.

**Item 5:** The provisions of this Ordinance are severable and if any of its provisions or any sentence, clause, or paragraph or the application thereof to any person or circumstance shall be held unconstitutional or violative of the Laws of the State of North Carolina by any court of competent jurisdiction, the decision of such court shall not affect or impair any of the remaining provisions which can be given effect without the invalid provision or application.

**Item 6:** This ordinance amendment shall be in effect from and after the \_\_\_\_ day of \_\_\_\_\_, 2018.

\_\_\_\_\_  
Board of Commissioners' Chairman  
Attest:

\_\_\_\_\_  
Leeann Walton  
Clerk to the Board

DATE ADOPTED: \_\_\_\_\_  
MOTION TO ADOPT BY COMMISSIONER: \_\_\_\_\_  
SECONDED BY COMMISSIONER: \_\_\_\_\_  
VOTE: \_\_\_\_AYES \_\_\_\_NAYS  
.....

PLANNING BOARD DATE: 7/10/18  
PLANNING BOARD RECOMMENDATION: Approved  
VOTE: 5 AYES 0 NAYS  
ADVERTISEMENT DATE OF PUBLIC HEARING: 7/25/18 & 8/1/18  
BOARD OF COMMISSIONERS PUBLIC HEARING: 8/6/18  
BOARD OF COMMISSIONERS ACTION: \_\_\_\_\_  
POSTED IN UNIFIED DEVELOPMENT ORDINANCE: \_\_\_\_\_  
AMENDMENT NUMBER: \_\_\_\_\_

Attachment: 18-17 J and J Autobody Shop TA PB (PB 18-17 Jay Winslow and Jason Graham)



## Text Amendment Application

**OFFICIAL USE ONLY:**

Case Number: \_\_\_\_\_  
 Date Filed: \_\_\_\_\_  
 Gate Keeper: \_\_\_\_\_  
 Amount Paid: \_\_\_\_\_

**Contact Information**
**APPLICANT:**

Name: Jay Winslow / Jason Graham  
 Address: 1140 Deerfield Drive  
South Mills NC 27976  
 Telephone: 252-562-2916 (Jay) 252-619-2313 (Jason)  
 E-Mail Address: g2autobodyandpaint@gmail.com

**Request**

I, the undersigned, do hereby make application to change the Currituck County UDO as herein requested.

Amend Chapter(s) 4.2 Section(s) H & I-2 as follows:

We are requesting to change Auto Paint/Body (4.2-H)  
which requires LI or HI zoning, and move  
that under Light Auto Services allowing  
paint/body repair in GB zone. (4.2-I2)

\*Request may be attached on separate paper if needed.

[Signature]  
 Petitioner

6/6/18  
 Date

**Text Amendment Submittal Checklist**

Staff will use the following checklist to determine the completeness of your application. Only complete applications will be accepted.

## Text Amendment Submittal Checklist

Date Received: \_\_\_\_\_

Project Name: Graham's Collision Center

Applicant/Property Owner: Jason Graham / Jay Winslow

**Text Amendment Submittal Checklist**

1	Complete Text Amendment application	
2	Application fee (\$150)	
3	2 hard copies of ALL documents	
4	1 PDF digital copy of all documents (ex. Compact Disk – e-mail not acceptable)	

**For Staff Only****Pre-application Conference**

Pre-application Conference was held on \_\_\_\_\_ and the following people were present:

\_\_\_\_\_  
\_\_\_\_\_

**Comments**

\_\_\_\_\_  
\_\_\_\_\_  
\_\_\_\_\_

# **PAINT ARRESTANCE FILTER TEST REPORT** **Spray Removal Efficiency & Paint Holding Capacity**

Tested for: Air Flow Technology Inc.  
 Filter Mfr.: Air Flow Technology Inc.  
 Filter Name: 22 Grams Paint Arrestor  
 Report#/Test#: R 661 T 761  
 Report Date: March 16, 2005

## **Test Information**

### **FILTER DESCRIPTION:**

White/Yellow highloft fiberglass

### **PAINT DESCRIPTION:**

High Solids Baking Enamel (S.W. #1 Permaclad 2400, red)

### **PAINT SPRAY METHOD:**

Conventional Air Gun at 40 PSI

### **SPRAY FEED RATE:**

137 gr./min. 130 cc./min.

### **AIR VELOCITY:**

150 FPM

## **Test Results**

### **INITIAL PRESSURE DROP of Clean Test Filter**

0.02 in. water

### **FINAL PRESSURE DROP of Loaded Test Filter**

0.11 in. water

### **WEIGHT GAIN on TEST FILTER & Test Frame Trough**

4038 grams

### **PAINT HOLDING CAPACITY of TEST FILTER**

1173 grams = 2.6 lbs.

### **PAINT RUN-OFF**

2865 grams

### **WEIGHT GAIN on FINAL FILTER**

39.4 grams = PENETRATION

### **AVERAGE REMOVAL EFFICIENCY of TEST FILTER**

99.03 %

**COMPLIANT WITH 40 CFR PART 63 NESHAP**

Test Engineer: Todd Kruger

Supervising Engineer: K. C. Kwok, Ph.D.

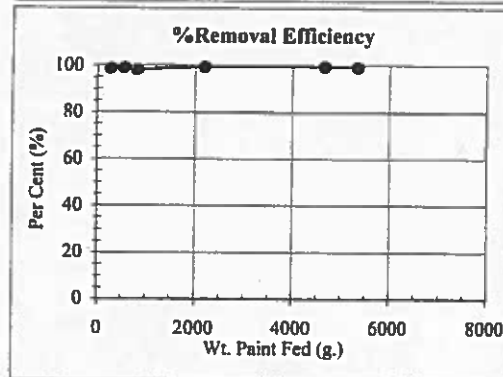
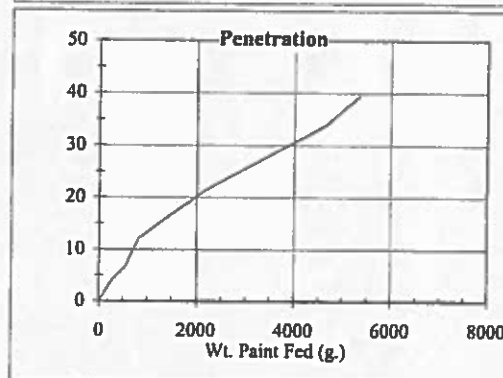
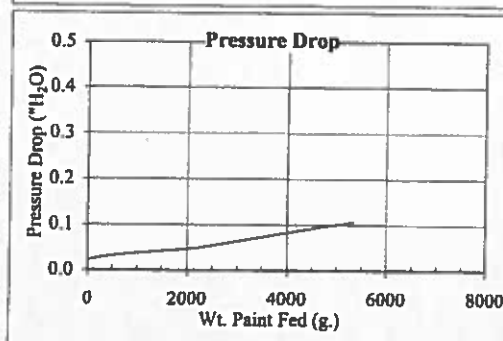
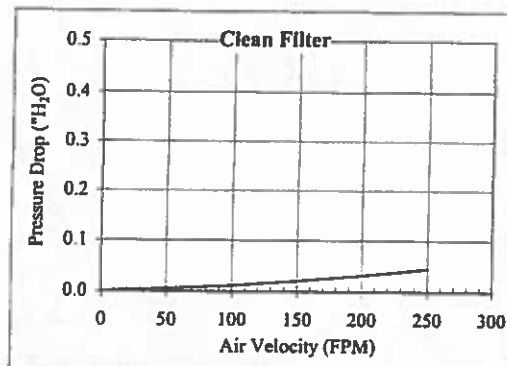



# 3000 SERIES™



## Cabin Design

### ● Cabin Construction

- Insulated dual skin white powder coated galvanized steel interlocking wall panels
- Drive in back out / Drive-thru models available

### ● Lighting

- 27" Drive-Thru models come with (24) 4-tube light fixtures for a total of 96 tubes (23/92 DIBO)
- Light fixtures are equipped with 4 energy efficient T8 5000k color corrected fluorescent tubes
- Horizontal orientation for shadow free illumination
- Interior accessible for easier maintenance
- Dual voltage (120/277) electronic instant start ballasts
- Interlock switch disables painting operation when light access door is open
- ETL and ETL-C listed
- 6-tube, 8-tube and reflector upgrades available

### ● Filtration

- Pre-Filtration: Long lasting washable pre-filters reduce contamination of ceiling filters
- Ceiling Filters: Ideally sized segments allowing for ease of replacement. Filters are held in position by steel knife-edge closures. Achieves 99% capture efficiency 10 micron particulate
- Extract Filtration: Premium fiberglass paint arrestor filters are utilized for maximum particulate removal



### ● Pit Design

- 3-Row Pit is standard - widest pit in the industry
- Heavy Duty Light Weight Galvanized Pressed Steel Grates
  - Lighter than welded grates while providing the same load bearing capabilities
  - Easily serviced by one person
  - Grates run the entire length of the pit
- Galvanized steel plate filter supports
- Pit and Plenum balancing plates for balanced airflow

External Dimensions			Internal Dimensions		
L	W	H	L	W	H
24' 4-3/8"	13' 6-5/8"	10' 10"	23' 11-5/8"	13' 1-1/2"	8' 10-1/2"
27' 2-1/4"	13' 6-5/8"	10' 10"	26' 9-1/4"	13' 1-1/2"	8' 10-1/2"
31' 10-1/4"	13' 6-5/8"	10' 10"	31' 5-5/16"	13' 1-1/2"	8' 10-1/2"

### ● Doors

#### Entrance/Exit

- 10"W trifold doors with durable v-seal rubber gaskets for an airtight seal
- Flush mounted tempered observation windows in all doors (32"x35")
- Heavy duty easily adjustable hinges with grease zerk fittings
- Heavy duty latches and handles for years of reliability
- Locking hardware built inside to minimize dirt collection zones

#### Side Service Door

- Standard on drive-in back out
- Large flush mounted observation window (28"x35")
- Durable v-seal rubber gasket for airtight seal
- Panic latch
- Heavy duty easily adjustable hinges with grease zerk fittings

#### Fire Suppression

- Designed to accept fire suppression equipment (supplied by others)

## Operations & Controls

### ● Mechanical Configuration

- 10 HP dual inlet reverse incline intake fan
- 10 HP dual inlet reverse incline exhaust fan
- 1 or 1.5 MBTU direct fired burner

### ● Touch Screen Controls

- ETL listed Control Panel features PLC which sequences spray and bake mode temperature settings
- Stores up to 8 paint recipes
- User friendly interface featuring touch screen and switches
- Maintenance and self-diagnostic functions
- Data retrieval capabilities with upgraded software
- Upgrade to WiFi connectivity for smartphone, tablet and PC operational capabilities



## Options

- Accele-Cure®
- 15 HP Upgrade
- Blower systems
- Production enhancing accessories
- Air Knife
- Outdoor temper resistant doors
- Upgraded frontals
- Light Protection Film
- Drive-Thru
- 270E mechanical option

1401 W Stanford, Englewood CO 80110 800-442-7628 Fax 303-781-2683 www.garmat.com / sales@garmat.com

**800-4-GARMAT**  
800-442-7628



#### CODE COMPLIANCE\*

Garmat equipment is built to meet or exceed all applicable codes ETL listed

Conforms to NFPA 33 Standards

National Emission Standards for Hazardous Air Pollutants - NESHAP SubPart HHHHHH

OSHA Safety and Health Standards (29CFR 1910.107)

\*Code compliance is dependent upon the manner in which the equipment is installed and used. The equipment installation is dependent on the local jurisdiction authorities. To ensure compliance it is recommended that Garmat equipment be installed by a certified Garmat Distributor.



# FULL DOWNDRAFT SPRAY BOOTH

## 3000 SERIES™

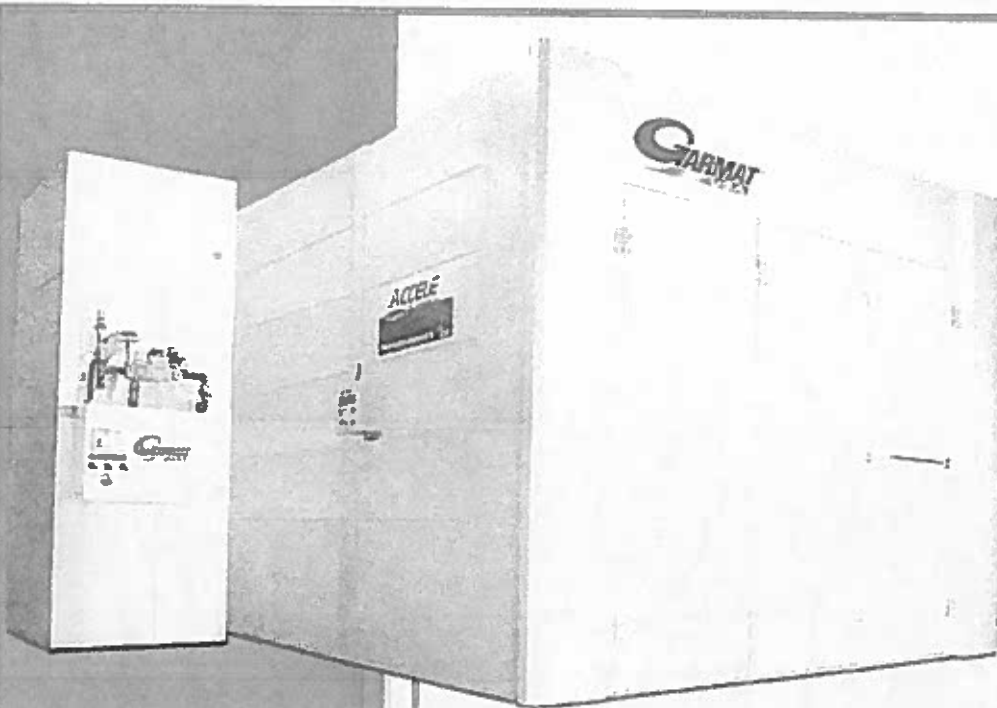

### Superior Airflow

*Dual inlet reverse incline fans for more consistent air flow*

### Premium Lighting

*Horizontal orientation for virtually shadow free illumination*

### Innovative Controls

*PLC based Logic, Garmat USA controls are available in Touchscreen, Touchpad and Standard Design*

### Uncompromised Quality

*Dual Skin Construction  
Heavy Duty Doors  
Long reliable service life*

The 3000 Series™ Spray Booth is Garmat® USA's top of the line downdraft spray booth. It has superior airflow and the most effective lighting in any booth available in the market today. Standard features include:

- Dual Inlet Reverse Incline Fans with Airfoil Blades on both supply and exhaust
- Superior lighting, horizontally placed for virtually shadow free illumination
- 3-Row pit equipped with light weight, heavy duty grates
- Garmat's Touchscreen controls with a user friendly interface

Garmat Downdraft Paint Booths feature dual inlet reverse incline fans providing the most consistent airflow of any downdraft booth on the market.

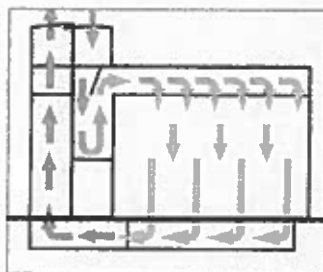
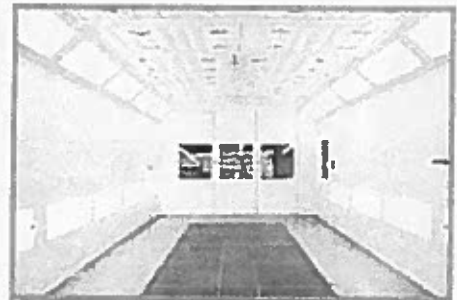

*Downdraft Airflow*



*Dual Inlet Reverse Incline Fans with Air Foil Blades for more consistent airflow*





# SIC Code 7532 Top, Body, and Upholstery Repair Shops and Paint Shops

Classification/ [Services](#) / [Automotive Repair...](#) / [Automotive Repair...](#) / Top, Body, and Upholstery R...

## Industry

Services

## Description

Establishments primarily engaged in the repair of automotive tops, bodies, and interiors, or automotive painting and refinishing. Also included in this industry are establishments primarily engaged in customizing automobiles, trucks, and vans except on a factory basis.

## Cross References

Establishments primarily engaged in customizing automobiles, trucks, and vans on a factory basis are classified in manufacturing, industry group 371.

## Illustrative Examples

Antique and classic automobile restoration, automotive body shops, automotive interior shops, automotive paint shops automotive tops (canvas or plastic), installation, repair, or sales and automotive trim shops, bump shops (automotive repair), collision shops, automotive customizing automobiles, trucks or vans: except on a factory basis upholstery repair, automotive van conversions, except on a factory basis.

## Sample Business Listings

- [Spartan Motors Chassis](#)
- [PPG Industries](#)
- [Service King Collision Repair Center](#)
- [Manheim Ohio](#)
- [PPG Industries](#)
- [Terex Utilities](#)
- [Toyota Logistics Services](#)
- [House Of Imports Collision Center](#)
- [Manheim Fort Wayne](#)
- [Nelson Global Products](#)
- [PPG Industries](#)
- [Toyota Logistics Service](#)
- [Point Blank Body Armor](#)
- [Victoria British Limited Auto Parts](#)
- [Kuni Chevrolet Cadillac](#)
- [Houston Freightliner](#)
- [All Star Ford Dodge](#)
- [Terex Utilities](#)
- [Manheim Louisville](#)

- Dattco Body Shop
- Abra Auto Body And Glass
- North Point Collision Center
- Nelson Global Products
- Terry Labonte Chevrolet Collision Center
- PPG Industries

## Further Classification

### 6-digit SIC

- 753201Automobile Body-repairing & Painting
- 753202Automobile Paint
- 753203Automobile Customizing
- 753204Automobile Restoration-antique & Classic
- 753205Automobile-reconditioning
- 753206Truck-painting & Lettering
- 753207Automobile Seatcovers Tops & Upholstery
- 753208Van & Truck Conversions & Accessories
- 753209Wheel Chair Van Lifts
- 753210Motorcycles & Motor Scooters-painting
- 753211Motorcycles-customizing
- 753212Truck Bodies-repairing
- 753213Automobile Pin Striping
- 753214Automobile-wood Refinishing
- 753215Limousine-conversions
- 753216Boat & Yacht Customizing
- 753217Boat Restoration
- 753218Canvas Goods-repairing
- 753220Automobile-new Car Pre-delivery Service
- 753221Truck Chassis Alterations & Equipment
- 753223Bus Conversion
- 753225Automobile Paint Repairing
- 753226Horse Carriages-build Repair Restore

### 7-digit SIC

- 7532001Automobile Body-repairing & Painting
- 7532002Automobile Body Shops
- 7532003Automobile Painting
- 7532004Automobile Collision Repair
- 7532005Automobile Seat Covers Tops & Upholstery
- 7532006Automobile Restoration-antique & Classic
- 7532007Automobile Customizing
- 7532008Exterior Repair Services
- 7532009Truck-painting & Lettering
- 7532010Truck Body Shops
- 7532011Lettering & Painting Services
- 7532012Interior Repair Services
- 7532013Automobile Top Installation & Repair
- 7532014Automobile Bump Repair
- 7532015Van & Truck Conversions & Accessories
- 7532016Mobile Home & Trailer Repair

- 7532017Automobile Lettering
- 7532018Automobile-reconditioning
- 7532019Wheel Chair Van Lifts
- 7532020Motorcycles & Motor Scooters-painting
- 7532021Motorcycles-customizing
- 7532022Truck Bodies-repairing
- 7532023Automobile Pin Striping
- 7532024Automobile-wood Refinishing
- 7532025Limousine-conversions
- 7532026Boat & Yacht Customizing
- 7532027Boat Restoration
- 7532028Canvas Goods-repairing
- 7532029Automobile-new Car Pre-delivery Services
- 7532030Truck Chassis Alterations & Equipment
- 7532031Bus Conversion
- 7532032Automobile Paint Repairing
- 7532033Horse Carriages-build Repair Restore

**8-digit SIC**

- 75320000Top And Body Repair And Paint Shops
- 75320100Interior Repair Services
- 75320101Upholstery And Trim Shop, Automotive
- 75320200Lettering And Painting Services
- 75320201Lettering, Automotive
- 75320202Paint Shop, Automotive
- 75320203Truck Painting And Lettering
- 75320300Customizing Services, Nonfactory Basis
- 75320301Van Conversion
- 75320400Exterior Repair Services
- 75320401Body Shop, Automotive
- 75320402Body Shop, Trucks
- 75320403Bump Shops, Automotive Repair
- 75320404Collision Shops, Automotive
- 75320405Tops (canvas Or Plastic), Installation Or Repair: Automotive
- 75329901Antique And Classic Automobile Restoration
- 75329902Mobile Home And Trailer Repair

**Free Business Search - SIC 7532****Buy Industry List for SIC 7532**

Order Full Details From 15 Million Companies

**Business Listings**

Total Companies: **13025**

Est. Employment: **168358**



# Currituck County GIS Online Mapping

*Only Other Body Shop in Currituck  
Atlantic Collision & Fiberglass*

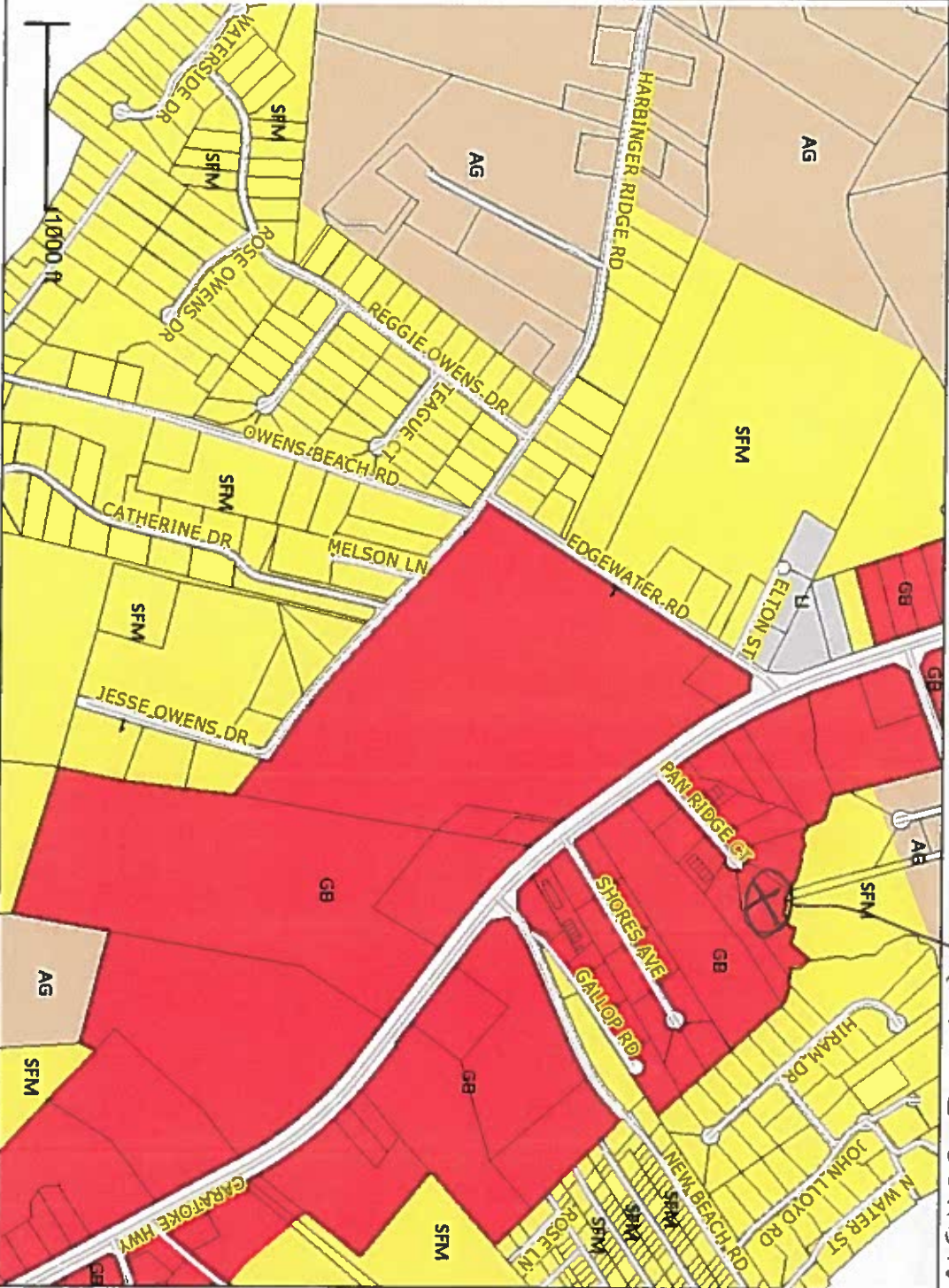

Currituck County GIS  
(252)232-2034  
www.co.currituck.nc.us/Geographic-Information-Services.cfm

This map should be used for general reference purposes only. Currituck County assumes no legal liability for the information shown on this map.

- Communities**
  - Arden
  - Banco
  - Corlock
  - Corolla
  - Currituck
  - Olds Woods
  - Grandy
  - Harbinger
  - Jarvisburg
  - Kenneth Island
  - Maple
  - Mayock
  - Paint Harbor
  - Poplar Branch
  - Rowette Point
  - Shawboro
  - Sligo
  - Waterbury
- County Boundary**
  - State
  - County
  - Streets
- Wright Memorial Bridge**
  - Major Streets
  - Arterial, Principal
  - Collector, Major
  - Ferry Route
- Parcel Land Hooks**
  - Parcels
- Official Zoning (AP Over)**
  - Official Zoning (RET Over)
  - Official Zoning (CDPUD Over)
  - Official Zoning (PUD Over)
  - Official Zoning (Base Dist)
- Official Zoning (Base Dist)**
  - AG
  - SFM
  - SFO
  - SFI
  - SFR
  - MXR
  - GB
  - LB
  - LI
  - HI
  - PD-M
  - C-HI
  - C-MXR
  - C-SFM
  - C-GB
- Currituck County



The City of Elizabeth City

Harbor of Hospitality

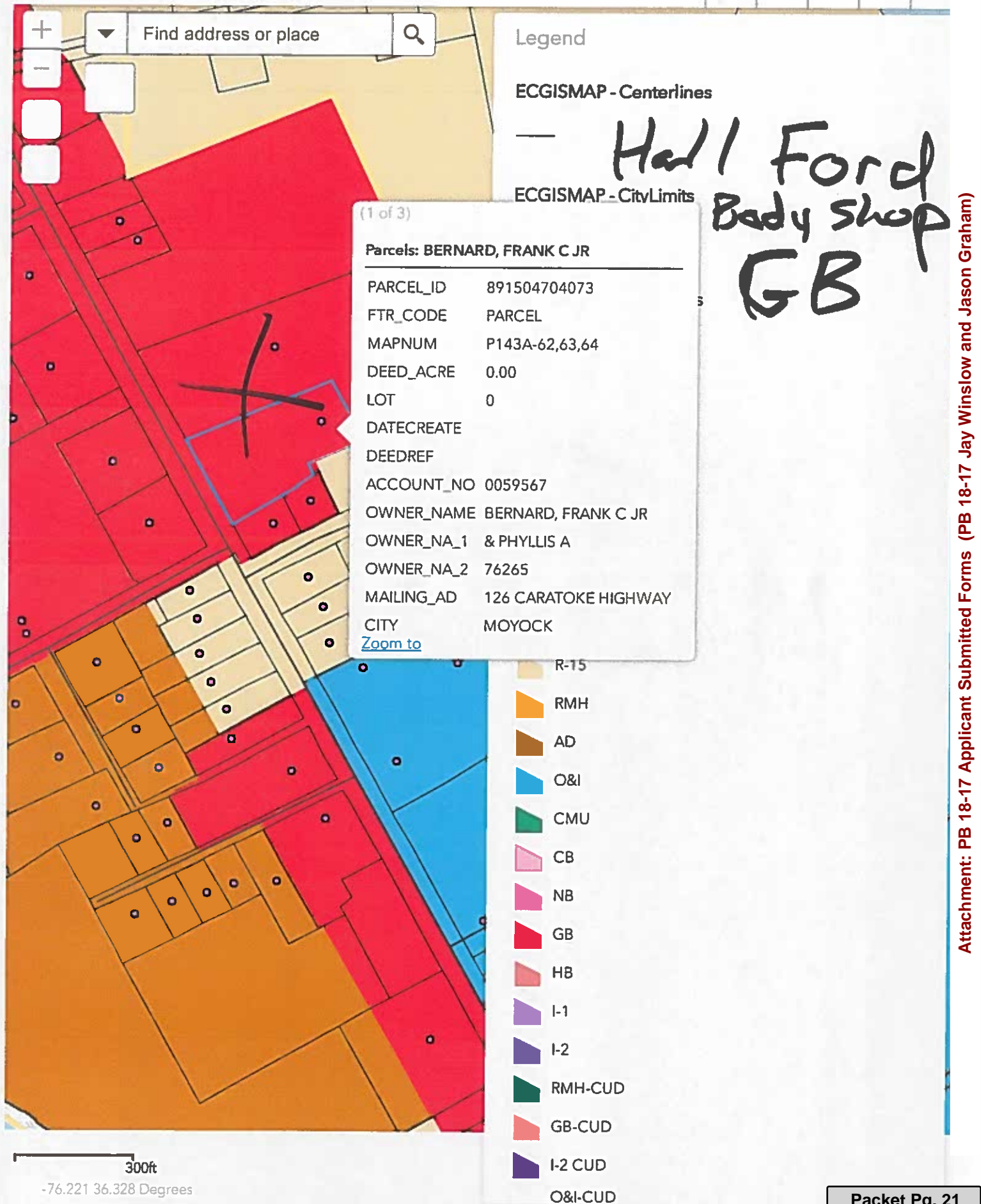





This map is prepared from data used for the inventory of the real property for tax purposes. Primary information sources such as recorded deeds, plats, wills, and other primary public records should be consulted for verification of the information contained in this map.

DARE COUNTY ASSUMES NO LEGAL RESPONSIBILITY FOR THE INFORMATION CONTAINED IN THIS MAP.

Print Date: June 5, 2018



710 N Hwy 64/264  
Manteo, NC 27954

Parcel: 023110000

Pin: 988014337386

Tax District: Roanoke In

Subdivision: Roanoke Park

Lot-Blk-Sect: Lot: 4 & 15 Blk: Q Sec:

Property Use: Service

Building Type: Service Shop Or Facility

Year Built: 1986

#### Tax Ownership

Ron & Phil's Body Shop  
Inc

#### Current Tax Value

Land	124,000
Building	124,200
Misc	17,400
Total	265,600

#### Map Legend

Scale: 1:2,133

Basemap: Aerials(2012)

Parcel Lines

Property Line

☐ Selected Parcel

Leaflet



## Roanoke Island, N.C.

## Official Zoning Map

1 in = 575 ft

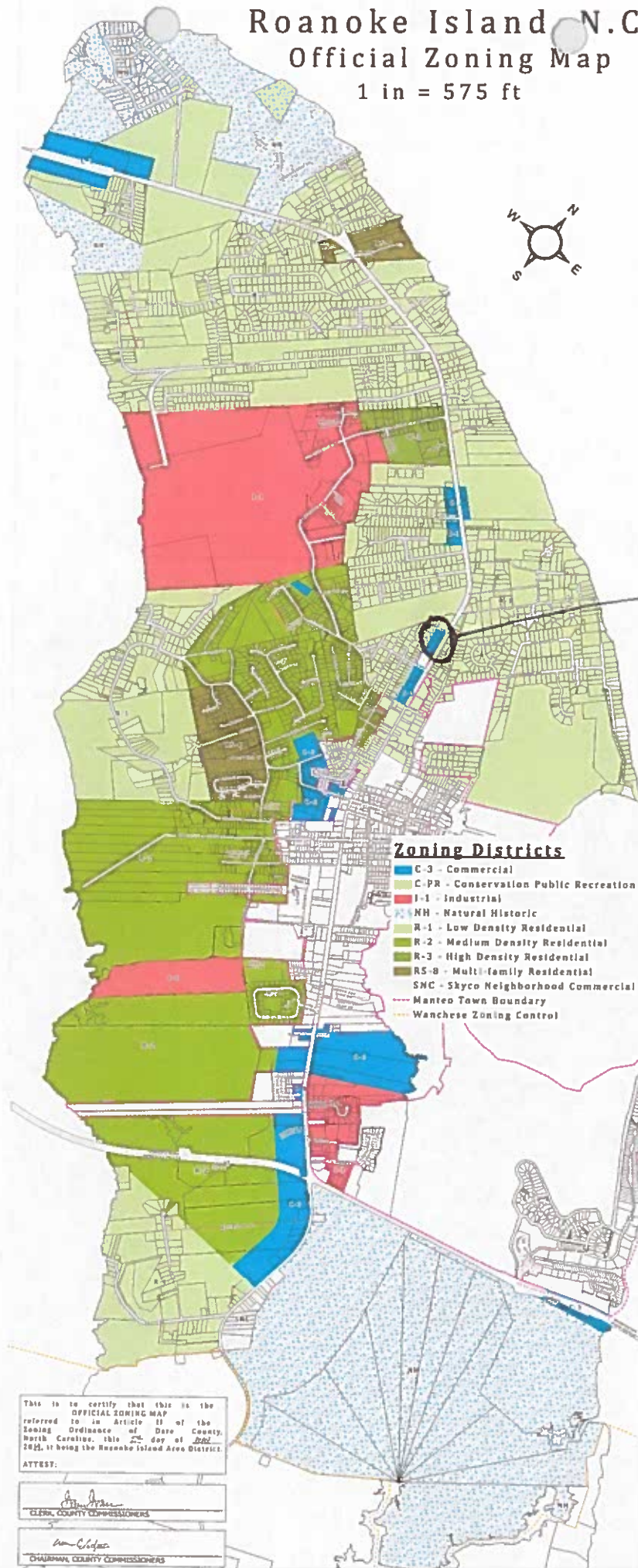

Ron + Phil's  
Body Shop  
Gen. Commerce

This is to certify that this is the  
OFFICIAL ZONING MAP  
referred to in Article II of the  
Zoning Ordinance of Dare County,  
North Carolina, this 25<sup>th</sup> day of 2022,  
2022, it being the Roanoke Island Area District.

ATTEST:

*[Signature]*  
CLERK, COUNTY COMMISSIONERS

*[Signature]*  
CHAIRMAN, COUNTY COMMISSIONERS



The City of Elizabeth City

Harbor of Hospitality

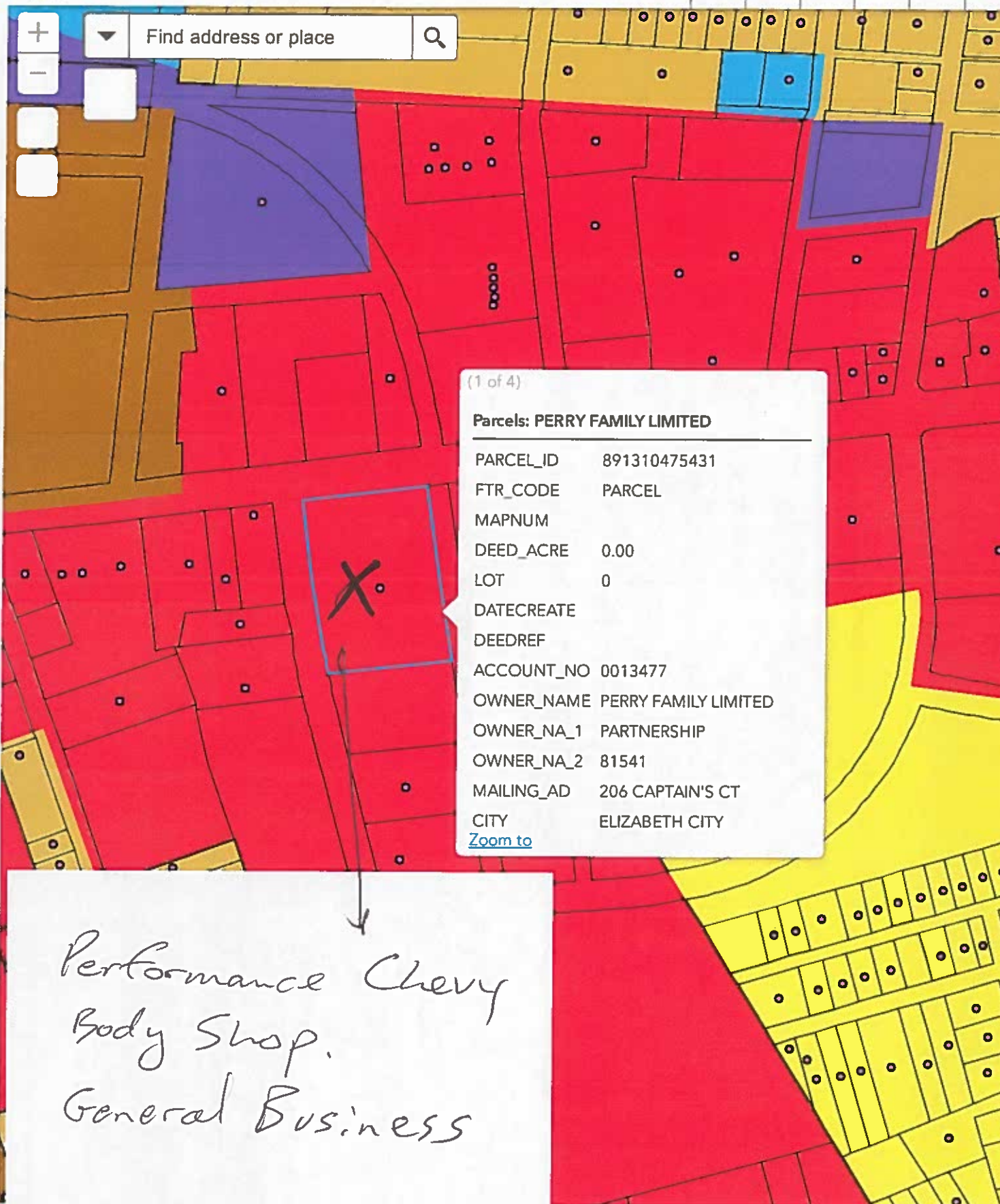

Attachment: PB 18-17 Applicant Submitted Forms (PB 18-17 Jay Winslow and Jason Graham)



▼

Find address or place

Q

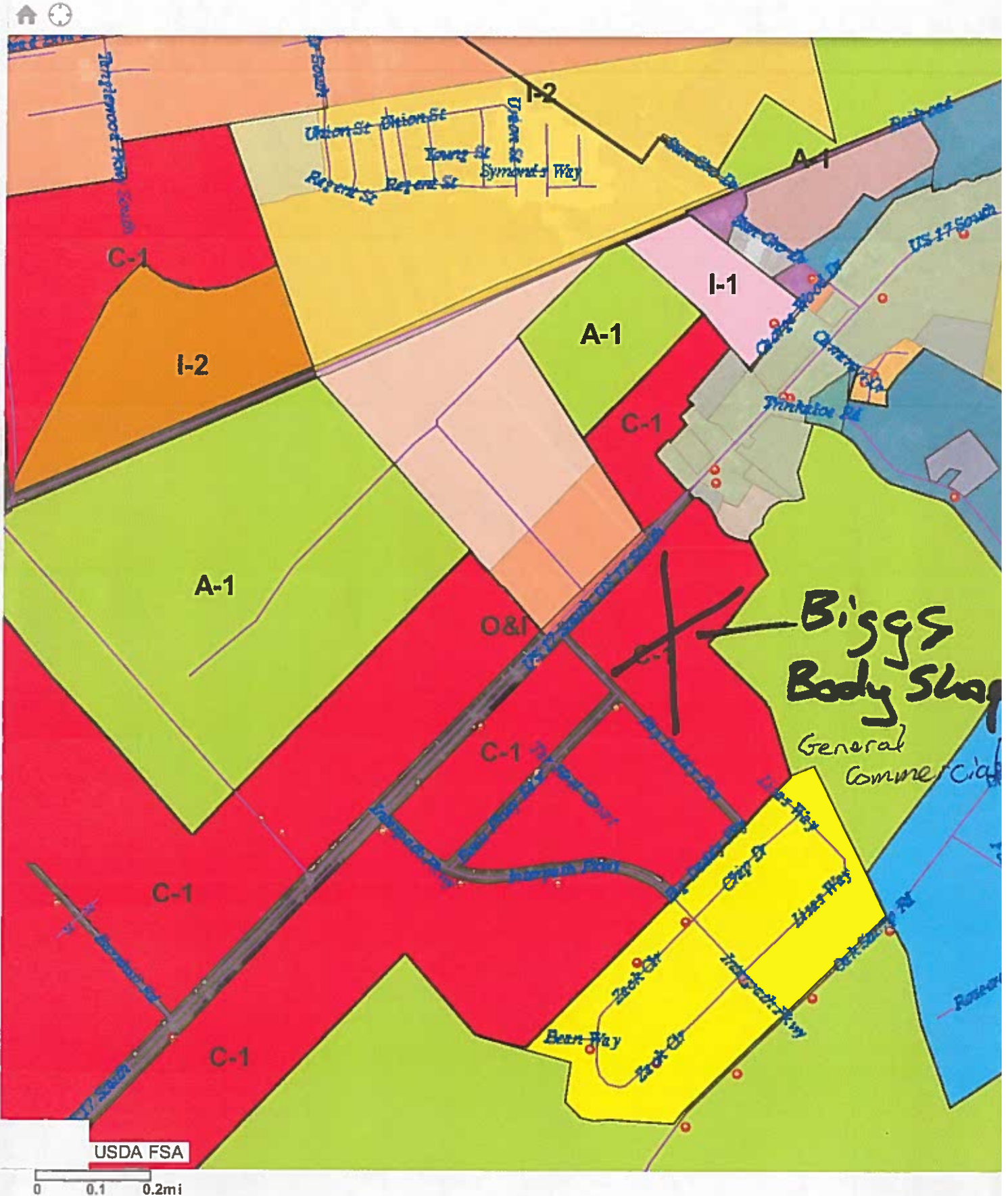

Attachment: PB 18-17 Applicant Submitted Forms (PB 18-17 Jay Winslow and Jason Graham)



▼

Find address or place

🔍



0 150 300ft

Attachment: PB 18-17 Applicant Submitted Forms (PB 18-17 Jay Winslow and Jason Graham)



- BASE MAPS  
0
- MAP LAYERS  
0
- MAP TOOLS  
0
- SEARCH  
0
- PRINT  
0
- SHARE  
0
- HELP

T/ROKMAPS\_HB P/ROKMAPS\_I  
(<https://www.roktech.net>)

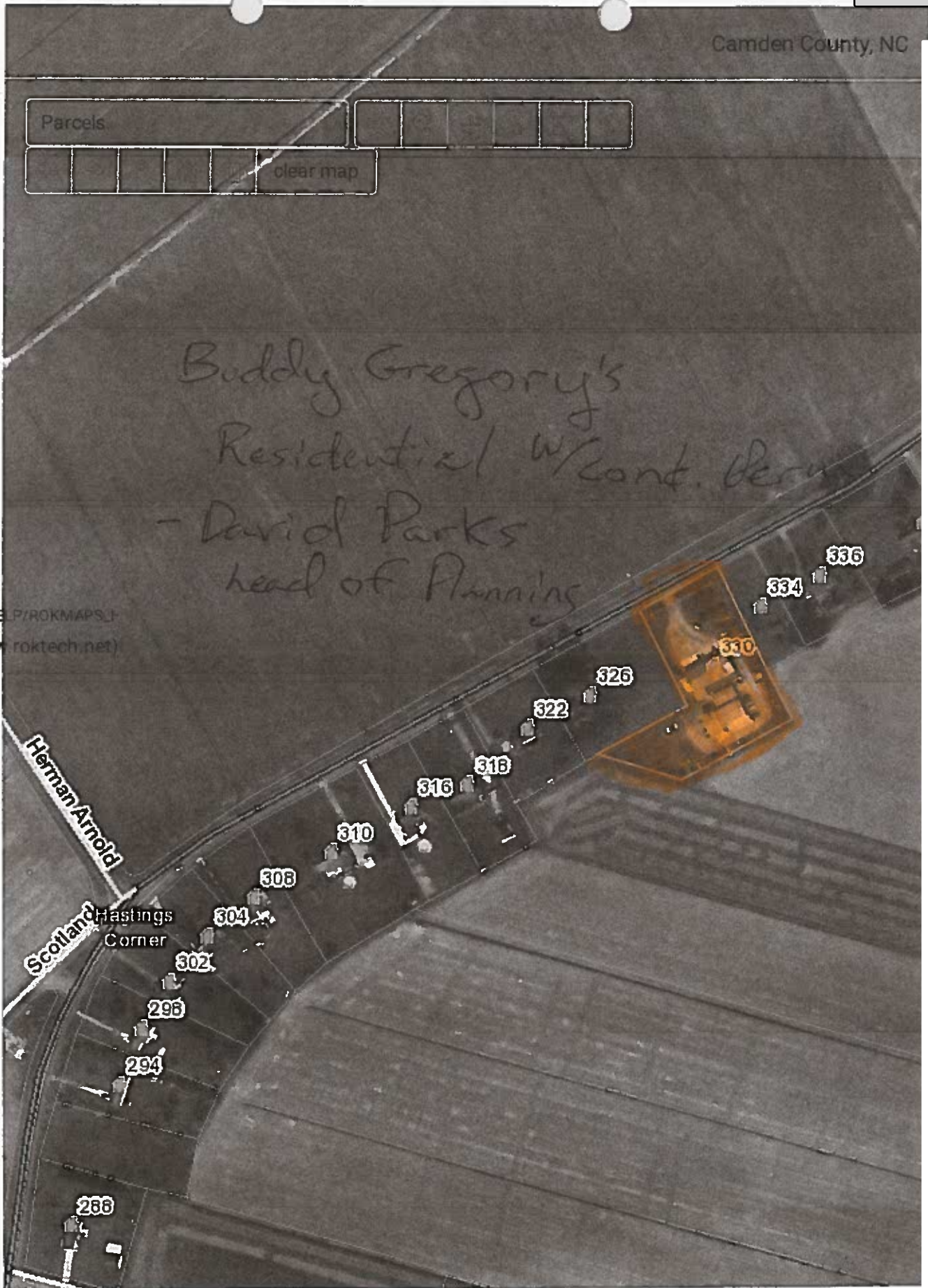

Attachment: PB 18-17 Applicant Submitted Forms (PB 18-17 Jay Winslow and Jason Graham)