



**Planning Board
Agenda Packet**

July 10, 2018

Work Session

3:30 PM

Call to Order

- A) Pledge of Allegiance & Moment of Silence
- B) Ask for Disqualifications
- C) Announce Quorum Being Met
- D) Approval of Agenda

Approval of Minutes for June 12, 2018**Old Business****New Business**

- A) **PB 18-17 Jay Winslow and Jason Graham:** Text amendment to Chapter 4 Use Standards of the UDO to allow automotive painting/body shops in the GB (General Business) Zoning District.

Announcements**Adjournment**



CURRITUCK COUNTY NORTH CAROLINA

June 12, 2018

Minutes – Regular Meeting of the Planning Board

WORK SESSION

A work session was held in the conference room with staff and board members. Senior Planner Tammy Glave reviewed the text amendment request to modify off-premise directional sign regulations and gave examples of the increase in numbers of signs with the approval of this request. The work session adjourned at 6:55 PM.

CALL TO ORDER

The Currituck County Planning Board met at 7:00 PM in the Board Meeting Room of the Historic Courthouse, 153 Courthouse Road, Currituck, North Carolina.

Attendee Name	Title	Status	Arrived
Fred Whiteman	Chairman	Present	
C. Shay Ballance	Vice Chairman	Present	
Carol Bell	Board Member	Present	
Steven Craddock	Board Member	Absent	
John McColley	Board Member	Present	
Jeff O'Brien	Board Member	Absent	
Jane Overstreet	Board Member	Absent	
J. Timothy Thomas	Board Member	Present	
Tammy Glave	Planning and Community Development Senior Planner	Present	
Cheri Elliott	Clerk to the Board	Present	

Chairman Whiteman called the meeting to order.

A. Pledge of Allegiance & Moment of Silence

Chairman Whiteman asked everyone to stand for the Pledge of Allegiance and a moment of silence.

B. Ask for Disqualifications

Chairman Whiteman asked if any board member had a conflict of interest with the matter coming before the board. Chairman Whiteman disclosed he lives in the Eagle Creek neighborhood, but did not have a conflict with the case to be heard.

C. Announce Quorum Being Met

Chairman Whiteman announced a quorum being met with five board members present.

Communication: PB Minutes June 12, 2018 (Approval of Minutes for June 12, 2018)

D. Approval of Agenda

Chairman Whiteman asked if there were any changes to the agenda for tonight's meeting. With no changes noted, Ms. Bell motioned to approve the agenda as presented. Vice Chairman Ballance seconded the motion and the motion carried unanimously.

RESULT:	APPROVED [UNANIMOUS]
AYES:	Fred Whiteman, Chairman, C. Shay Ballance, Vice Chairman, Carol Bell, Board Member, John McColley, Board Member, J. Timothy Thomas, Board Member
ABSENT:	Steven Craddock, Board Member, Jeff O'Brien, Board Member, Jane Overstreet, Board Member

APPROVAL OF MINUTES FOR MAY 10, 2018

Chairman Whiteman asked if any changes were needed for the meeting minutes of May 10, 2018. With no changes noted, Ms. Bell motioned to approve the minutes as presented. Mr. Thomas seconded the motion and the motion carried unanimously.

RESULT:	APPROVED [UNANIMOUS]
AYES:	Fred Whiteman, Chairman, C. Shay Ballance, Vice Chairman, Carol Bell, Board Member, John McColley, Board Member, J. Timothy Thomas, Board Member
ABSENT:	Steven Craddock, Board Member, Jeff O'Brien, Board Member, Jane Overstreet, Board Member

E. PB Minutes May 10, 2018

OLD BUSINESS

There was no old business discussed.

NEW BUSINESS

A. PB 18-15 Eagle Creek Golf Course and Grill:

Senior Planner Tammy Glave presented the staff report. The text amendment submitted by Tim Paasch, owner of Eagle Creek Golf Club & Grill, is intended to amend the Unified Development Ordinance (UDO), Chapter 5. Development Standards to allow off-premise directional signs for businesses located within two miles of a major arterial street, in addition to the off-premise directional signs currently allowed two miles from the Currituck Sound and the Atlantic Intracoastal Waterway. Ms. Glave gave examples of how many additional signs this would create if the text amendment was approved and said that staff recommends denial of the proposed text amendment due to its inconsistency with the Land Use Plan, inconsistency with Section 5.12 of the UDO and not reasonable and in the public interest since it commercializes the landscape along the highway.

Chairman Whiteman asked for questions for staff from board members. Mr. McColley asked what businesses were currently using off-premise directional signs. Ms. Glave said two businesses, one being Coinjock Marina and the other no longer operating.

Further discussion was also held on the number of additional signs it would create, where they would be located and the size of the signs.

Chairman Whiteman asked the applicant to appear before the board. Tim Paasch presented his case for the text amendment. He said there was a previous sign when Mill Run was operating and he wanted to put the sign back up with their business name. He cited the Tourist Oriented Directional Sign (TODS) Program sponsored by the North Carolina Department of Transportation (NCDOT) which allows businesses or facilities to be signed on NCDOT highway right of way. These signs are intended to help tourists find businesses and thereby promote tourism in North Carolina.

Discussion was held on the number of businesses located off the highway and Ms. Glave said 150 businesses are within 2 miles of the highway right of way. Chairman Whiteman said if the TODS Program was used it would not cluster the highway.

Chairman Whiteman asked Mr. Paasch if he was willing to add verbiage to the text amendment including the NC definition of a tourist based business and Mr. Paasch agreed.

Mr. Paasch also stated when using the TODS Program, the word "bar" cannot be on the sign. He would just put "golf course".

Mr. Thomas and Vice Chairman Ballance both agreed they would approve the text amendment with the added wording of tourist based according to the TODS Program.

Discussion was held on reducing the size of the signs from 64 square feet and 15 feet high to 32 square feet and 15 feet high. Signs would also be limited to the business name and directional arrow.

With no further discussion, Chairman Whiteman asked for a motion. Mr. Thomas motioned to approve PB 18-15 Eagle Creek Golf Course and Grill Text Amendment to allow off-premise directional signs for businesses located within two miles of a major arterial street provided these businesses are tourist based, the sign will be 32 square feet and 15 feet high, with business name and directional arrow only. Mr. Ballance seconded the motion and the motion was approved 4-1 with Mr. McColley opposed.

RESULT:	RECOMMENDED APPROVAL [4 TO 1]	Next: 7/16/2018 6:00 PM
AYES:	Fred Whiteman, Chairman, C. Shay Ballance, Vice Chairman, Carol Bell, Board Member, J. Timothy Thomas, Board Member	
NAYS:	John McColley, Board Member	
ABSENT:	Steven Craddock, Board Member, Jeff O'Brien, Board Member, Jane Overstreet, Board Member	

ANNOUNCEMENTS

There were no announcements.

ADJOURNMENT

The meeting adjourned at 7:40 PM.



Currituck County Agenda Item Summary Sheet

Agenda ID Number – (ID # 2211)

Agenda Item Title

PB 18-17 Jay Winslow and Jason Graham:

Brief Description of Agenda Item:

Text amendment to Chapter 4 Use Standards of the UDO to allow automotive painting/body shops in the GB (General Business) Zoning District.

Board Action Requested

Action

Person Submitting Agenda Item

Tammy Glave,

Presenter of Agenda Item

Tammy Glave



Currituck County

Planning and Community Development Department
 Planning and Zoning Division
 153 Courthouse Road, Suite 110
 Currituck, North Carolina 27929
 252-232-3055 FAX 252-232-3026

To: Planning Board
 Board of Commissioners

From: Planning Staff

Date: July 3, 2018

Subject: PB 18-17 Jay Winslow and Jason Graham Text Amendment

In the current UDO "Automotive Painting/Body Shop" is only allowed in the LI (Light Industrial) and HI (Heavy Industrial) zoning districts. The applicants are requesting that painting/body shops be allowed in the GB (General Business) zoning district. Currently automobile repair and servicing is allowed as a permitted use in GB. In the past, the noxious fumes and pollutants emitted from paint booths were an environmental concern and one reason automotive painting/body shops were placed in our industrial zoning districts. The EPA (Environmental Protection Agency) now strictly governs paint and auto body shops to reduce emissions (cadmium, chromium, lead, manganese, and nickel) emitted during the spray application surface coating operation. The EPA requires that all spray booths, stations, and enclosures catch at least 98% of the fumes.

In addition to monitoring the emissions through yearly EPA inspections, the UDO requirements for automobile repair and servicing would apply to automotive painting/body shop to protect neighboring properties:

- (a) The repair facility shall be located at least 125 feet from any residential district, school (except vocational school), or child care center.
- (b) Repair of all vehicles shall occur within an enclosed building. Temporary outdoor vehicle storage may be allowed in an outdoor storage area that is no larger than 25 percent of the buildable area of the lot, located behind or to the side of the principal structure, and screened in accordance with Section 4.3.3.R, Outdoor Storage.
- (c) If gasoline is sold on-site, the use shall also comply with the standards for a gasoline sales use in Section 4.3.3.K Gasoline Sales
- (d) Vehicles shall not be parked or stored as a source of parts or the purpose of sale or lease/rent.
- (e) Vehicles that are repaired and are awaiting removal shall not be stored or parked for more than 30 consecutive days. In cases where a vehicle is abandoned by its lawful owner before or during the repair process, the vehicle may remain on site as long as is necessary after the 30 day period, provided the owner or operator of the establishment demonstrates steps have been taken to remove the vehicle from the premises using the appropriate legal means.

Staff Recommendation:

Staff recommends approval of the proposed text amendment due to its consistency with the Land Use Plan and the UDO. The text amendment is reasonable and in the public interest because it promotes economic growth and small business startups while protecting the environment from a previously less regulated, noxious, more intense use. Staff recommends that a copy of the EPA yearly monitoring report be provided to the county.

Attachment: 18-17 J and J auto body shop BOC Memo (PB 18-17 Jay Winslow and Jason Graham)

PB 18-17
Jay Winslow and Jason Graham

Amendment to the Unified Development Ordinance Chapter 4: Use Standards, to an automotive paint/body shop in the GB zoning district.

BE IT ORDAINED by the Board of Commissioners of the County of Currituck, North Carolina that the Unified Development Ordinance of the County of Currituck be amended as follows:

Item 1: That Chapter 4 is amended by adding the following bold underlined language and deleting the strikethrough language in Section 4.1.2 Use Table:

TABLE 4.1.1: SUMMARY USE TABLE

Z = Zoning Compliance Permit; U = Use Permit; MP = Allowed with Master Plan;
 CZ= Allowed in a Conditional Zoning District blank cell = Prohibited

USE CATEGORY	USE TYPE	ZONING DISTRICT (CURRENT DISTRICT IN PARENTHESIS) [NOTE: OVERLAY OR SUB-DISTRICT REQUIREMENTS MAY FURTHER LIMIT USES]															ADDITIONAL REQ. (4.2.)		
		RC	AG	SFM	SFO	SFR	SFI	MXR	GB	LB	CC	VC	LI	HI	PD-R	PD-M		PD-O	
COMMERCIAL USE CLASSIFICATION																			
Vehicle Sales and Services, Light	Automotive parts and installation									Z		Z	Z	Z			M P	M P	4.1.1
	Automobile repair and servicing (without including painting/bodywork)									Z		Z	Z	Z			M P	M P	4.1.2
	Automobile sales or rentals									U		Z	Z	Z			M P	M P	4.1.3
	Car wash or auto detailing									Z		Z	Z	Z		M P	M P	M P	4.1.4
	Taxicab service									Z	Z	Z	Z			M P	M P	M P	4.1.5
Vehicle Sales and Services, Heavy	Aircraft parts, sales, and maintenance													Z	Z				
	Automotive painting/body shop													Z	Z				4.H.1
	Automotive wrecker service													Z	Z			M P	4.H.2
	Boat and marine rental, sales, and service									Z				Z	Z				4.H.3

Item 2: That Chapter 4 is amended by addeleting the strikethrough language in Section 4.1.2.4 Commercial Uses:

A. Vehicle Sales and Services, Heavy (sections to be renumbered accordingly)

~~B. Automotive Painting/Body Shop~~

~~Automobile painting/body shop uses shall comply with the following standards:~~

- ~~a. The use shall be located at least 250 feet from any residential district, school (except vocational schools), or child care center.~~
- ~~b. Vehicles shall not be parked or stored as a source of parts or for the purpose of sale or lease/rent.~~

- ~~c. Repair and storage of all vehicles shall occur within an enclosed building. Temporary outdoor vehicle storage may be allowed in an outdoor storage area that is no larger than 25 percent of the buildable area of the lot, located behind or to the side of the principal structure, and screened in accordance with Section 4.3.3.R, Outdoor Storage.~~
- ~~d. Vehicles that are repaired and are awaiting removal shall not be stored or parked for more than 30 consecutive days. In cases where a vehicle is abandoned by its lawful owner before or during the repair process, the vehicle may remain on site as long as is necessary after the 30 day period, provided the owner or operator of the establishment demonstrates steps have been taken to remove the vehicle from the premises using the appropriate legal means.~~

Item 3: That Chapter 4 is amended by adding the following bold underlined language and deleting the strikethrough language in Section 4.2.4 Commercial Uses:

I. Vehicle Sales and Services, Light

2) Automotive Repair and Service (~~Without~~ including Painting/Bodywork)

- (f) Painting/bodywork operations must provide the department with the yearly Environmental Protection Agency Compliance Report.**

Item 4: Statement of Consistency and Reasonableness:

The requested zoning text amendment is consistent with the 2006 Land Use Plan because:

- New and expanding industries and businesses are encouraged, especially those that diversify the local economy, train and use a more highly skilled labor force, and are compatible the environment. POLICY ED1
- Small business start-ups are encouraged. POLICY ED4
- Site and building design along major highway corridors require improved appearance and development standards (driveway access, landscaping, buffering, signage, lighting, and tree preservation). POLICY CA1:
- Adequate public facilities must be available to support the request. POLICY PP2:

The request is reasonable and in the public interest because:

- It is consistent with the purpose and intent of Section 1.3 of the UDO.
- It encourages business growth while protecting the aesthetic and environmental aspects of the county.

Item 5: The provisions of this Ordinance are severable and if any of its provisions or any sentence, clause, or paragraph or the application thereof to any person or circumstance shall be held unconstitutional or violative of the Laws of the State of North Carolina by any court of competent jurisdiction, the decision of such court shall not affect or impair any of the remaining provisions which can be given effect without the invalid provision or application.

Item 6: This ordinance amendment shall be in effect from and after the ____ day of _____, 2018.

Board of Commissioners' Chairman
Attest:

Leeann Walton
Clerk to the Board

DATE ADOPTED: _____
MOTION TO ADOPT BY COMMISSIONER: _____
SECONDED BY COMMISSIONER: _____
VOTE: ____AYES ____NAYS
.....

PLANNING BOARD DATE: July 10, 2018
PLANNING BOARD RECOMMENDATION: _____
VOTE: ____AYES ____NAYS
ADVERTISEMENT DATE OF PUBLIC HEARING: _____
BOARD OF COMMISSIONERS PUBLIC HEARING: _____
BOARD OF COMMISSIONERS ACTION: _____
POSTED IN UNIFIED DEVELOPMENT ORDINANCE: _____
AMENDMENT NUMBER: _____

Attachment: 18-17 J and J Autobody Shop TA PB (PB 18-17 Jay Winslow and Jason Graham)



Text Amendment Application

OFFICIAL USE ONLY:

Case Number: _____
 Date Filed: _____
 Gate Keeper: _____
 Amount Paid: _____

Contact Information
APPLICANT:

Name: Jay Winslow / Jason Graham
 Address: 1140 Deerfield Drive
South Mills NC 27976
 Telephone: 252-562-2916 (Jay) 252-619-2313 (Jason)
 E-Mail Address: g2autobodyandpaint@gmail.com

Request

I, the undersigned, do hereby make application to change the Currituck County UDO as herein requested.

Amend Chapter(s) 4.2 Section(s) H & I-2 as follows:

We are requesting to change Auto Paint/Body (4.2-H)
which requires LI or HI zoning, and move
that under Light Auto Services allowing
paint/body repair in GB zone. (4.2-I2)

*Request may be attached on separate paper if needed.

[Signature]
 Petitioner

6/6/18
 Date

Text Amendment Submittal Checklist

Staff will use the following checklist to determine the completeness of your application. Only complete applications will be accepted.

Text Amendment Submittal Checklist

Date Received: _____

Project Name: Graham's Collision Center

Applicant/Property Owner: Jason Graham / Jay Winslow

Text Amendment Submittal Checklist

1	Complete Text Amendment application	
2	Application fee (\$150)	
3	2 hard copies of ALL documents	
4	1 PDF digital copy of all documents (ex. Compact Disk – e-mail not acceptable)	

For Staff Only**Pre-application Conference**

Pre-application Conference was held on _____ and the following people were present:

Comments

PAINT ARRESTANCE FILTER TEST REPORT **Spray Removal Efficiency & Paint Holding Capacity**

Tested for: Air Flow Technology Inc.
 Filter Mfr.: Air Flow Technology Inc.
 Filter Name: 22 Grams Paint Arrestor
 Report#/Test#: R 661 T 761
 Report Date: March 16, 2005

Test Information

FILTER DESCRIPTION:

White/Yellow highloft fiberglass

PAINT DESCRIPTION:

High Solids Baking Enamel (S.W. #1 Permaclad 2400, red)

PAINT SPRAY METHOD:

Conventional Air Gun at 40 PSI

SPRAY FEED RATE:

137 gr./min. 130 cc./min.

AIR VELOCITY:

150 FPM

Test Results

INITIAL PRESSURE DROP of Clean Test Filter

0.02 in. water

FINAL PRESSURE DROP of Loaded Test Filter

0.11 in. water

WEIGHT GAIN on TEST FILTER & Test Frame Trough

4038 grams

PAINT HOLDING CAPACITY of TEST FILTER

1173 grams = 2.6 lbs.

PAINT RUN-OFF

2865 grams

WEIGHT GAIN on FINAL FILTER

39.4 grams = PENETRATION

AVERAGE REMOVAL EFFICIENCY of TEST FILTER

99.03 %

COMPLIANT WITH 40 CFR PART 63 NESHAP

Test Engineer: Todd Kruger

Supervising Engineer: K. C. Kwok, Ph.D.

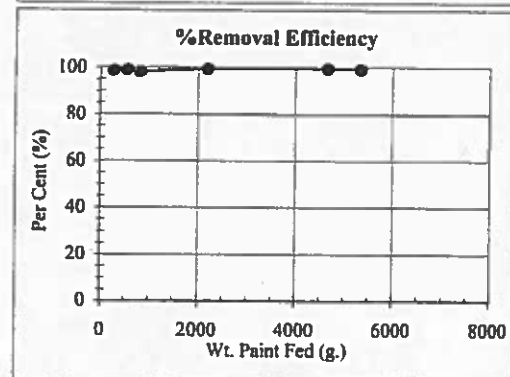
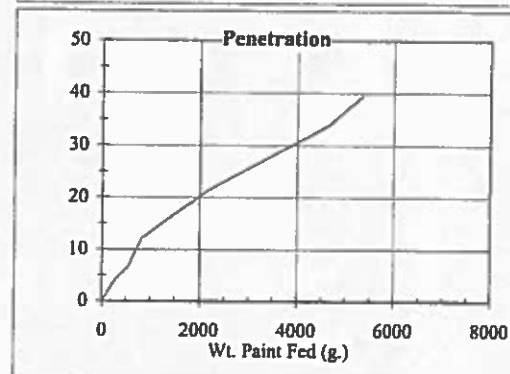
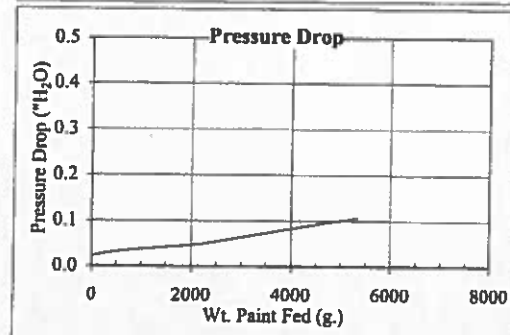
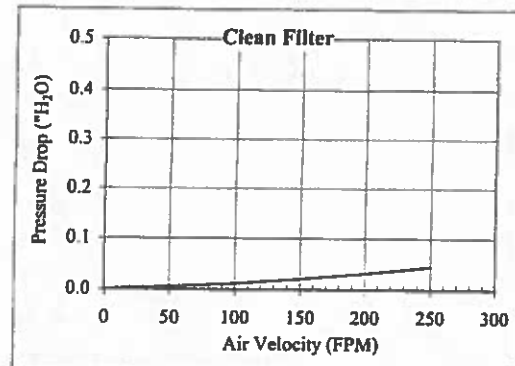

3000 SERIES™



Cabin Design

● Cabin Construction

- Insulated dual skin white powder coated galvanized steel interlocking wall panels
- Drive in back out / Drive-thru models available

● Lighting

- 27" Drive-Thru models come with (24) 4-tube light fixtures for a total of 96 tubes (23/92 DIBO)
- Light fixtures are equipped with 4 energy efficient T8 5000k color corrected fluorescent tubes
- Horizontal orientation for shadow free illumination
- Interior accessible for easier maintenance
- Dual voltage (120/277) electronic instant start ballasts
- Interlock switch disables painting operation when light access door is open
- ETL and ETL-C listed
- 6-tube, 8-tube and reflector upgrades available

● Filtration

- Pre-Filtration: Long lasting washable pre-filters reduce contamination of ceiling filters
- Ceiling Filters: Ideally sized segments allowing for ease of replacement. Filters are held in position by steel knife-edge closures. Achieves 99% capture efficiency 10 micron particulate
- Extract Filtration: Premium fiberglass paint arrestor filters are utilized for maximum particulate removal



● Pit Design

- 3-Row Pit is standard - widest pit in the industry
- Heavy Duty Light Weight Galvanized Pressed Steel Grates
 - Lighter than welded grates while providing the same load bearing capabilities
 - Easily serviced by one person
 - Grates run the entire length of the pit
- Galvanized steel plate filter supports
- Pit and Plenum balancing plates for balanced airflow

External Dimensions			Internal Dimensions		
L	W	H	L	W	H
24' 4-3/8"	13' 6-5/8"	10' 10"	23' 11-5/8"	13' 1-1/2"	8' 10-1/2"
27' 2-1/4"	13' 6-5/8"	10' 10"	26' 9-1/4"	13' 1-1/2"	8' 10-1/2"
31' 10-1/4"	13' 6-5/8"	10' 10"	31' 5-5/16"	13' 1-1/2"	8' 10-1/2"

● Doors

Entrance/Exit

- 10"W trifold doors with durable v-seal rubber gaskets for an airtight seal
- Flush mounted tempered observation windows in all doors (32"x35")
- Heavy duty easily adjustable hinges with grease zerk fittings
- Heavy duty latches and handles for years of reliability
- Locking hardware built inside to minimize dirt collection zones

Side Service Door

- Standard on drive-in back out
- Large flush mounted observation window (28"x35")
- Durable v-seal rubber gasket for airtight seal
- Panic latch
- Heavy duty easily adjustable hinges with grease zerk fittings

Fire Suppression

- Designed to accept fire suppression equipment (supplied by others)

Operations & Controls

● Mechanical Configuration

- 10 HP dual inlet reverse incline intake fan
- 10 HP dual inlet reverse incline exhaust fan
- 1 or 1.5 MBTU direct fired burner

● Touch Screen Controls

- ETL listed Control Panel features PLC which sequences spray and bake mode temperature settings
- Stores up to 8 paint recipes
- User friendly interface featuring touch screen and switches
- Maintenance and self-diagnostic functions
- Data retrieval capabilities with upgraded software
- Upgrade to WiFi connectivity for smartphone, tablet and PC operational capabilities



Options

- Accele-Cure®
- 15 HP Upgrade
- Blower systems
- Production enhancing accessories
- Air Knife
- Outdoor temper resistant doors
- Upgraded frontals
- Light Protection Film
- Drive-Thru
- 270E mechanical option

1401 W Stanford, Englewood CO 80110 800-442-7628 Fax 303-781-2683 www.garmat.com / sales@garmat.com

800-4-GARMAT
800-442-7628



CODE COMPLIANCE*

Garmat equipment is built to meet or exceed all applicable codes ETL listed

Conforms to NFPA 33 Standards

National Emission Standards for Hazardous Air Pollutants - NESHAP SubPart HHHHHH

OSHA Safety and Health Standards (29CFR 1910.107)

*Code compliance is dependent upon the manner in which the equipment is installed and used. The equipment installation is dependent on the local jurisdiction authorities. To ensure compliance it is recommended that Garmat equipment be installed by a certified Garmat Distributor.



FULL DOWNDRAFT SPRAY BOOTH

3000 SERIES™

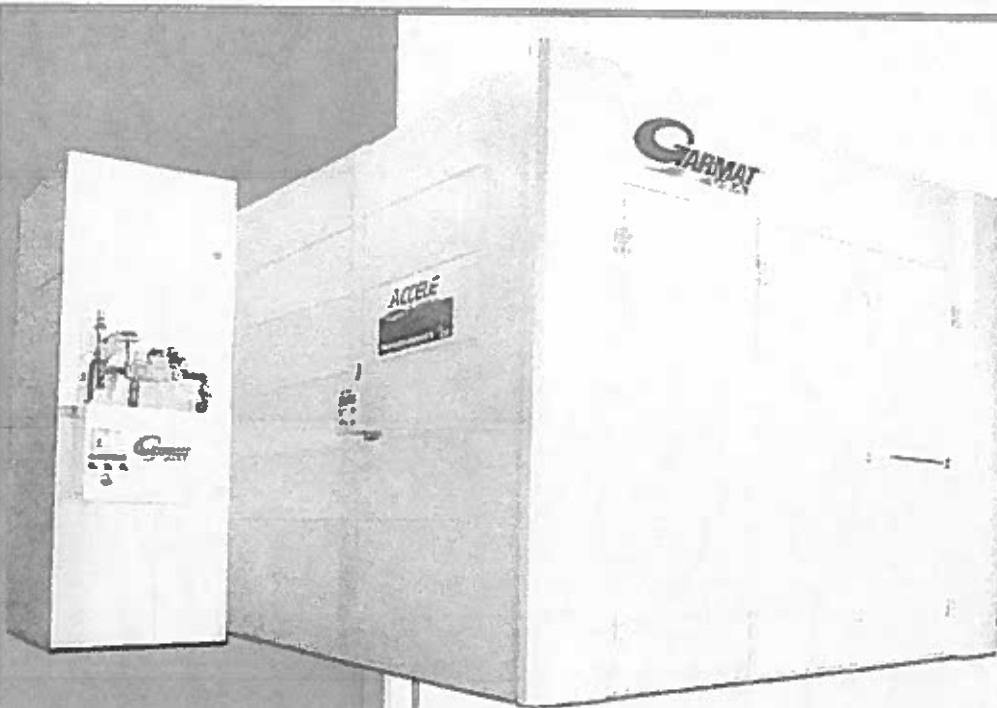

Superior Airflow

Dual inlet reverse incline fans for more consistent air flow

Premium Lighting

Horizontal orientation for virtually shadow free illumination

Innovative Controls

PLC based Logic, Garmat USA controls are available in Touchscreen, Touchpad and Standard Design

Uncompromised Quality

*Dual Skin Construction
Heavy Duty Doors
Long reliable service life*

The 3000 Series™ Spray Booth is Garmat® USA's top of the line downdraft spray booth. It has superior airflow and the most effective lighting in any booth available in the market today. Standard features include:

- Dual Inlet Reverse Incline Fans with Airfoil Blades on both supply and exhaust
- Superior lighting, horizontally placed for virtually shadow free illumination
- 3-Row pit equipped with light weight, heavy duty grates
- Garmat's Touchscreen controls with a user friendly interface

Garmat Downdraft Paint Booths feature dual inlet reverse incline fans providing the most consistent airflow of any downdraft booth on the market.

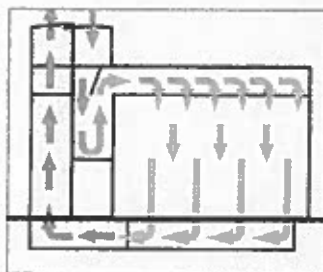
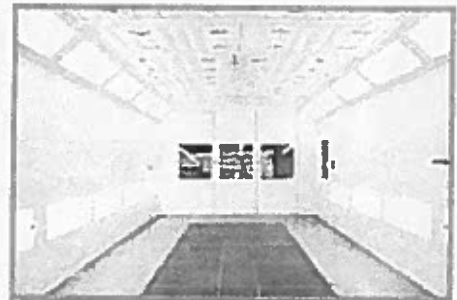

Downdraft Airflow



Dual Inlet Reverse Incline Fans with Air Foil Blades for more consistent airflow



SIC Code 7532 Top, Body, and Upholstery Repair Shops and Paint Shops

Classification/ [Services](#) / [Automotive Repair...](#) / [Automotive Repair...](#) / Top, Body, and Upholstery R...

Industry

Services

Description

Establishments primarily engaged in the repair of automotive tops, bodies, and interiors, or automotive painting and refinishing. Also included in this industry are establishments primarily engaged in customizing automobiles, trucks, and vans except on a factory basis.

Cross References

Establishments primarily engaged in customizing automobiles, trucks, and vans on a factory basis are classified in manufacturing, industry group 371.

Illustrative Examples

Antique and classic automobile restoration, automotive body shops, automotive interior shops, automotive paint shops automotive tops (canvas or plastic), installation, repair, or sales and automotive trim shops, bump shops (automotive repair), collision shops, automotive customizing automobiles, trucks or vans: except on a factory basis upholstery repair, automotive van conversions, except on a factory basis.

Sample Business Listings

- [Spartan Motors Chassis](#)
- [PPG Industries](#)
- [Service King Collision Repair Center](#)
- [Manheim Ohio](#)
- [PPG Industries](#)
- [Terex Utilities](#)
- [Toyota Logistics Services](#)
- [House Of Imports Collision Center](#)
- [Manheim Fort Wayne](#)
- [Nelson Global Products](#)
- [PPG Industries](#)
- [Toyota Logistics Service](#)
- [Point Blank Body Armor](#)
- [Victoria British Limited Auto Parts](#)
- [Kuni Chevrolet Cadillac](#)
- [Houston Freightliner](#)
- [All Star Ford Dodge](#)
- [Terex Utilities](#)
- [Manheim Louisville](#)

- Dattco Body Shop
- Abra Auto Body And Glass
- North Point Collision Center
- Nelson Global Products
- Terry Labonte Chevrolet Collision Center
- PPG Industries

Further Classification

6-digit SIC

- 753201Automobile Body-repairing & Painting
- 753202Automobile Paint
- 753203Automobile Customizing
- 753204Automobile Restoration-antique & Classic
- 753205Automobile-reconditioning
- 753206Truck-painting & Lettering
- 753207Automobile Seatcovers Tops & Upholstery
- 753208Van & Truck Conversions & Accessories
- 753209Wheel Chair Van Lifts
- 753210Motorcycles & Motor Scooters-painting
- 753211Motorcycles-customizing
- 753212Truck Bodies-repairing
- 753213Automobile Pin Striping
- 753214Automobile-wood Refinishing
- 753215Limousine-conversions
- 753216Boat & Yacht Customizing
- 753217Boat Restoration
- 753218Canvas Goods-repairing
- 753220Automobile-new Car Pre-delivery Service
- 753221Truck Chassis Alterations & Equipment
- 753223Bus Conversion
- 753225Automobile Paint Repairing
- 753226Horse Carriages-build Repair Restore

7-digit SIC

- 7532001Automobile Body-repairing & Painting
- 7532002Automobile Body Shops
- 7532003Automobile Painting
- 7532004Automobile Collision Repair
- 7532005Automobile Seat Covers Tops & Upholstery
- 7532006Automobile Restoration-antique & Classic
- 7532007Automobile Customizing
- 7532008Exterior Repair Services
- 7532009Truck-painting & Lettering
- 7532010Truck Body Shops
- 7532011Lettering & Painting Services
- 7532012Interior Repair Services
- 7532013Automobile Top Installation & Repair
- 7532014Automobile Bump Repair
- 7532015Van & Truck Conversions & Accessories
- 7532016Mobile Home & Trailer Repair

- 7532017Automobile Lettering
- 7532018Automobile-reconditioning
- 7532019Wheel Chair Van Lifts
- 7532020Motorcycles & Motor Scooters-painting
- 7532021Motorcycles-customizing
- 7532022Truck Bodies-repairing
- 7532023Automobile Pin Striping
- 7532024Automobile-wood Refinishing
- 7532025Limousine-conversions
- 7532026Boat & Yacht Customizing
- 7532027Boat Restoration
- 7532028Canvas Goods-repairing
- 7532029Automobile-new Car Pre-delivery Services
- 7532030Truck Chassis Alterations & Equipment
- 7532031Bus Conversion
- 7532032Automobile Paint Repairing
- 7532033Horse Carriages-build Repair Restore

8-digit SIC

- 75320000Top And Body Repair And Paint Shops
- 75320100Interior Repair Services
- 75320101Upholstery And Trim Shop, Automotive
- 75320200Lettering And Painting Services
- 75320201Lettering, Automotive
- 75320202Paint Shop, Automotive
- 75320203Truck Painting And Lettering
- 75320300Customizing Services, Nonfactory Basis
- 75320301Van Conversion
- 75320400Exterior Repair Services
- 75320401Body Shop, Automotive
- 75320402Body Shop, Trucks
- 75320403Bump Shops, Automotive Repair
- 75320404Collision Shops, Automotive
- 75320405Tops (canvas Or Plastic), Installation Or Repair: Automotive
- 75329901Antique And Classic Automobile Restoration
- 75329902Mobile Home And Trailer Repair

Free Business Search - SIC 7532**Buy Industry List for SIC 7532**

Order Full Details From 15 Million Companies

Business Listings

Total Companies: **13025**

Est. Employment: **168358**

Currituck County GIS Online Mapping

*Only Other Body Shop in Currituck
Atlantic Collision & Fiberglass*

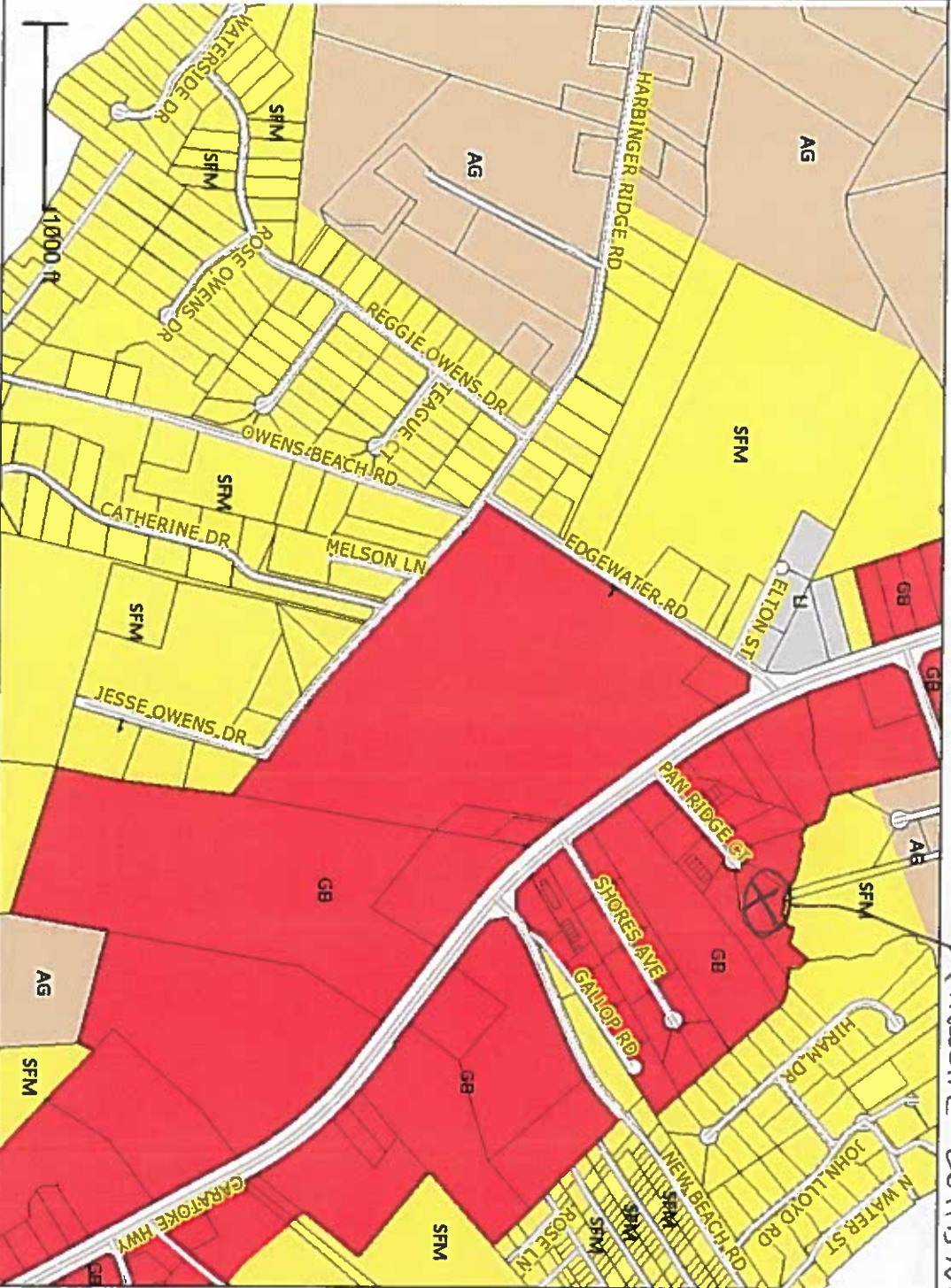

Currituck County GIS
(252)232-2034
www.co.currituck.nc.us/Geographic-Information-Services.cfm

This map should be used for general reference purposes only. Currituck County assumes no legal liability for the information shown on this map.

- Communities
 - Arden
 - Banco
 - Corlock
 - Corolla
 - Currituck
 - Olds Woods
 - Grandy
 - Harbinger
 - Jarvisburg
 - Kenneth Island
 - Maple
 - Mayock
 - Paint Harbor
 - Poplar Branch
 - Rowette Point
 - Shawboro
 - Sligo
 - Waterbury
- County Boundary
- Streets
 - County
 - Wright Memorial Bridge
- Major Streets
 - Arterial, Principal
 - Collector, Major
 - Ferry Route
- Parcel Land Hooks
- Parcels
- Official Zoning (AP Over)
- Official Zoning (RET Over)
- Official Zoning (CDPUD Over)
- Official Zoning (PUD Over)
- Official Zoning (Base Dist)
- AG
- SFM
- SFO
- SFI
- SFR
- MXR
- GB
- LB
- LI
- HI
- PD-M
- C-HI
- C-MXR
- C-SFM
- C-GB
- Currituck County



The City of Elizabeth City

Harbor of Hospitality

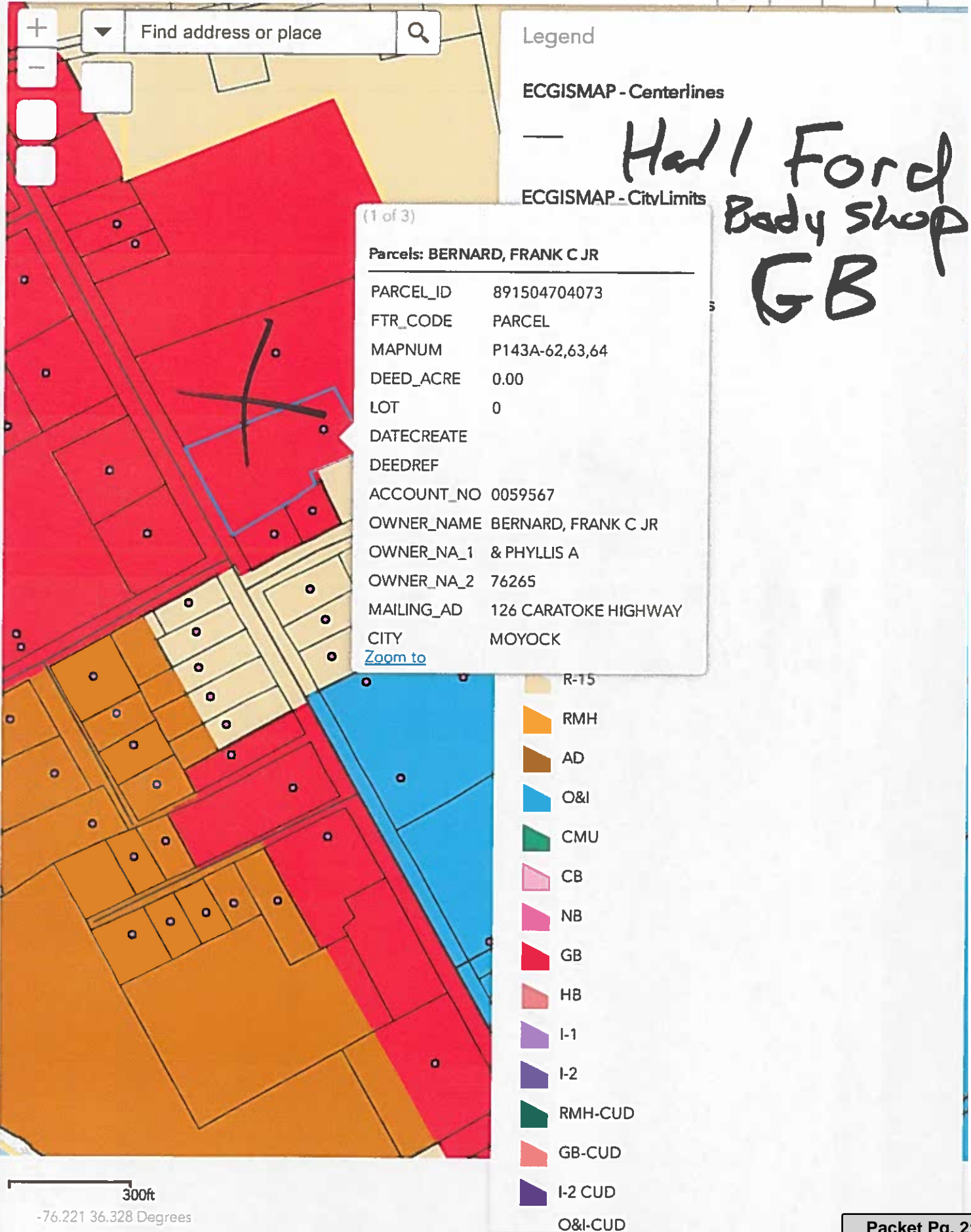



This map is prepared from data used for the inventory of the real property for tax purposes. Primary information sources such as recorded deeds, plats, wills, and other primary public records should be consulted for verification of the information contained in this map.

DARE COUNTY ASSUMES NO LEGAL RESPONSIBILITY FOR THE INFORMATION CONTAINED IN THIS MAP.

Print Date: June 5, 2018



710 N Hwy 64/264
Manteo, NC 27954

Parcel: 023110000

Pin: 988014337386

Tax District: Manteo In

Subdivision: Roanoke Park

Lot-Blk-Sect: Lot: 4 & 15 Blk: Q Sec:

Property Use: Service

Building Type: Service Shop Or Facility

Year Built: 1986

Tax Ownership

Ron & Phil's Body Shop
Inc

Current Tax Value

Land	124,000
Building	124,200
Misc	17,400
Total	265,600

Map Legend

Scale: 1:2,133

Basemap: Aerials(2012)

Parcel Lines

Property Line

☐ Selected Parcel

Leaflet

Roanoke Island, N.C.

Official Zoning Map

1 in = 575 ft

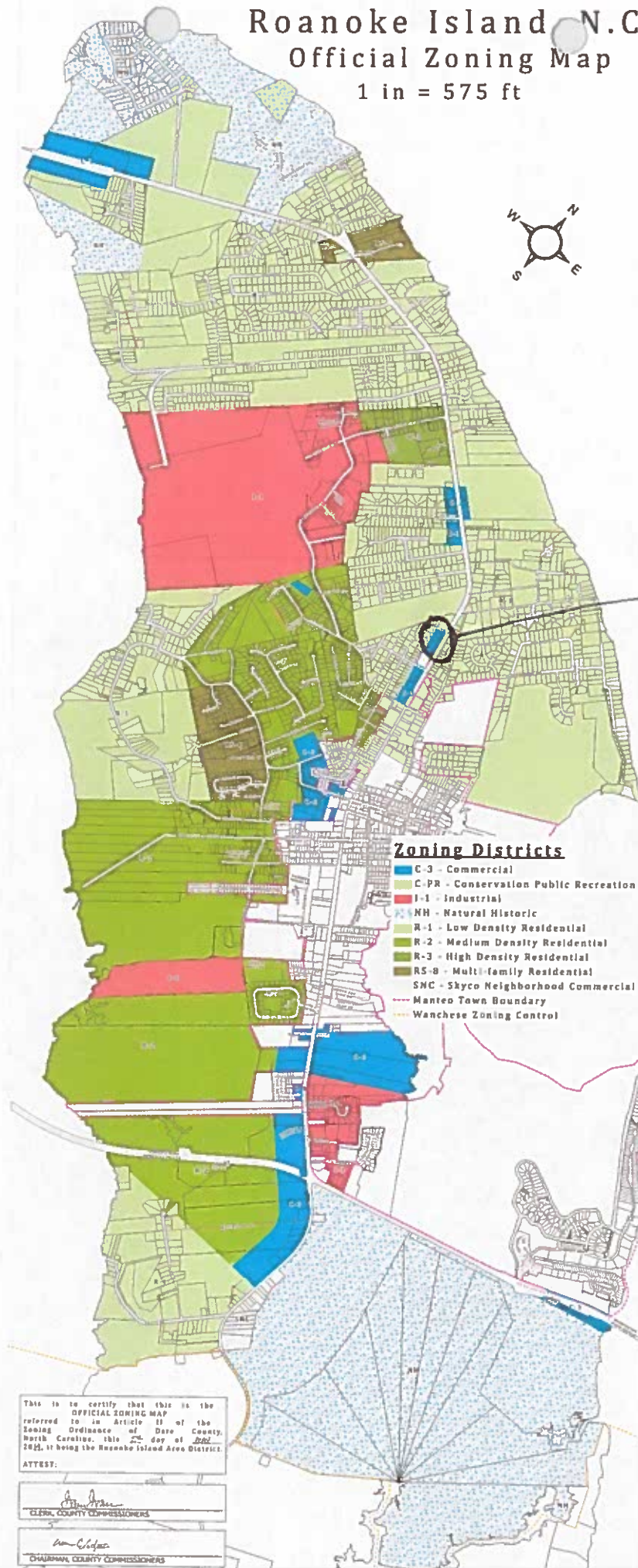

Ron + Phil's
Body Shop
Gen. Commerce

This is to certify that this is the
OFFICIAL ZONING MAP
referred to in Article II of the
Zoning Ordinance of Dare County,
North Carolina, this 25th day of 2022,
2022, it being the Roanoke Island Area District.

ATTEST:

[Signature]
CLERK, COUNTY COMMISSIONERS

[Signature]
CHAIRMAN, COUNTY COMMISSIONERS



The City of Elizabeth City

Harbor of Hospitality

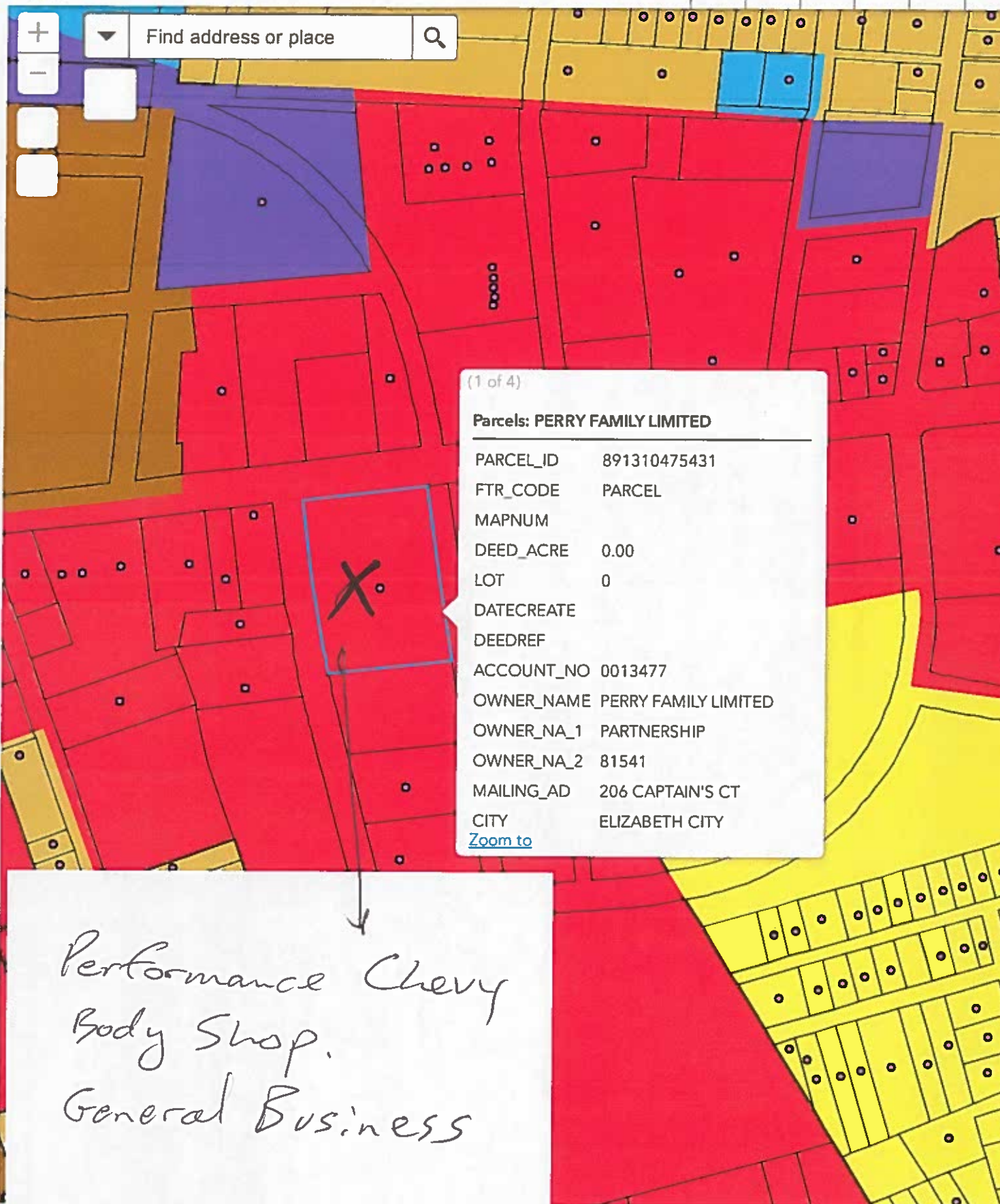

Attachment: PB 18-17 Applicant Submitted Forms (PB 18-17 Jay Winslow and Jason Graham)

▼

Find address or place

Q

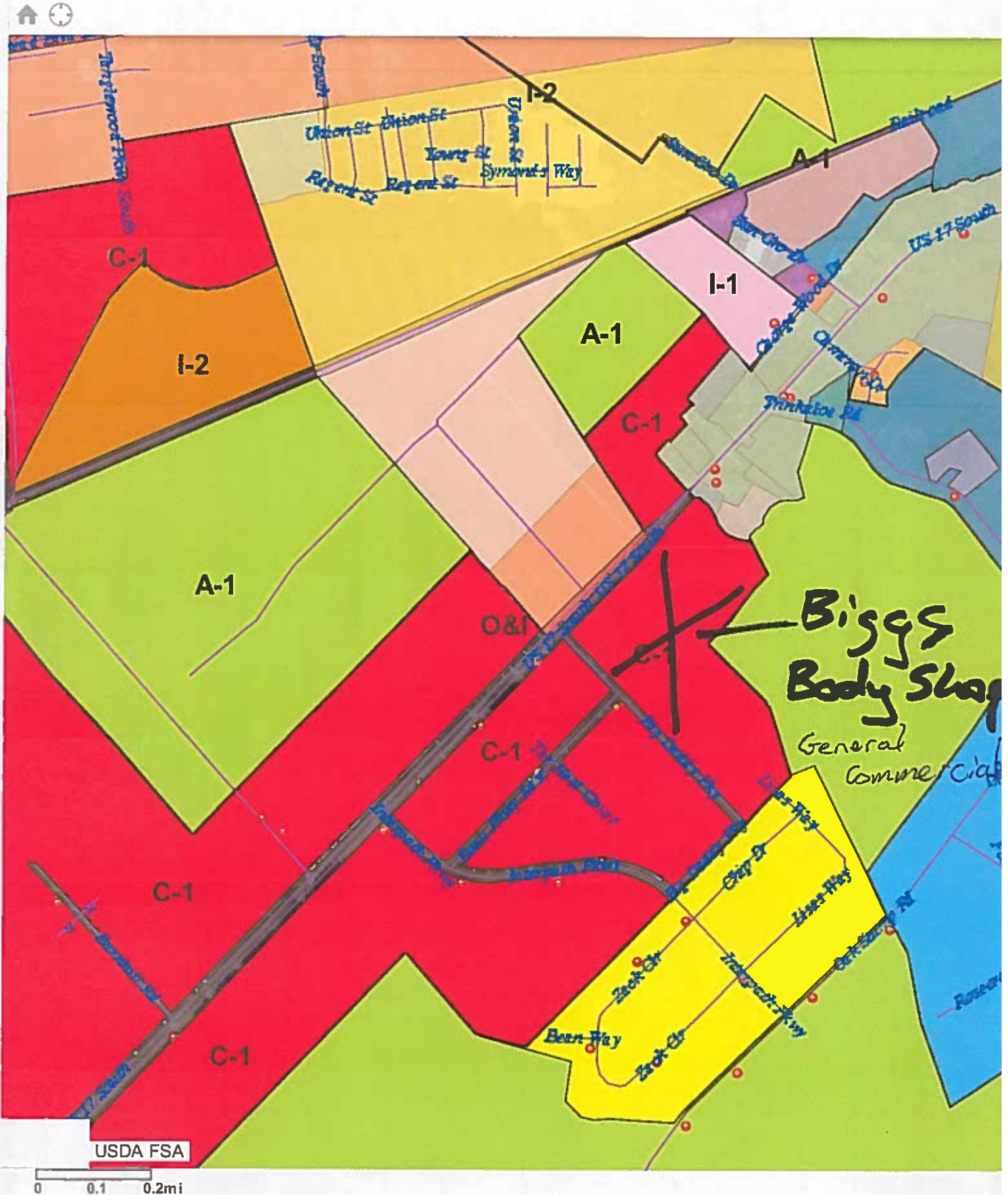

Attachment: PB 18-17 Applicant Submitted Forms (PB 18-17 Jay Winslow and Jason Graham)

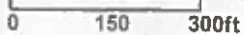
- BASE MAPS
0
 - MAP LAYERS
0
 - MAP TOOLS
0
 - SEARCH
0
 - PRINT
0
 - SHARE
0
 - HELP
- T/ROKMAPS_HB P/ROKMAPS_I
(https://www.roktech.net)

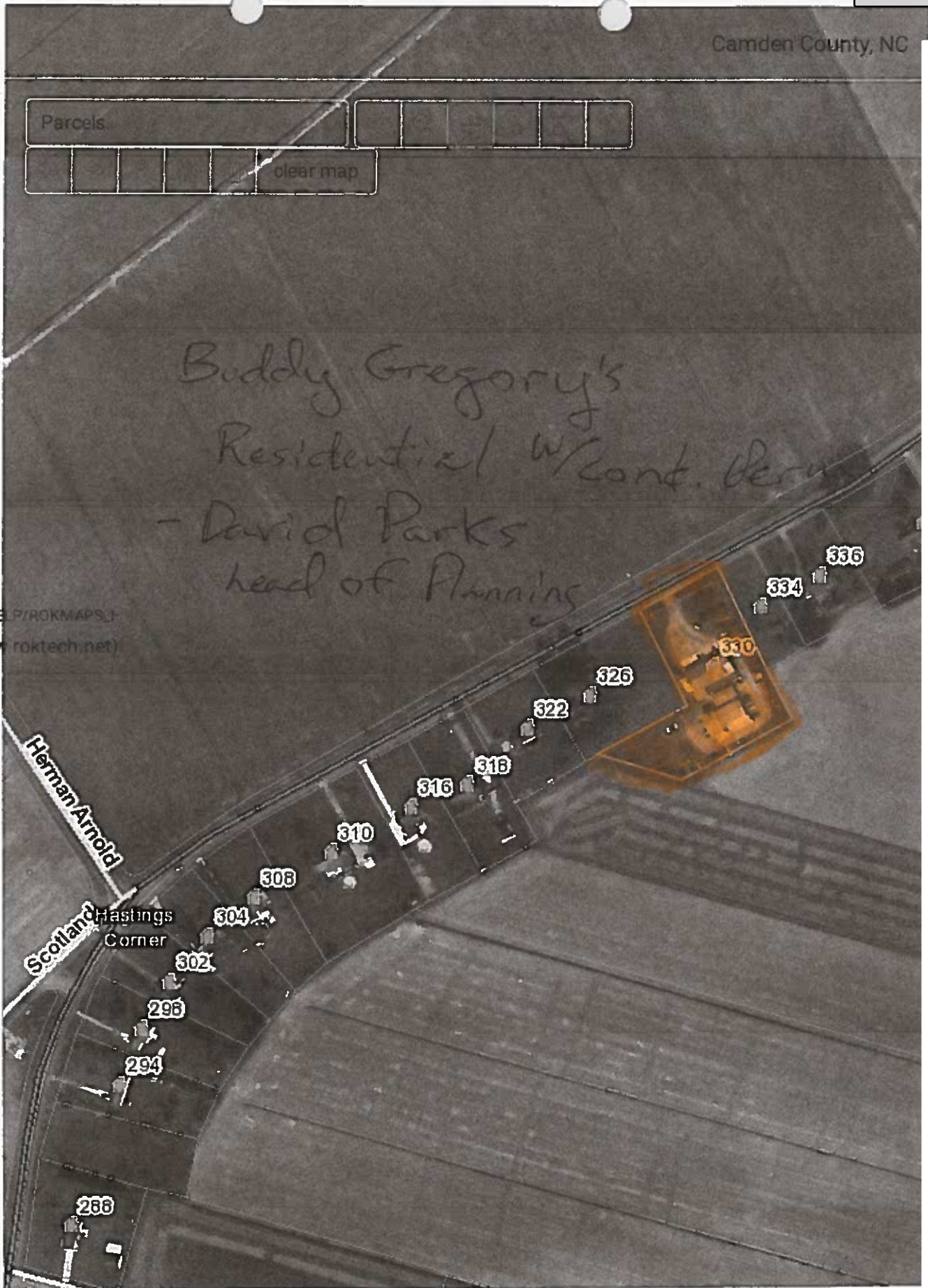

Attachment: PB 18-17 Applicant Submitted Forms (PB 18-17 Jay Winslow and Jason Graham)