

**NOTES**

ALL PLANTS SHALL MEET MINIMUM STANDARDS OUTLINED IN THE AMERICAN STANDARDS FOR NURSERY STOCK, (LATEST EDITION) PUBLISHED BY THE AMERICAN ASSOCIATION OF NURSERYMEN, INC.

PLANTS SHALL BE SOUND, HEALTHY AND VIGOROUS, BE WELL BRANCHED AND DENSELY FOLIATED WHEN IN LEAF. PLANTS SHALL BE FREE OF DISEASE, PESTS, EGGS/LARVAE AND THEY SHALL BE FREE OF DAMAGE, DAMAGE INCLUDES, BUT IS NOT LIMITED TO SCRAPES ON THE BARK OR EVIDENCE OF GIRDLING FROM WIRE OR OTHER STAKING/BINDING MATERIAL.

CONTAINER PLANTS SHALL BE FREE OF SEVERE ROOT BOUND CONDITIONS. CONTRACTOR TO LIGHTLY SCARIFY/LOOSEN ROOTS AT TIME OF PLANTING.

ALL PLANTS SHALL BE PURCHASED FROM BONA-FIDE WHOLESALE NURSERIES AND/OR GROWERS.

PLANTS SHALL BE COVERED BY TARP OR WITHIN ENCLOSED TRUCK DURING TRANSPORT TO SITE.

SUBSTITUTIONS SHALL BE APPROVED BY THE OWNER OR THEIR DESIGNATED REPRESENTATIVE.

DESIGNATED MULCH AREAS TO BE MULCHED WITH A 4" DEPTH OF CLEAN, UN-DYED, TRIPLE SHREDDED HARDWOOD MULCH.

PLANT QUANTITIES SHOWN IN PLANTING LIST IS FOR CONTRACTOR CONVENIENCE ONLY. IT IS THE CONTRACTORS RESPONSIBILITY TO OBTAIN QUANTITIES BASED ON PLANTS SHOWN ON THE DRAWINGS.

ANY EXISTING TREES AND PHYSICAL IMPROVEMENTS ARE SHOWN FOR REFERENCE ONLY. ADDITIONAL TREES/IMPROVEMENTS NOT SHOWN MAY EXIST ON SITE.

ALL PLANTS TO RECEIVE A SOIL ADDITIVE AT TIME OF PLANTING. SOIL ADDITIVE SHALL CONSIST OF ONE PART TOPSOIL TO ONE PART SAND. BOTH SAND AND TOPSOIL SHALL BE FREE OF ROOT, ROCKS OR OTHER MATERIAL AND SHALL BE THOROUGHLY MIXED PRIOR TO PLANTING.

ALL PLANTS TO BE LIGHTLY TAMPED AFTER PLANTING TO ELIMINATE AIR POCKETS AND TO FIRMLY STABILIZE PLANTING.

ALL MULCHED LANDSCAPE BEDS TO BE BORDERED BY A TRENCHED EDGE.

ALL LANDSCAPED BEDS TO RECEIVE A 1 FOOT DEPTH OF CLEAN SAND PRIOR TO PLANTING.

CONTRACTOR TO WARRANTY PLANTS FOR ONE YEAR.

CONTRACTOR TO LOCATE ALL UTILITY SERVICE LINES (INCLUDING WATER) THAT SERVICE BUILDINGS PRIOR TO DEMOLITION/PLANTING.

**LEGEND AND PLANT LIST**

QTY.	COMMON NAME	BOTANICAL NAME	SIZE/ COND.	SPACING	REMARKS
105	Crape Myrtle	Lagerstroemia indica	15 Gal. Cont., 5-6" Ht.	50' O.C.	Tuscarora variety
	Pink Muhly Grass	Muhlenbergia capilaris	3 Gal. Cont.	3' O.C.	
	Sea Green Juniper	Juniperus chinensis 'Sea Green'	3 Gal. Cont.	4' O.C.	
	Sweet Drift Rose	Rosa 'meiswestdom'	3 Gal. Cont.	4' O.C.	Pink Flowers
	Dianthus	Perennial Dianthus	1 Gal. Cont.	2' O.C.	

NOTE:

ALL TREES TO BE PLANTED 16' FROM THE EDGE OF PAVEMENT OF OCEAN TRAIL

**BID ALTERNATE**  
Provide price for one typical landscape bed. Bed to be raised as per notes. Fencing not included.

**BASE BID**  
Provide price for Crape Myrtles only.

BEGIN PLANTINGS AT END OF EXISTING ASPHALT PATH JUST NORTH OF TOWNE BANK. END PLANTINGS 50' +/- SOUTH OF MONTERAY DR. ACROSS FROM BONITO DR.

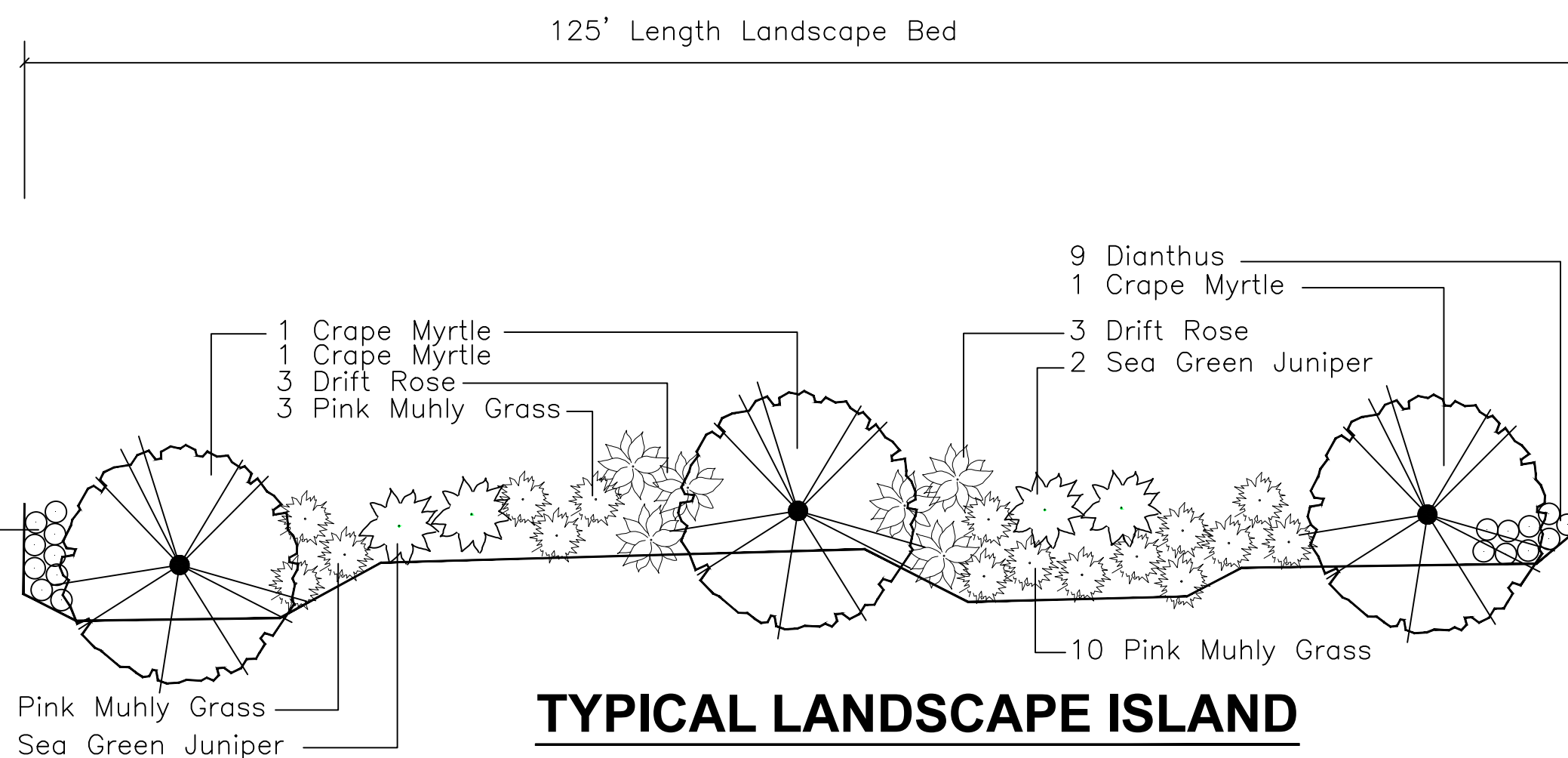

50' Spacing  
Between All Trees

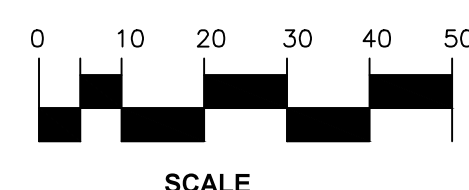
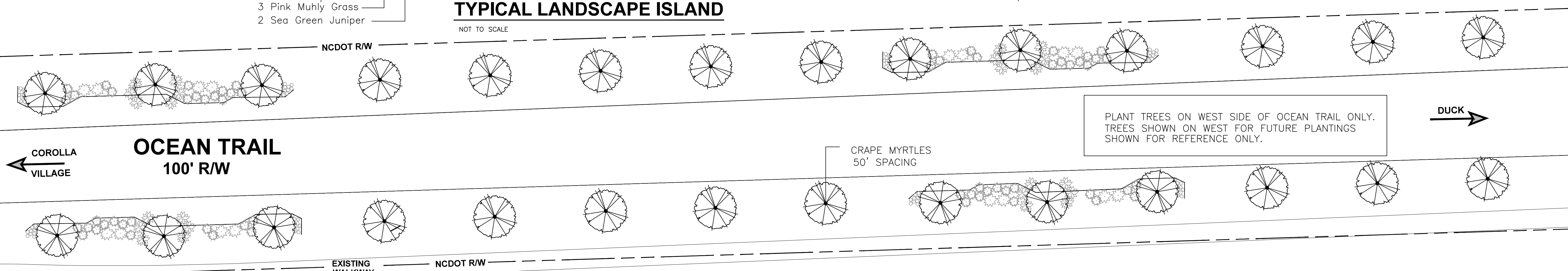

**Monterey Park**

**ISSUED FOR BID**

**LAUGHING GULL DESIGN STUDIO**  
LANDSCAPE ARCHITECTURE • LANDPLANNING • ENVIRONMENTAL CONSULTING  
KITTY HAWK, NORTH CAROLINA 27949  
PHONE (252) 261-8747

**Greenspace**

**Landscape Planning & Design**  
Nags Head, NC 27959  
252-673-9346

**811**  
Know what's below.  
Call before you dig.

**Currituck**

**Corolla Beautification Project**  
Currituck County, North Carolina  
**October 1, 2017**  
rev. 10/20/17, 10/27/17 **DWG CBP 5**