

SURFACE 678, P.A.  
 215 MORRIS STREET, SUITE 150  
 DURHAM, NC 27701  
 WWW.SURFACE678.COM  
 P: 919-419-1199  
 F: 919-419-1669

**Surface**

PACE COLLABORATIVE PC.  
 1277 PERIMETER PKWY.  
 VIRGINIA BEACH, VA 23454  
 T: 757-499-7223



CONSTRUCTION DOCUMENTS FOR CONSTRUCTION  
 DECEMBER 19, 2014

# HISTORIC COROLLA PARK / WHALEHEAD

LANDSCAPE AND PEDESTRIAN IMPROVEMENTS - PHASE I  
 CURRITUCK COUNTY



WHALEHEAD CLUB  
 CLUB ROAD  
 COROLLA, NC 27927

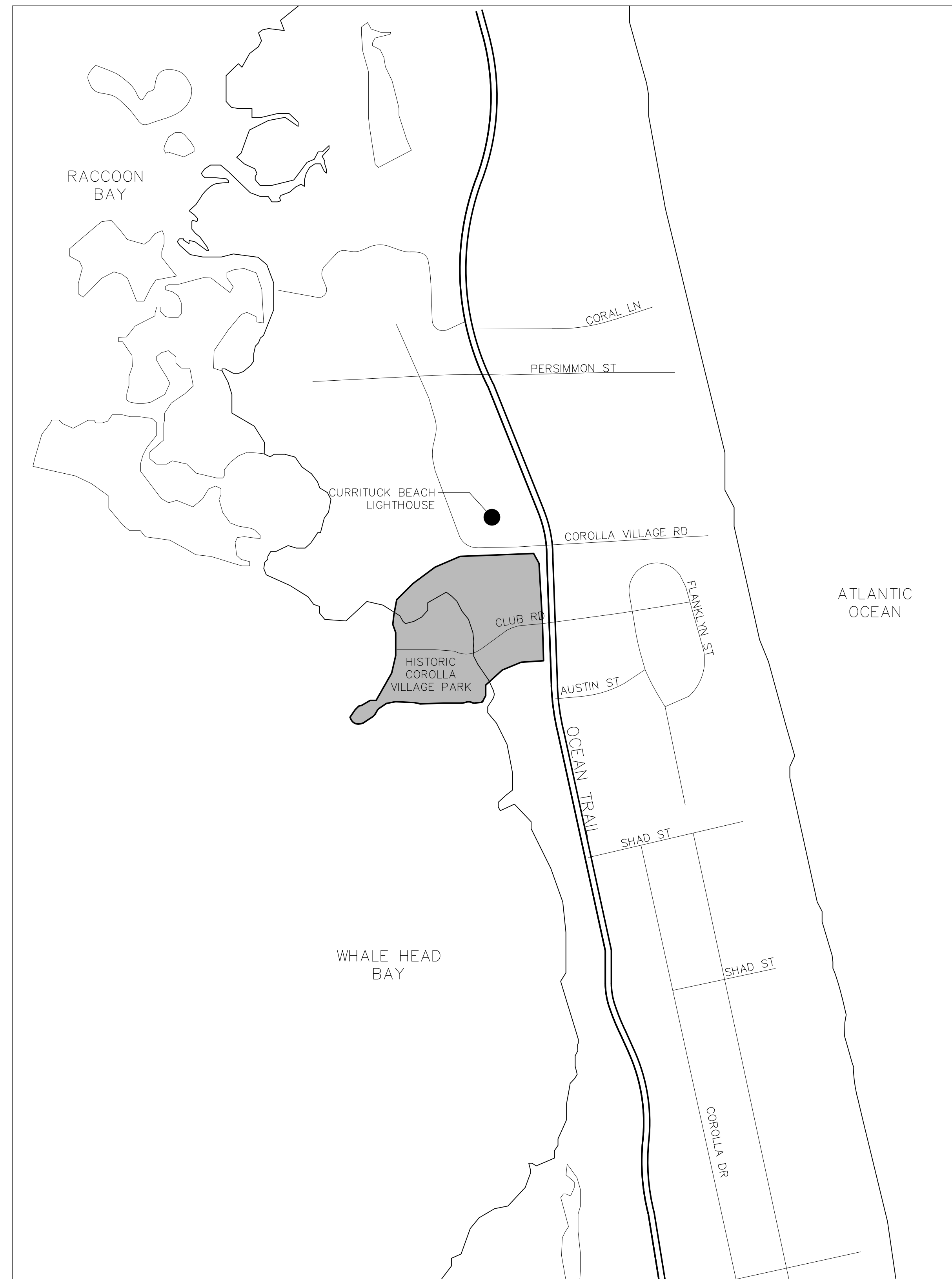

VICINITY MAP

## INDEX OF SHEETS

### LANDSCAPE

L 000	EXISTING CONDITIONS PLAN
L 001	SITE CONTEXT/ SHEET EXTENTS PLAN
L 121	DEMOLITION PLAN
L 122	DEMOLITION PLAN
L 131	LAYOUT & MATERIALS PLAN
L 132	LAYOUT & MATERIALS PLAN
L 151	GRADING PLAN
L 152	GRADING PLAN
L 161	PLANTING PLAN
L 162	PLANTING PLAN
L 500	DETAILS
L 501	DETAILS
L 502	DETAILS

### LIGHTING/ELECTRICAL

E 001	ELECTRICAL GENERAL NOTES, LEGEND, ABBREVIATIONS & SPECIFICATIONS
E 101	ELECTRICAL SITE PLANS

### EXISTING CONDITIONS NOTES

LOCATION AND TOPOGRAPHIC INFORMATION WAS TAKEN FROM SURVEY FILES PROVIDED TO SURFACE 678 BY OTHERS. SURVEY PROVIDED TO SURFACE WAS PERFORMED BY BESSELL PROFESSIONAL GROUP DATED 5-10-2013. SURFACE 678 ASSUMES NO RESPONSIBILITY FOR DESIGN OR CONSTRUCTION CHANGES CAUSED BY INACCURACIES IN SURVEY.

ADJACENT RIPARIAN PROPERTY OWNERS ARE THE STATE OF NORTH CAROLINA TO THE NORTH AND COROLLA LIGHT COMMUNITY ASSOCIATION TO THE SOUTH, AS INDICATED ON THE PLAN. SECTION 404 AND COASTAL WETLAND AREAS EXIST ON THE PROJECT SITE.

NORMAL WATER LEVEL (NWL) IS INDICATED ON THE DRAWING BASED UPON SURVEY INFORMATION OF THE EXISTING SHORELINE AT TIME SURVEY WAS PERFORMED. SURVEY WAS PROVIDED BY BESSELL PROFESSIONAL GROUP FOR HERITAGE PARK, CURRITUCK COUNTY DATED 5-10-2013.

Owner: State of North Carolina  
PIN: 011400005A0000  
D.B. 82, PG. 09  
D.B. 32, PG. 1-7  
M.B. 2, PG. 88

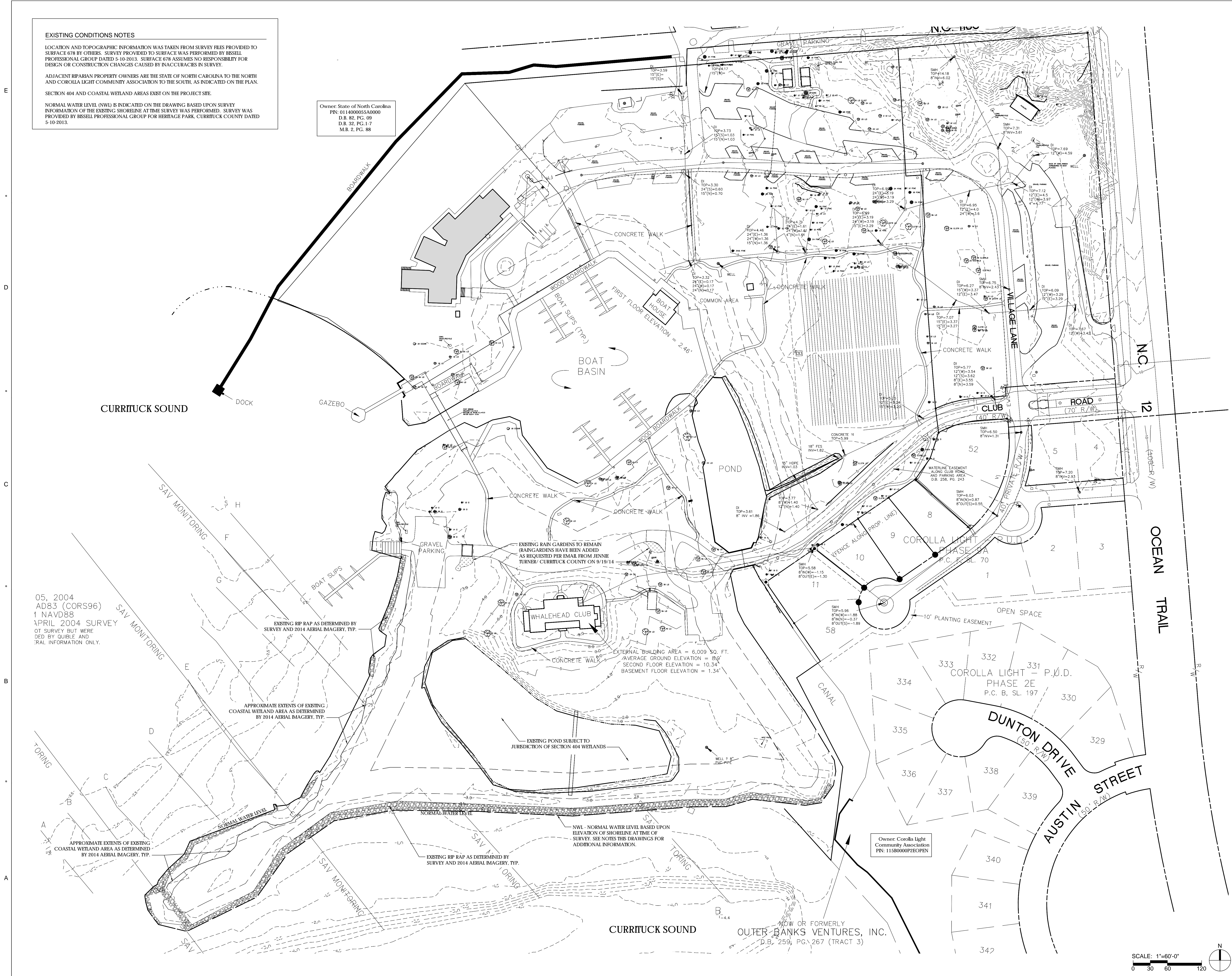

### CONSULTANTS

**PACE COLLABORATIVE PC.**  
1277 PERIMETER PKWY.  
VIRGINIA BEACH, VA 23454  
T: 757-499 7223

### REGISTRATION

### CLIENT



**WHALEHEAD CLUB**  
CLUB ROAD  
COROLLA, NC 27927

**CURRITUCK COUNTY**  
153 COURTHOUSE ROAD, SUITE 204  
CURRITUCK, NC 27929

**HISTORIC COROLLA PARK  
WHALEHEAD**

**CLUB ROAD**  
COROLLA, NC 27927

### LANDSCAPE & PEDESTRIAN IMPROVEMENTS - PHASE I

NO.	REVISION	DATE
1	SITE PLAN RESUBMITTAL	10.16.14
2	BID FOR CONSTRUCTION	12.19.14

### ISSUE: CONSTRUCTION DOCUMENTS

PROJECT NO: A0000  
DATE: DECEMBER 19, 2014  
DRAWN: JI, KL, RP  
CHECKED: RP, ED

SHEET TITLE:

**EXISTING  
CONDITIONS**

**L000**

CONSULTANTS

**PACE COLLABORATIVE PC.**  
1277 PERIMETER PKWY.  
VIRGINIA BEACH, VA 23454  
T: 757 499 7223

REGISTRATION

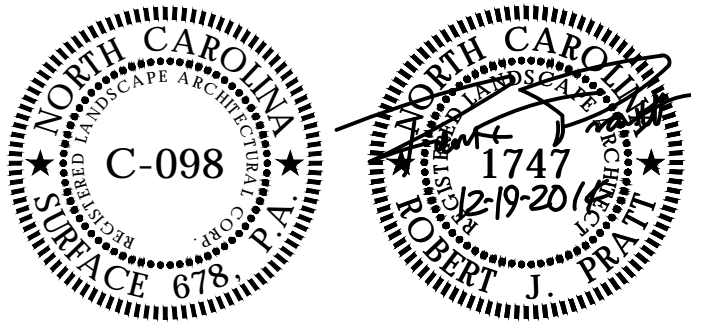

CLIENT



**WHALEHEAD CLUB**  
CLUB ROAD  
COROLLA, NC 27927

**CURRITUCK COUNTY**  
153 COURTHOUSE ROAD, SUITE 204  
CURRITUCK, NC 27929

**HISTORIC COROLLA PARK  
WHALEHEAD**

CLUB ROAD  
COROLLA, NC 27927

**LANDSCAPE & PEDESTRIAN  
IMPROVEMENTS - PHASE I**

NO.	REVISION	DATE
1	SITE PLAN RESUBMITTAL	10.16.14
2	BID FOR CONSTRUCTION	12.19.14

ISSUE:  
**CONSTRUCTION DOCUMENTS**

PROJECT NO: A0000  
DATE: DECEMBER 19, 2014  
DRAWN: JI, KL, RP  
CHECKED: RP, ED

SHEET TITLE:  
**SITE CONTEXT/  
SHEET EXTENTS  
PLAN**

**L001**

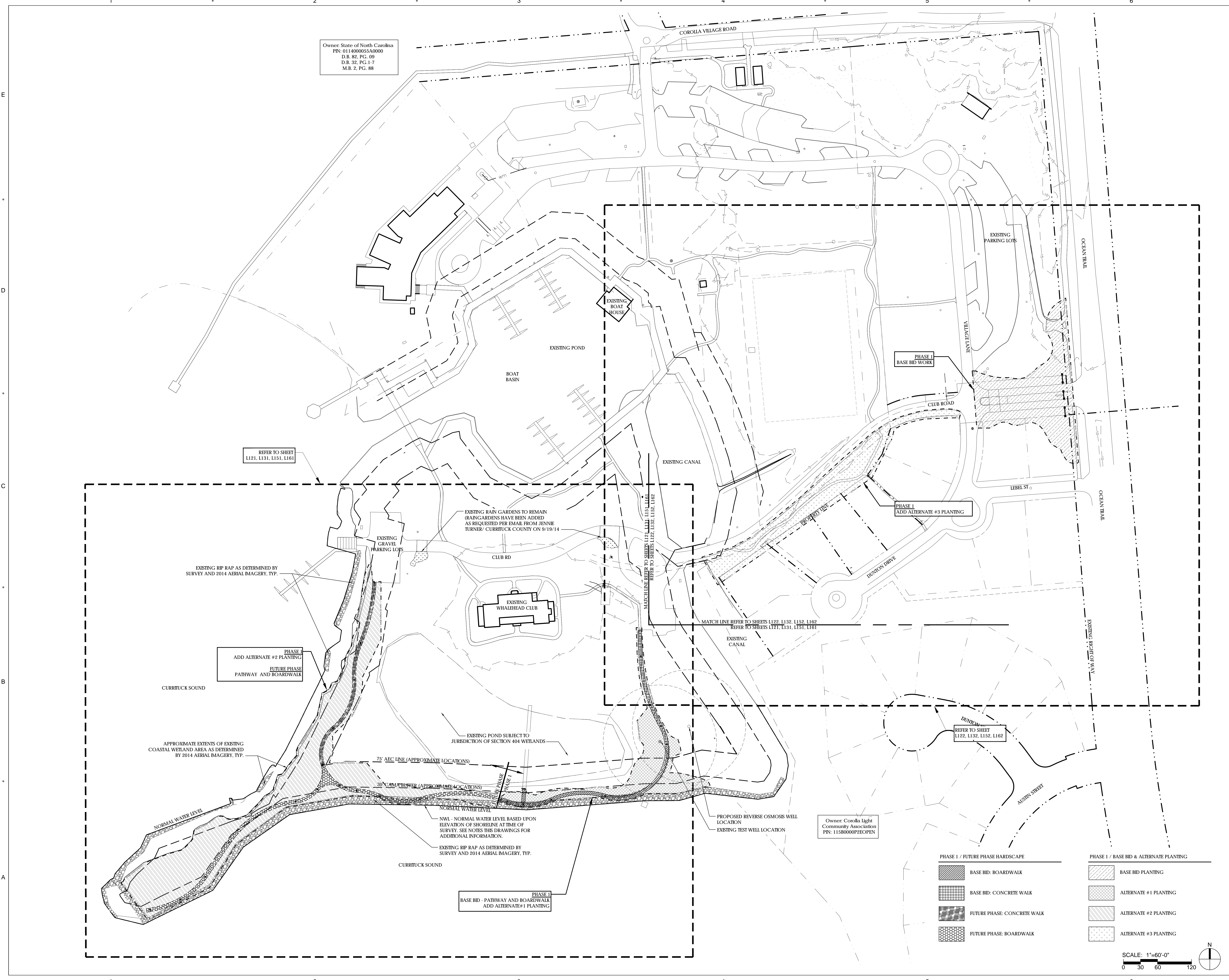

Owner: State of North Carolina  
PIN: 0114000055A0000  
D.B. 82, PG. 09  
D.B. 32, PG. 1-7  
M.B. 2, PG. 88

Owner: Corolla Light  
Community Association  
PIN: 115B0000P2EOPEN

- | PHASE I / FUTURE PHASE HARDSCAPE |                             | PHASE I / BASE BID & ALTERNATE PLANTING |                       |
|----------------------------------|-----------------------------|---|-----------------------|
|                                  | BASE BID: BOARDWALK         |   | BASE BID PLANTING     |
|                                  | BASE BID: CONCRETE WALK     |   | ALTERNATE #1 PLANTING |
|                                  | FUTURE PHASE: CONCRETE WALK |   | ALTERNATE #2 PLANTING |
|                                  | FUTURE PHASE: BOARDWALK     |   | ALTERNATE #3 PLANTING |

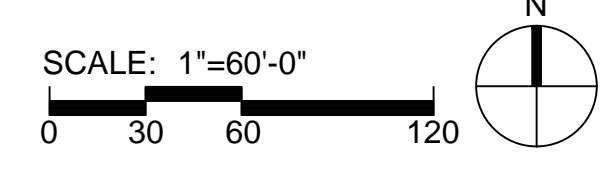

**CONSULTANTS**

**PACE COLLABORATIVE PC.**  
1277 PERIMETER PKWY.  
VIRGINIA BEACH, VA 23454  
T: 757 499 7223

**REGISTRATION**

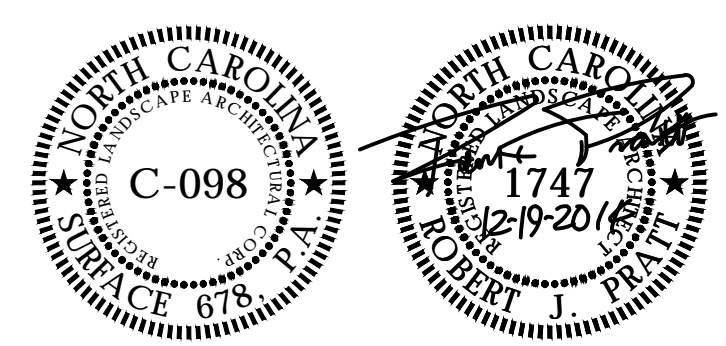

**CLIENT**



**WHALEHEAD CLUB**  
CLUB ROAD  
COROLLA, NC 27927

**CURRITUCK COUNTY**  
153 COURTHOUSE ROAD, SUITE 204  
CURRITUCK, NC 27929

**HISTORIC COROLLA PARK  
WHALEHEAD**

CLUB ROAD  
COROLLA, NC 27927

**LANDSCAPE & PEDESTRIAN  
IMPROVEMENTS - PHASE I**

NO.	REVISION	DATE
1	SITE PLAN RESUBMITTAL	10.16.14
2	BID FOR CONSTRUCTION	12.19.14

**ISSUE:  
CONSTRUCTION DOCUMENTS**

PROJECT NO: A0000  
DATE: DECEMBER 19, 2014  
DRAWN: JI, KL, RP  
CHECKED: RP, ED

SHEET TITLE:

**DEMOLITION PLAN**

**L121**

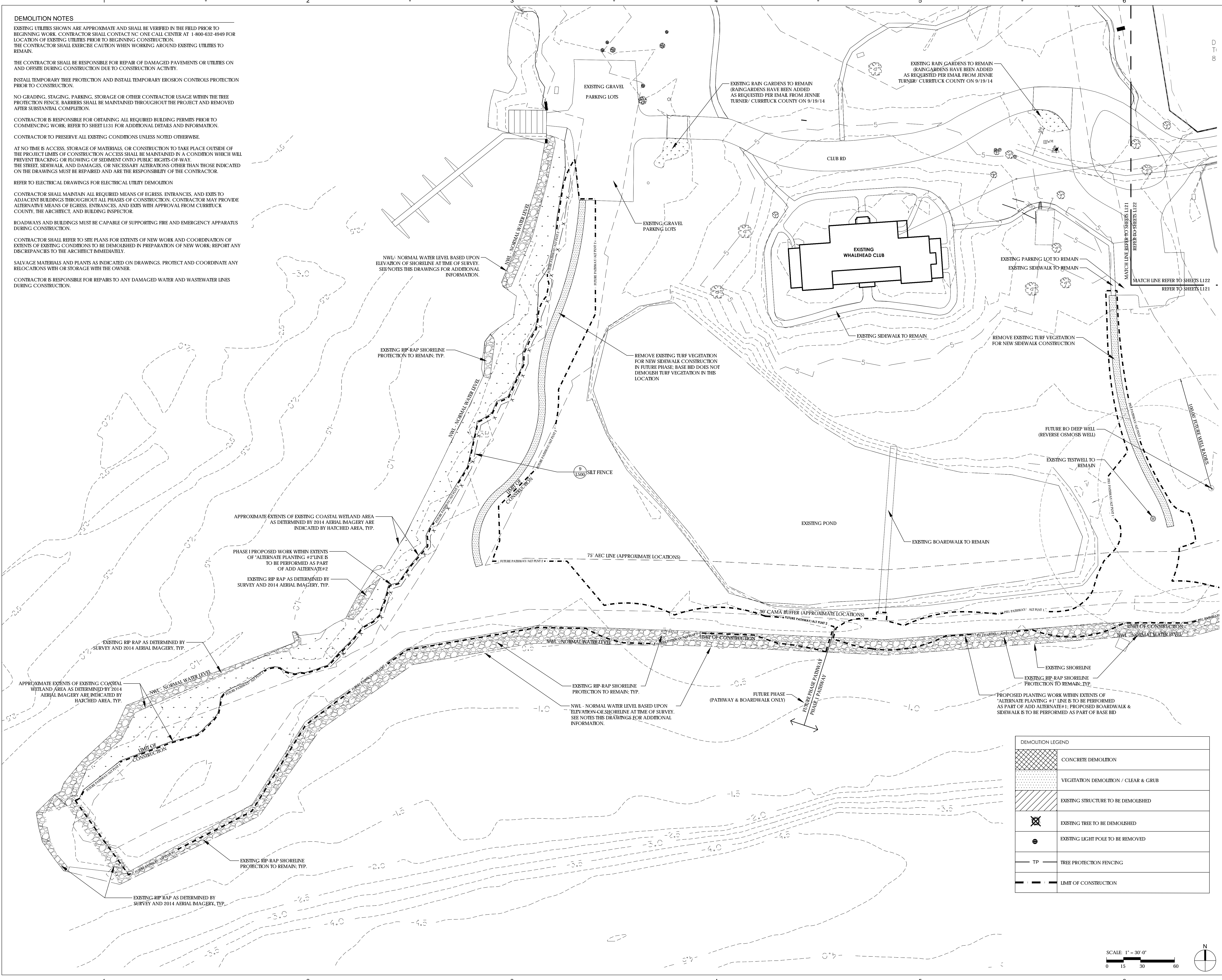

**DEMOLITION LEGEND**

	CONCRETE DEMOLITION
	VEGETATION DEMOLITION / CLEAR & GRUB
	EXISTING STRUCTURE TO BE DEMOLISHED
	EXISTING TREE TO BE DEMOLISHED
	EXISTING LIGHT POLE TO BE REMOVED
	TREE PROTECTION FENCING
	LIMIT OF CONSTRUCTION

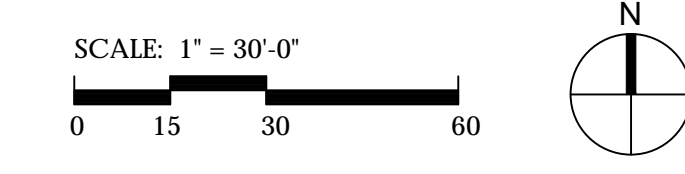

**DEMOLITION NOTES**

EXISTING UTILITIES SHOWN ARE APPROXIMATE AND SHALL BE VERIFIED IN THE FIELD PRIOR TO BEGINNING WORK. CONTRACTOR SHALL CONTACT NC ONE CALL CENTER AT 1-800-632-4949 FOR LOCATION OF EXISTING UTILITIES PRIOR TO BEGINNING CONSTRUCTION. THE CONTRACTOR SHALL EXERCISE CAUTION WHEN WORKING AROUND EXISTING UTILITIES TO REMAIN.

THE CONTRACTOR SHALL BE RESPONSIBLE FOR REPAIR OF DAMAGED PAVEMENTS OR UTILITIES ON AND OFFSITE DURING CONSTRUCTION DUE TO CONSTRUCTION ACTIVITY.

INSTALL TEMPORARY TREE PROTECTION AND INSTALL TEMPORARY EROSION CONTROLS PROTECTION PRIOR TO CONSTRUCTION.

NO GRADING, STAGING, PARKING, STORAGE OR OTHER CONTRACTOR USAGE WITHIN THE TREE PROTECTION FENCE BARRIERS SHALL BE MAINTAINED THROUGHOUT THE PROJECT AND REMOVED AFTER SUBSTANTIAL COMPLETION.

CONTRACTOR IS RESPONSIBLE FOR OBTAINING ALL REQUIRED BUILDING PERMITS PRIOR TO COMMENCING WORK. REFER TO SHEET L131 FOR ADDITIONAL DETAILS AND INFORMATION.

CONTRACTOR TO PRESERVE ALL EXISTING CONDITIONS UNLESS NOTED OTHERWISE.

AT NO TIME IS ACCESS, STORAGE OF MATERIALS, OR CONSTRUCTION TO TAKE PLACE OUTSIDE OF THE PROJECT LIMITS OF CONSTRUCTION ACCESS SHALL BE MAINTAINED IN A CONDITION WHICH WILL PREVENT TRACKING OR FLOWING OF SEDIMENT ONTO PUBLIC RIGHTS-OF-WAY, THE STREET, SIDEWALK, AND DAMAGES, OR NECESSARY ALTERATIONS OTHER THAN THOSE INDICATED ON THE DRAWINGS MUST BE REPAIRED AND ARE THE RESPONSIBILITY OF THE CONTRACTOR.

REFER TO ELECTRICAL DRAWINGS FOR ELECTRICAL UTILITY DEMOLITION.

CONTRACTOR SHALL MAINTAIN ALL REQUIRED MEANS OF EGRESS, ENTRANCES, AND EXITS TO ADJACENT BUILDINGS THROUGHOUT ALL PHASES OF CONSTRUCTION. CONTRACTOR MAY PROVIDE ALTERNATIVE MEANS OF EGRESS, ENTRANCES, AND EXITS WITH APPROVAL FROM CURRITUCK COUNTY, THE ARCHITECT, AND BUILDING INSPECTOR.

ROADWAYS AND BUILDINGS MUST BE CAPABLE OF SUPPORTING FIRE AND EMERGENCY APPARATUS DURING CONSTRUCTION.

CONTRACTOR SHALL REFER TO SITE PLANS FOR EXTENTS OF NEW WORK AND COORDINATION OF EXTENTS OF EXISTING CONDITIONS TO BE DEMOLISHED IN PREPARATION OF NEW WORK. REPORT ANY DISCREPANCIES TO THE ARCHITECT IMMEDIATELY.

SALVAGE MATERIALS AND PLANTS AS INDICATED ON DRAWINGS. PROTECT AND COORDINATE ANY RELOCATIONS WITH OR STORAGE WITH THE OWNER.

CONTRACTOR IS RESPONSIBLE FOR REPAIRS TO ANY DAMAGED WATER AND WASTEWATER LINES DURING CONSTRUCTION.

NWL - NORMAL WATER LEVEL BASED UPON ELEVATION OF SHORELINE AT TIME OF SURVEY. SEE NOTES THIS DRAWINGS FOR ADDITIONAL INFORMATION.

REMOVE EXISTING TURF VEGETATION FOR NEW SIDEWALK CONSTRUCTION IN FUTURE PHASE. BASE BID DOES NOT DEMOLISH TURF VEGETATION IN THIS LOCATION

REMOVE EXISTING TURF VEGETATION FOR NEW SIDEWALK CONSTRUCTION

APPROXIMATE EXTENTS OF EXISTING COASTAL WETLAND AREA AS DETERMINED BY 2014 AERIAL IMAGERY ARE INDICATED BY HATCHED AREA, TYP.

PHASE I PROPOSED WORK WITHIN EXTENTS OF ALTERNATE PLANTING #2 LINE IS TO BE PERFORMED AS PART OF ADD ALTERNATE #2

EXISTING RIP-RAP AS DETERMINED BY SURVEY AND 2014 AERIAL IMAGERY, TYP.

EXISTING RIP-RAP AS DETERMINED BY SURVEY AND 2014 AERIAL IMAGERY, TYP.

APPROXIMATE EXTENTS OF EXISTING COASTAL WETLAND AREA AS DETERMINED BY 2014 AERIAL IMAGERY ARE INDICATED BY HATCHED AREA, TYP.

EXISTING RIP-RAP SHORELINE PROTECTION TO REMAIN, TYP.

NWL - NORMAL WATER LEVEL BASED UPON ELEVATION OF SHORELINE AT TIME OF SURVEY. SEE NOTES THIS DRAWINGS FOR ADDITIONAL INFORMATION.

PROPOSED PLANTING WORK WITHIN EXTENTS OF ALTERNATE PLANTING #1 LINE IS TO BE PERFORMED AS PART OF ADD ALTERNATE #1. PROPOSED BOARDWALK & SIDEWALK IS TO BE PERFORMED AS PART OF BASE BID

EXISTING RIP-RAP AS DETERMINED BY SURVEY AND 2014 AERIAL IMAGERY, TYP.

EXISTING RIP-RAP SHORELINE PROTECTION TO REMAIN, TYP.



**GENERAL NOTES - APPLY TO ALL L (LANDSCAPE) - SERIES SHEETS**

LOCATION AND TOPOGRAPHICAL INFORMATION WAS TAKEN FROM AN ACTUAL FIELD SURVEY PERFORMED BY THE BESSELL PROFESSIONAL GROUP. SURFACE 678 ASSUMES NO RESPONSIBILITY FOR DESIGN OR CONSTRUCTION CHANGES CAUSED BY INACCURACIES IN SURVEYS.

THE CONTRACTOR SHALL VISIT THE SITE AND BECOME FAMILIAR WITH EXISTING SITE CONDITIONS PRIOR TO CONSTRUCTION.

THE CONTRACTOR IS RESPONSIBLE FOR OBTAINING ALL NECESSARY BUILDING PERMITS AND FOR ADHERENCE TO ORDINANCES, REGULATIONS, LAWS AND CODES HAVING JURISDICTION OVER THE PROPERTY PRIOR TO COMMENCING WORK.

TO THE BEST OF OUR KNOWLEDGE THE FOLLOWING PERMITS WILL BE REQUIRED FOR THIS PROJECT:  
 - BUILDING PERMIT FOR ALL CONSTRUCTION OUTSIDE OF THE CAMA BUFFER  
 - BUILDING PERMIT FOR ALL CONSTRUCTION WITHIN THE CAMA BUFFER (THIS WILL NEED TO BE APPLIED FOR SEPARATELY ONCE THE CAMA AMENDMENT HAS BEEN APPROVED).

ALL MATERIALS, CONSTRUCTION, AND WORKMANSHIP SHALL MEET THE CURRITUCK COUNTY SPECIFICATIONS AND DESIGN STANDARDS.

EXISTING UTILITIES SHOWN ARE APPROXIMATE AND SHALL BE VERIFIED IN THE FIELD PRIOR TO BEGINNING WORK. CONTRACTOR SHALL CONTACT NC ONE CALL CENTER AT 1-800-632-4949 FOR LOCATION OF EXISTING UTILITIES PRIOR TO BEGINNING CONSTRUCTION. THE CONTRACTOR SHALL EXERCISE CAUTION WHEN WORKING AROUND EXISTING UTILITIES TO REMAIN.

ALL WORK WITHIN THE NCDOT ROW SHALL CONFORM TO NCDOT STANDARDS AND SPECIFICATIONS. THE CONTRACTOR SHALL OBTAIN ALL NEEDED PERMITS, AGREEMENTS AND SUPPLY NOTIFICATIONS OF CLOSURES FROM THE NCDOT.

CONSTRUCTION STAKEOUT FOR THIS PROJECT SHALL BE PROVIDED BY THE CONTRACTOR USING A DIGITAL (CADD) FILE PROVIDED THROUGH THE ARCHITECT/GC. THE CONTRACTOR SHALL NOTIFY THE LANDSCAPE ARCHITECT IMMEDIATELY OF ANY DISCREPANCIES FOUND BETWEEN THE DIGITAL FILE AND THE STAKING DIMENSIONS SHOWN ON THE PLAN OR DISCREPANCIES FOUND BETWEEN THE LAYOUT AND THE SITE. ANY MODIFICATIONS MADE BY OTHERS TO THE DIGITAL FILE PROVIDED SHALL RENDER IT VOID. IN THE EVENT OF DISCREPANCIES BETWEEN THE CONTRACT DOCUMENTS AND THE DESIGN LAYOUT OR EXISTING CONDITIONS, THE CONTRACT DOCUMENTS TAKE PRECEDENCE OVER THE DIGITAL FILE.

ROADWAYS AND BUILDINGS MUST BE CAPABLE OF SUPPORTING FIRE/EMERGENCY APPARATUS DURING CONSTRUCTION. SEE ELECTRICAL SITE PLANS FOR ALL ELECTRICAL SITE UTILITY WORK.

ADJACENT RIPARIAN PROPERTY OWNERS ARE THE STATE OF NORTH CAROLINA TO THE NORTH AND COROLLA LIGHT COMMUNITY ASSOCIATION TO THE SOUTH, AS INDICATED ON THE PLAN.

SECTION 404 AND COASTAL WETLAND AREAS EXIST ON THE PROJECT SITE.

NORMAL WATER LEVEL (NWL) IS INDICATED ON THE DRAWING BASED UPON SURVEY INFORMATION OF THE EXISTING SHORELINE AT TIME SURVEY WAS PERFORMED. SURVEY WAS PROVIDED BY BESSELL PROFESSIONAL GROUP FOR HERITAGE PARK, CURRITUCK COUNTY DATED 9-10-2013.

**SITE PLANNING AND LAYOUT NOTES**

ALL SIGNS, PAVEMENT MARKINGS, AND OTHER TRAFFIC CONTROL DEVICES SHALL CONFORM TO THE MANUAL ON UNIFORM TRAFFIC CONTROL DEVICES, LATEST EDITION AS AMENDED, AND ARE THE CONTRACTOR'S RESPONSIBILITY.

THE CONTRACTOR SHALL BE RESPONSIBLE FOR ALL WORK ZONE TRAFFIC CONTROL IN OR ADJACENT TO NCDOT RIGHT-OF-WAY. ALL METHODS SHALL CONFORM TO THE MANUAL ON UNIFORM TRAFFIC CONTROL DEVICES (MUTCD) AND NCDOT STANDARDS.

CONTRACTOR SHALL PROVIDE SAW CUTS AT THE UNION BETWEEN EXISTING CONDITIONS AND PROPOSED CONSTRUCTION UNLESS OTHERWISE NOTED. REFER TO PLANS FOR ADDITIONAL INFORMATION.

UNLESS NOTED ON THE DRAWINGS ALL BUFFERS, WETLANDS, STREAM CHANNELS, SETBACKS AND TREE PROTECTION AREAS SHALL BE PROTECTED WITH NO CONSTRUCTION ACCESS, STORAGE OR USE OF ANY KIND. THE CONTRACTOR SHALL KEEP CONSTRUCTION ACTIVITIES WITHIN THE 'PROJECT LIMITS' SHOWN ON THE DRAWINGS.

ALL DIMENSIONS INDICATING 'VERIFY' SHALL BE CONFIRMED BY THE CONTRACTOR PRIOR TO STARTING CONSTRUCTION. REPORT ANY DISCREPANCIES IMMEDIATELY TO THE LANDSCAPE ARCHITECT.

ALL DIMENSIONS LABELED 'EQ' ARE TO INDICATE EQUAL MEASUREMENTS BETWEEN THE DIMENSIONS END POINTS ON THE DRAWING.

STREET AND PARKING DIMENSIONS ARE FROM FACE OF CURB UNLESS OTHERWISE INDICATED.

THE CONTRACTOR SHALL STAKE THE LAYOUT AND ALIGNMENT OF ALL PAVEMENTS, WALLS, AND OTHER SITE FEATURES IN THE FIELD FOR APPROVAL BY THE LANDSCAPE ARCHITECT PRIOR TO START OF CONSTRUCTION.

THE CONTRACTOR SHALL PROVIDE SMOOTH LAYOUT ALIGNMENTS BETWEEN EXISTING CONDITIONS AND PROPOSED SITE IMPROVEMENTS.

ALL ANGLES ARE 90 DEGREES UNLESS OTHERWISE NOTED ON THE DRAWINGS.

UNLESS OTHERWISE NOTED, CONCRETE SCORE AND EXPANSION JOINTS SHALL BE ALIGNED WITH BUILDING FEATURES AND WITH CORNERS OF PAVEMENT. SPACE THE ADDITIONAL JOINTS BETWEEN THESE POINTS EQUALLY.

THE CONTRACTOR SHALL BE RESPONSIBLE FOR REVIEWING ALL EXISTING JOB CONDITIONS. ANY ADVERSE EXISTING CONDITIONS AFFECTING THE WORK SHOWN ON THE DRAWINGS SHALL BE BROUGHT TO THE ATTENTION OF THE LANDSCAPE ARCHITECT FOR POSSIBLE CLARIFICATION OR RECONCILIATION.

ITEMS LABELED AS 'BY OTHERS' OR 'NIC' ARE FOR COORDINATION ONLY. THE CONTRACTOR IS RESPONSIBLE FOR COORDINATING THE INSTALLATION OF ANY SUCH ITEMS WITH THE OWNERS REPRESENTATIVE.

APPROXIMATE EXTENTS OF EXISTING COASTAL WETLAND AREA AS DETERMINED BY 2014 AERIAL IMAGERY ARE INDICATED BY HATCHED AREA, TYP.

PROPOSED WORK WITHIN EXTENTS OF 'ALTERNATE PLANTING #2' LINE IS TO BE PERFORMED AS PART OF ADD ALTERNATE#2

EXISTING RIP RAP AS DETERMINED BY SURVEY AND 2014 AERIAL IMAGERY, TYP.

EXISTING RIP RAP AS DETERMINED BY SURVEY AND 2014 AERIAL IMAGERY, TYP.

APPROXIMATE EXTENTS OF EXISTING COASTAL WETLAND AREA AS DETERMINED BY 2014 AERIAL IMAGERY ARE INDICATED BY HATCHED AREA, TYP.

EXISTING RIP RAP SHORELINE PROTECTION TO REMAIN, TYP.

WRAP TOE CURB AT END OF BOARDWALK

EXISTING RIP RAP AS DETERMINED BY SURVEY AND 2014 AERIAL IMAGERY, TYP.

NWL - NORMAL WATER LEVEL BASED UPON ELEVATION OF SHORELINE AT TIME OF SURVEY. SEE NOTES THIS DRAWINGS FOR ADDITIONAL INFORMATION.

EXISTING RIP-RAP SHORELINE PROTECTION TO REMAIN, TYP.

SILT FENCE, TYP.

CONCRETE SIDEWALK PAVING, TYP.

BOARDWALK / SIDEWALK ATTACHMENT DETAIL, TYP.

BOARDWALK ON-GRADE CONDITION, TYP.

EXISTING RIP-RAP SHORELINE PROTECTION TO REMAIN, TYP.

NWL - NORMAL WATER LEVEL BASED UPON ELEVATION OF SHORELINE AT TIME OF SURVEY. SEE NOTES THIS DRAWINGS FOR ADDITIONAL INFORMATION.

SOLID HATCH DENOTES EXTENTS OF BOARDWALK OVER EXISTING RIP-RAP BOARDWALK LAYOUT MAY BE FIELD ADJUSTED BY LANDSCAPE ARCHITECT AND OWNER TO MAINTAIN BOARDWALK ELEVATION LESS THAN 30" ABOVE FINISH GRADE.

PROPOSED PLANTING WORK WITHIN EXTENTS OF 'ALTERNATE PLANTING #1' LINE IS TO BE PERFORMED AS PART OF ADD ALTERNATE#1. PROPOSED BOARDWALK & SIDEWALK IS TO BE PERFORMED AS PART OF BASE BID

MATERIAL LEGEND	
	SIDEWALK PAVING
	LIMIT OF CONSTRUCTION PHASE 1 - ADD ALT #2 - PLANTING
	LIMIT OF CONSTRUCTION PHASE 1 - BASE BID - PATHWAY - BOARDWALK
	BOARDWALK TYPE I ON-GRADE CONDITION
	SOLID HATCH DENOTES EXTENTS OF BOARDWALK OVER EXISTING RIP-RAP. BOARDWALK LAYOUT MAY BE FIELD ADJUSTED BY LANDSCAPE ARCHITECT AND OWNER TO MAINTAIN BOARDWALK ELEVATION LESS THAN 30" ABOVE FINISH GRADE.

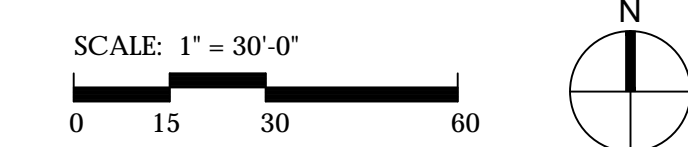

# Surface

Surface 678, P.A.  
 215 Morris Street, Suite 150  
 Durham, NC 27701  
 www.surface678.com  
 p: 919-419-1199  
 f: 919-419-1699

**CONSULTANTS**

**PACE COLLABORATIVE PC.**  
 1277 PERIMETER PKWY.  
 VIRGINIA BEACH, VA 23454  
 T: 757 499 7223

**REGISTRATION**



**CLIENT**



**WHALEHEAD CLUB**  
 CLUB ROAD  
 COROLLA, NC 27927

**CURRITUCK COUNTY**  
 153 COURTHOUSE ROAD, SUITE 204  
 CURRITUCK, NC 27929

**HISTORIC COROLLA PARK  
 WHALEHEAD**

CLUB ROAD  
 COROLLA, NC 27927

**LANDSCAPE & PEDESTRIAN  
 IMPROVEMENTS - PHASE I**

NO.	REVISION	DATE
1	SITE PLAN RESUBMITTAL	10.16.14
2	BID FOR CONSTRUCTION	12.19.14

**ISSUE:  
 CONSTRUCTION DOCUMENTS**

PROJECT NO: A0000  
 DATE: DECEMBER 19, 2014  
 DRAWN: JI, KL, RP  
 CHECKED: RP, ED

SHEET TITLE:

**LAYOUT & MATERIALS  
 PLAN**

**L131**

CONSULTANTS

**PACE COLLABORATIVE PC.**  
1277 PERIMETER PKWY.  
VIRGINIA BEACH, VA 23454  
T: 757 499 7223

REGISTRATION

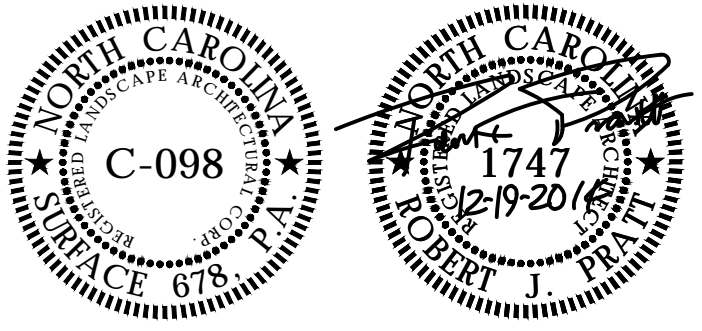

CLIENT



**WHALEHEAD CLUB**  
CLUB ROAD  
COROLLA, NC 27927

**CURRITUCK COUNTY**  
153 COURTHOUSE ROAD, SUITE 204  
CURRITUCK, NC 27929

**HISTORIC COROLLA PARK**  
WHALEHEAD

CLUB ROAD  
COROLLA, NC 27927

LANDSCAPE & PEDESTRIAN  
IMPROVEMENTS - PHASE I

NO.	REVISION	DATE
1	SITE PLAN RESUBMITTAL	10.16.14
2	BID FOR CONSTRUCTION	12.19.14

ISSUE:

**CONSTRUCTION DOCUMENTS**

PROJECT NO: A0000  
DATE: DECEMBER 19, 2014  
DRAWN: JI, KL, RP  
CHECKED: RP, ED

SHEET TITLE:

LAYOUT & MATERIALS  
PLAN

**L132**

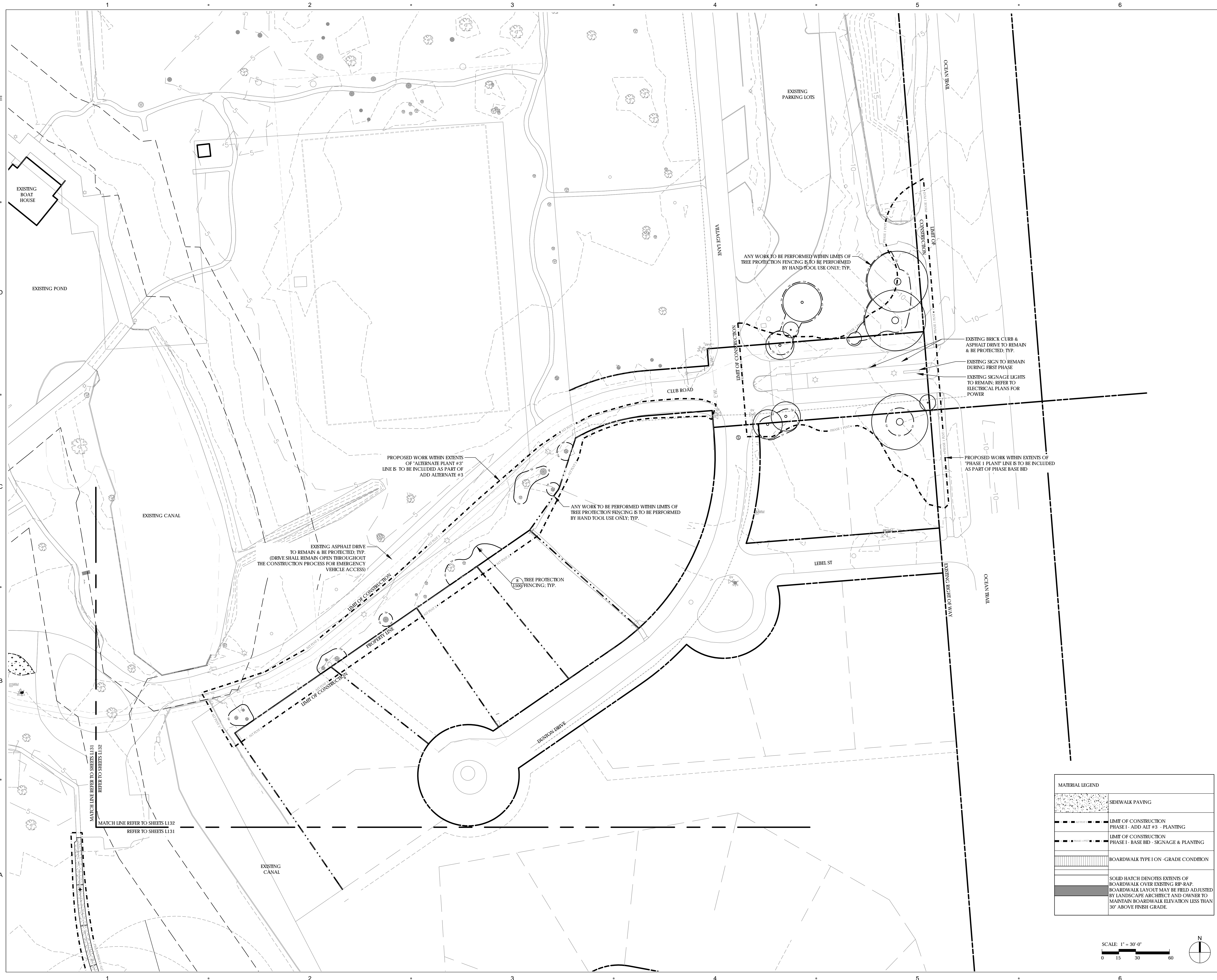

1  
2  
3  
4  
5  
6

A  
B  
C  
D  
E

EXISTING BOAT HOUSE

EXISTING POND

EXISTING CANAL

EXISTING ASPHALT DRIVE TO REMAIN & BE PROTECTED, TYP. (DRIVE SHALL REMAIN OPEN THROUGHOUT THE CONSTRUCTION PROCESS FOR EMERGENCY VEHICLE ACCESS)

PROPOSED WORK WITHIN EXTENTS OF 'ALTERNATE PLANT #3' LINE IS TO BE INCLUDED AS PART OF ADD ALTERNATE #3

ANY WORK TO BE PERFORMED WITHIN LIMITS OF TREE PROTECTION FENCING IS TO BE PERFORMED BY HAND TOOL USE ONLY, TYP.

TREE PROTECTION 1500' FENCING, TYP.

EXISTING BRICK CURB & ASPHALT DRIVE TO REMAIN & BE PROTECTED, TYP.

EXISTING SIGN TO REMAIN DURING FIRST PHASE

EXISTING SIGNAGE LIGHTS TO REMAIN. REFER TO ELECTRICAL PLANS FOR POWER

PROPOSED WORK WITHIN EXTENTS OF 'PHASE 1 PLANT' LINE IS TO BE INCLUDED AS PART OF PHASE BASE BID

EXISTING CANAL

EXISTING CANAL

MATCH LINE REFER TO SHEETS L131 REFER TO SHEETS L132

MATCH LINE REFER TO SHEETS L132 REFER TO SHEETS L131

EXISTING CANAL





CONSULTANTS

**PACE COLLABORATIVE PC.**  
1277 PERIMETER PKWY.  
VIRGINIA BEACH, VA 23454  
T: 757 499 7223

REGISTRATION

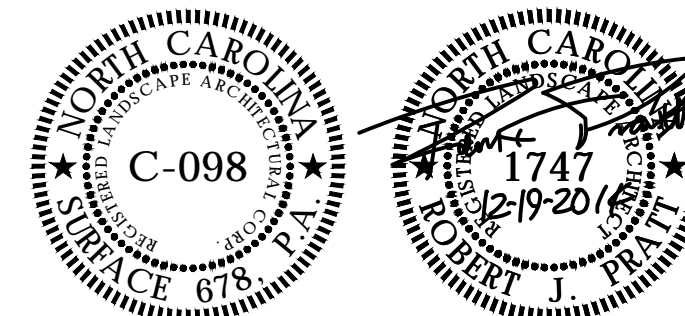

CLIENT



**WHALEHEAD CLUB**  
CLUB ROAD  
COROLLA, NC 27927

**CURRITUCK COUNTY**  
153 COURTHOUSE ROAD, SUITE 204  
CURRITUCK, NC 27929

**HISTORIC COROLLA PARK  
WHALEHEAD**

CLUB ROAD  
COROLLA, NC 27927

**LANDSCAPE & PEDESTRIAN  
IMPROVEMENTS - PHASE I**

NO.	REVISION	DATE
1	SITE PLAN RESUBMITTAL	10.16.14
2	BID FOR CONSTRUCTION	12.19.14

ISSUE:  
**CONSTRUCTION DOCUMENTS**

PROJECT NO: A0000  
DATE: DECEMBER 19, 2014  
DRAWN: JI, KL, RP  
CHECKED: RP, ED

SHEET TITLE:

GRADING PLAN

**L152**

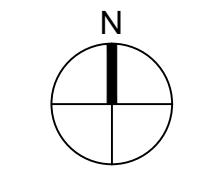
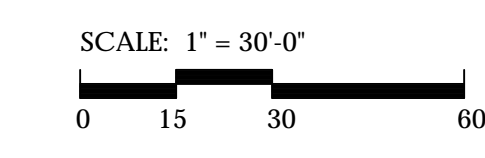
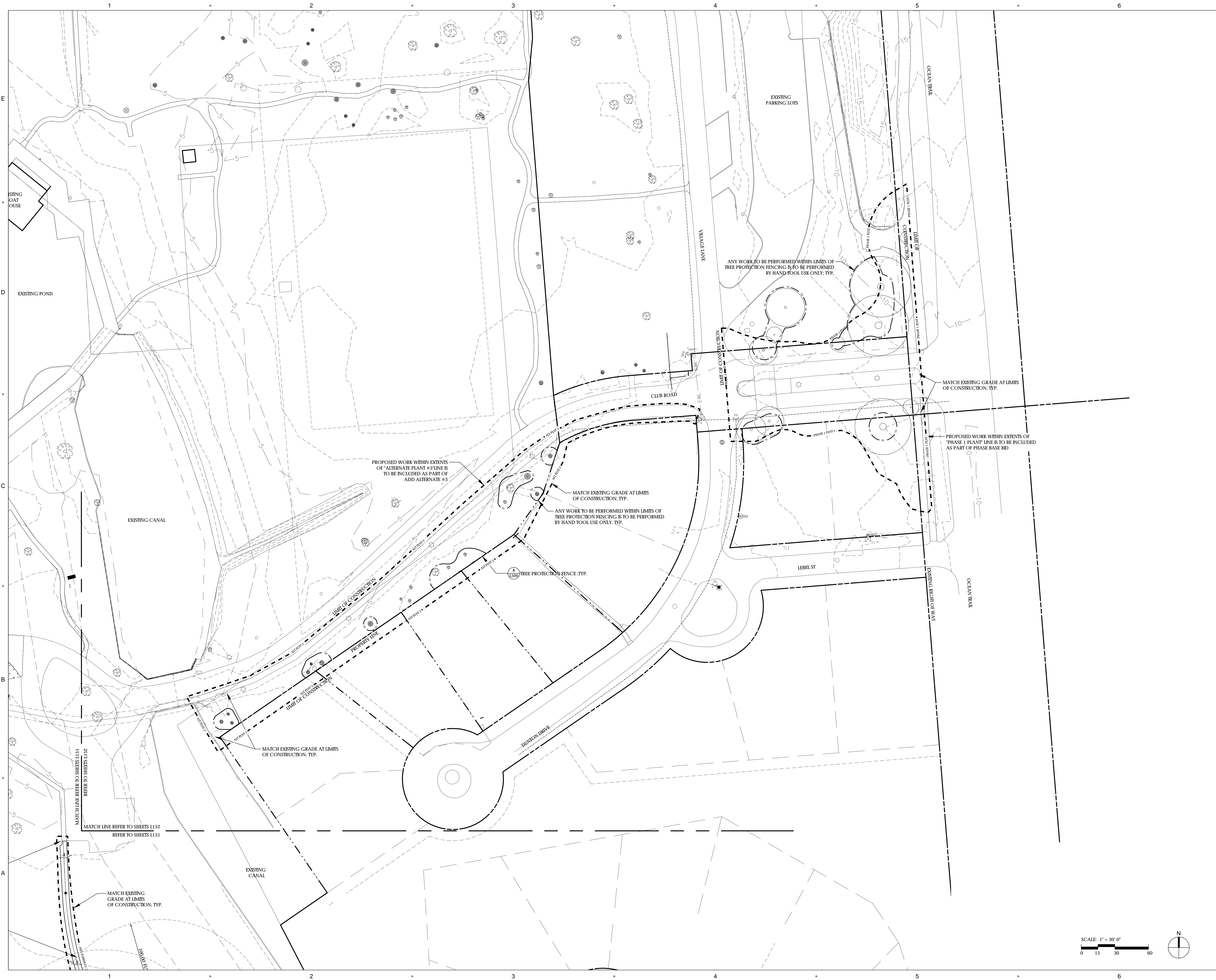





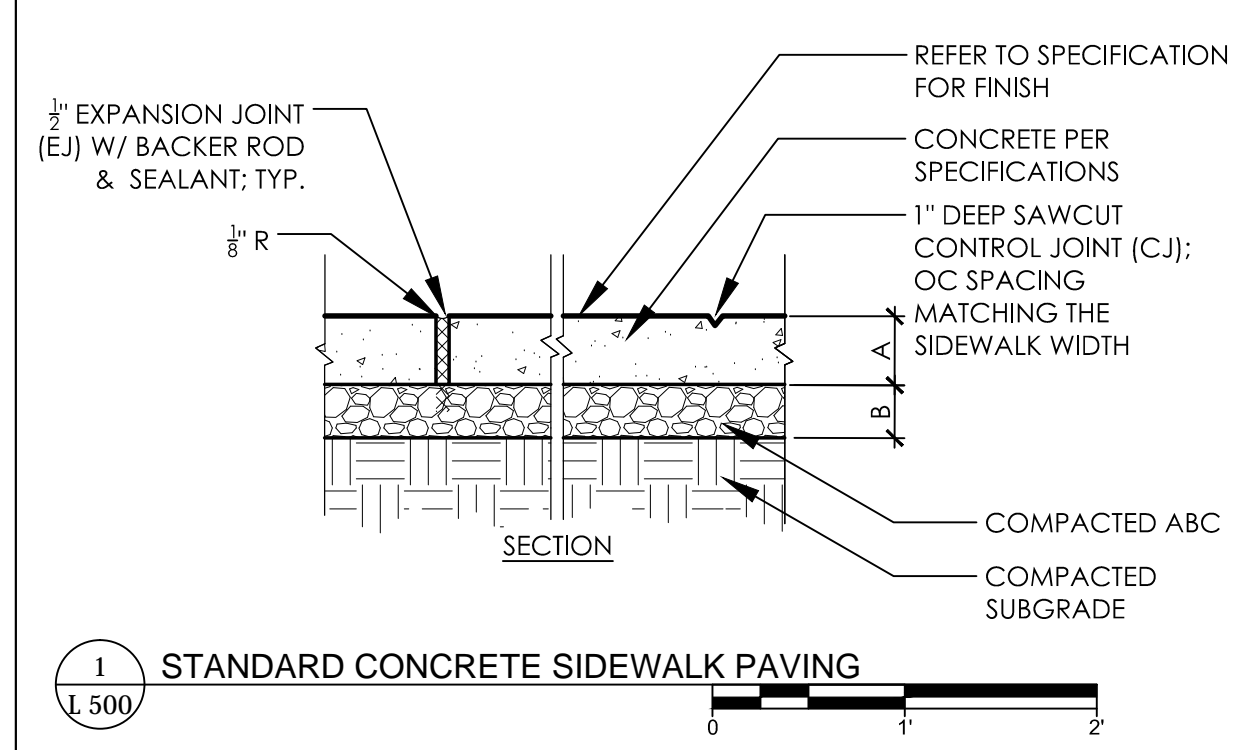

MATERIAL	DEPTH
A CONCRETE PER SPECIFICATIONS	4"
B COMPACTED ABC	4"

**CONCRETE NOTES:**  
 1. CONCRETE TO BE 3500 PSI MINIMUM COMPRESSIVE STRENGTH.  
 2. TESTING REQUIREMENTS FOR CONCRETE INCLUDE THE FOLLOWING:  
 a. OWNER WILL ENGAGE A TESTING AGENCY  
 b. CONTRACTOR IS REQUIRED TO SUBMIT MIX DESIGN FOR REVIEW AND APPROVAL PRIOR TO CONSTRUCTION  
 c. TEST WILL INCLUDE SLUMP, AIR CONTENT, COMPRESSIVE STRENGTH AND ARE TO BE PERFORMED AT A FREQUENCY OF 1 TEST FOR FIRST 20 YARDS AND 1 ADDITIONAL TEST FOR EACH ADDITIONAL 100 YARDS PER DAY OF DELIVERY AND INSTALL. COMPRESSIVE STRENGTH TESTS ARE TO TEST 1 CYLINDER FOR BREAK AT 7 DAYS; THEN TEST 2 CYLINDERS AT 28 DAYS. A 28 DAY BREAK MUST MEET OR EXCEED MINIMUM DESIGN COMPRESSIVE STRENGTH.  
 3. SEE SPECIFICATIONS FOR FULL REQUIREMENTS

CONCRETE FINISHING SCHEDULE					
TYPE	CONTRACT BID	PAVING DESCRIPTION	COLOR	FINISH	FINISH
TYPE A	BASE BID	SEEDED SHELL AGGREGATE (TO MATCH EXISTING)	STANDARD GRAY	ROLLED & SEEDED	STANDARD AGGREGATE W/ BROKEN SHELLS SEEDED ON SURFACE
TYPE B	ALTERNATE 4	COURSE ROCK SALT FINISH	STANDARD GRAY	SALT OR SALT ROLLED	STANDARD AGGREGATE W/ ROCK SALT SEEDED ON SURFACE
TYPE C	ALTERNATE 5	BROOM SWEEP FINISH	STANDARD GRAY	MEDIUM BROOM	STANDARD AGGREGATE

\*NOTE: CONTRACTOR IS TO PROVIDE UNIT PRICES PER CONTRACT FOR BOTH BASE BID AND ALTERNATE CONCRETE TYPES



1A CONCRETE TYPE A / SEEDED SHELL AGGREGATE



1B CONCRETE TYPE B / ROCK SALT

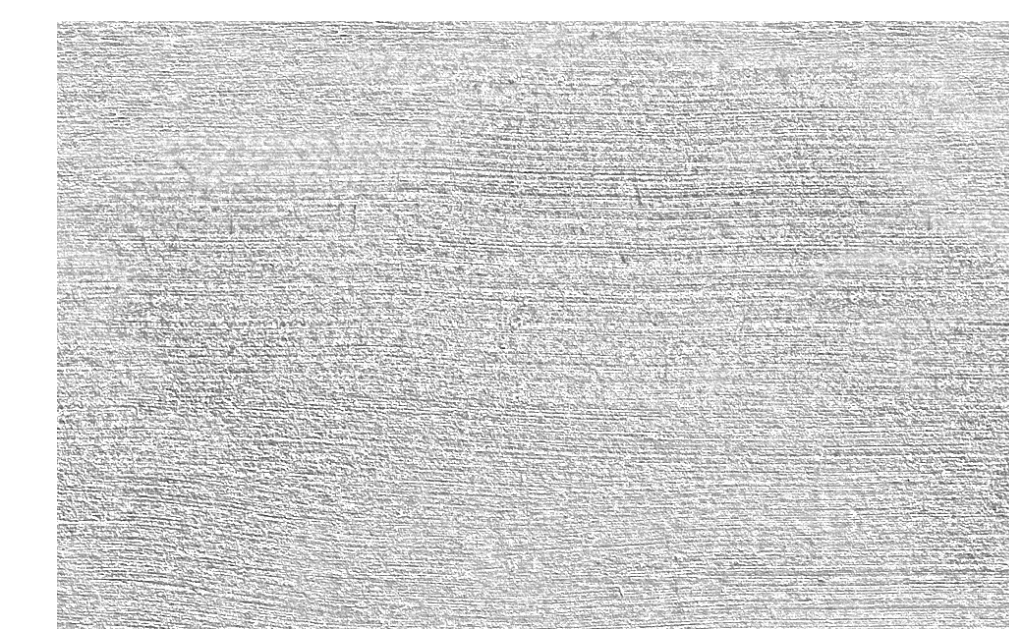

1C CONCRETE TYPE C / BROOM SWEEP

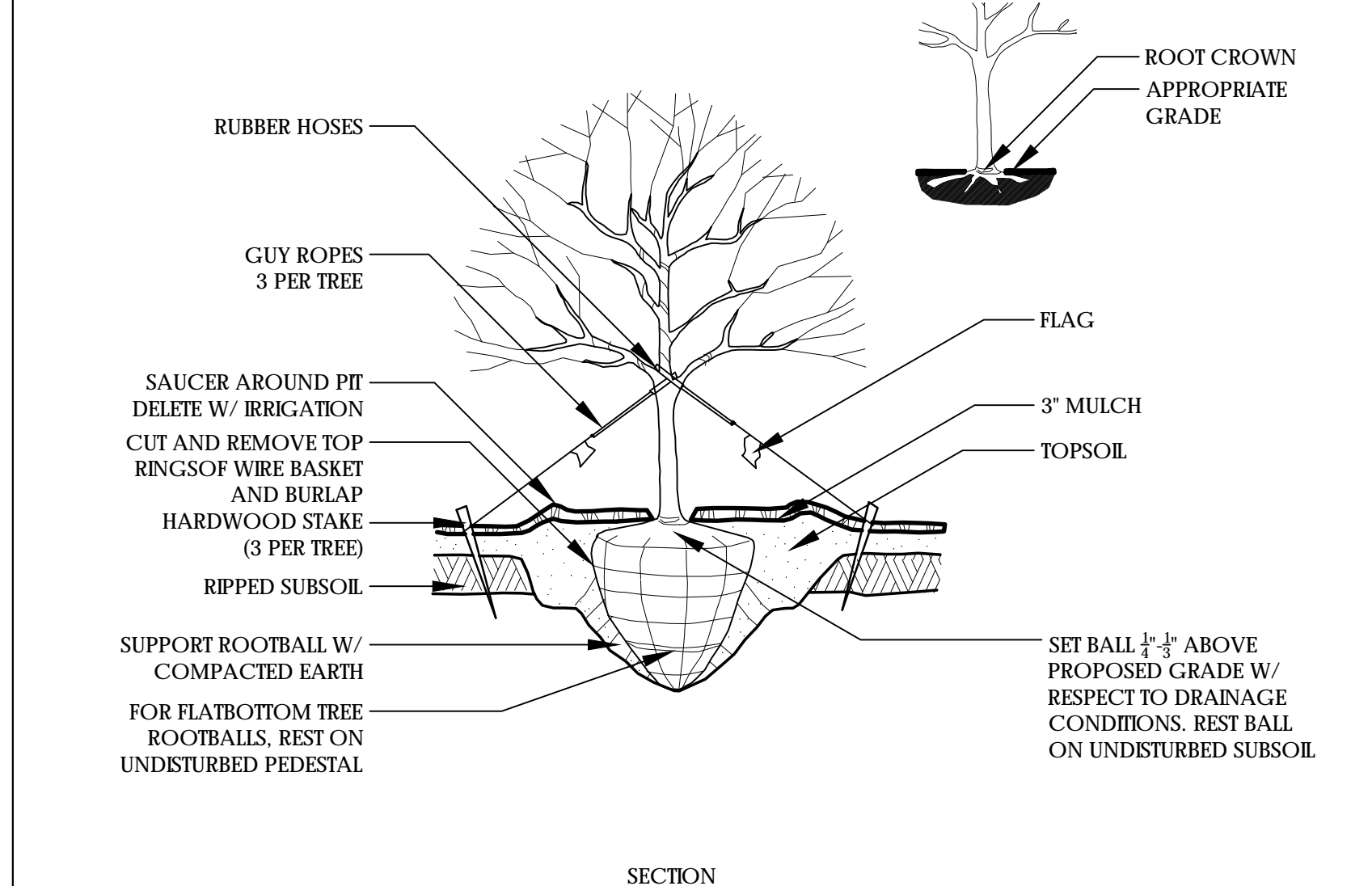

2 RAISED TREE PLANTING SCALE: NTS

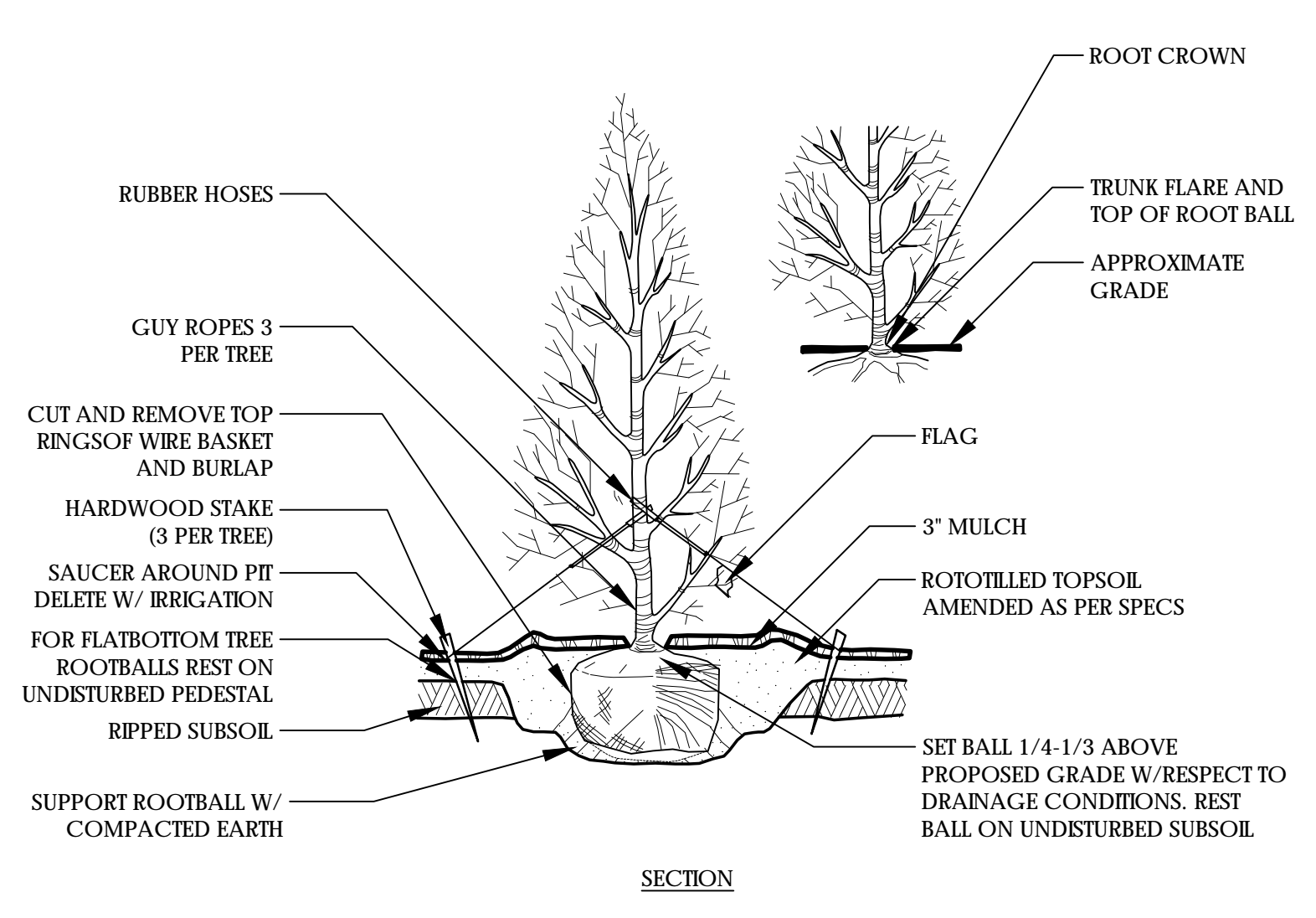

3 EVERGREEN TREE PLANTING SCALE: NTS

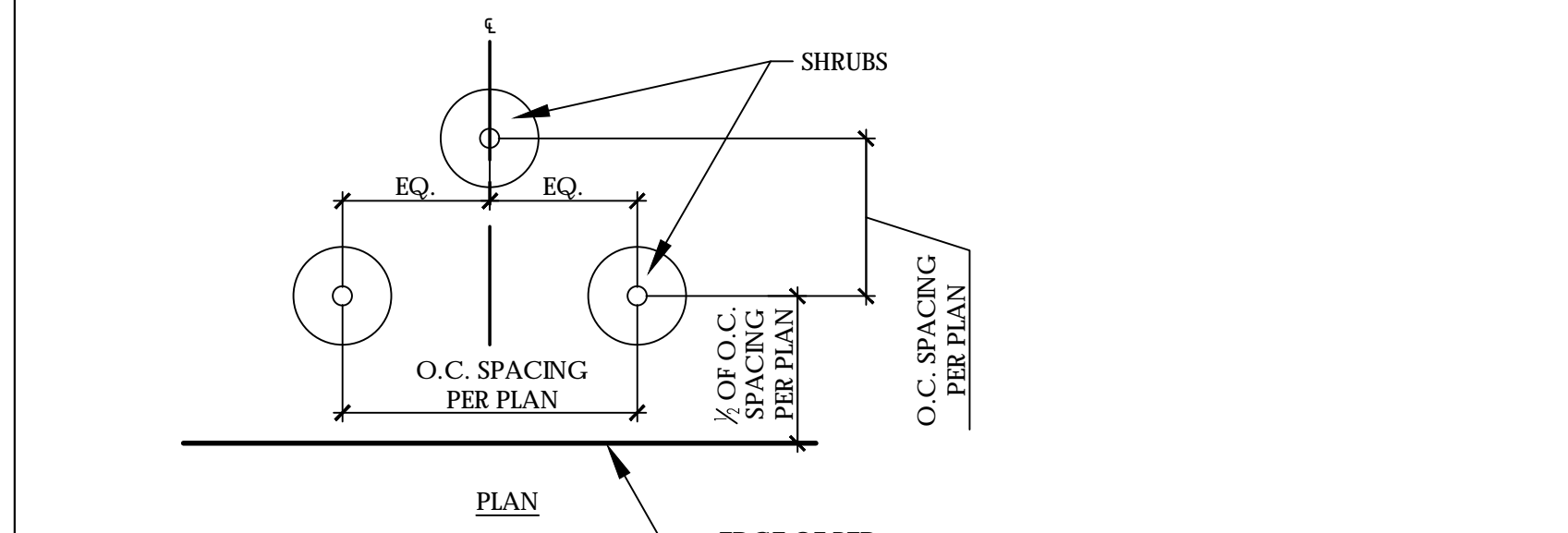

4 RAISED SHRUB PLANTING SCALE: NTS

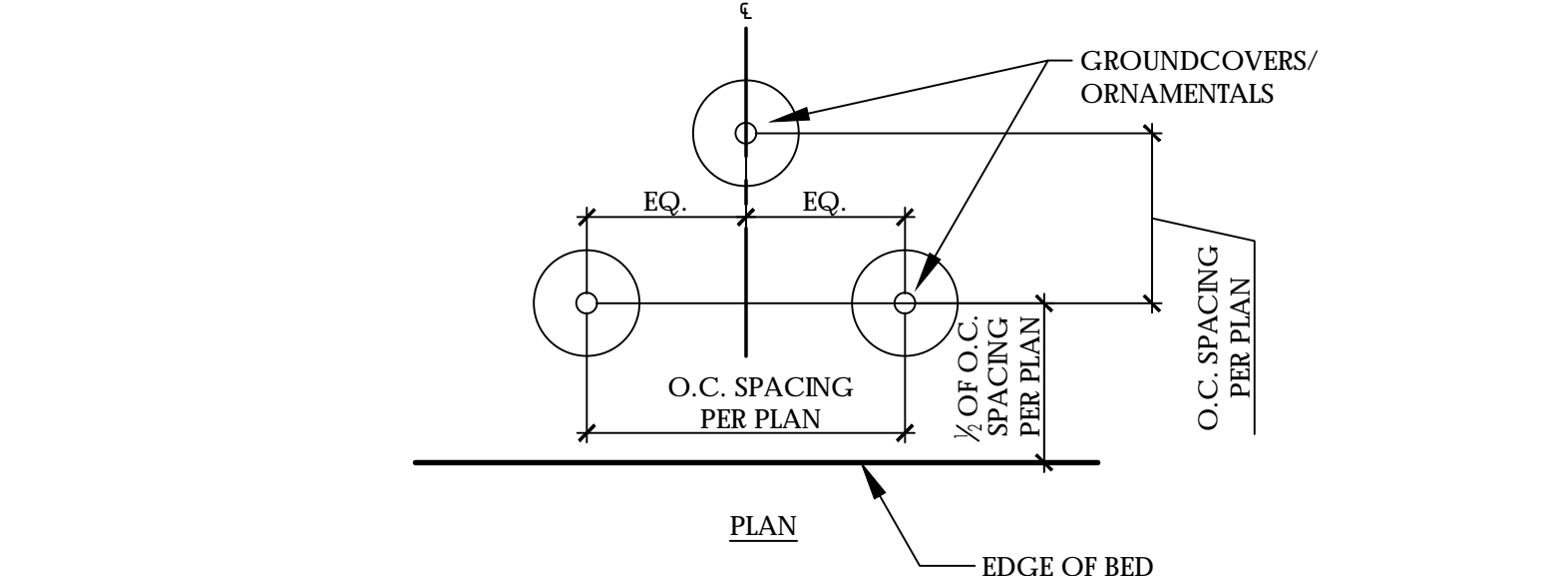

5 GROUNDCOVER PLANTING SCALE: NTS

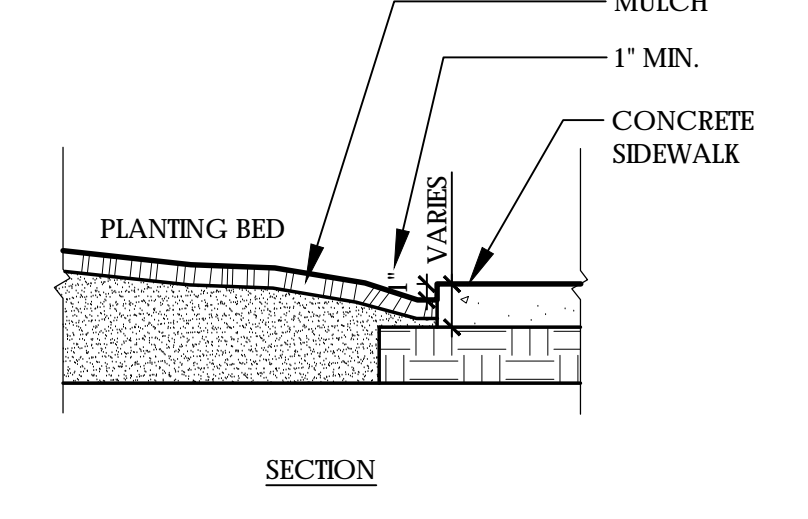

6 CONCRETE/ PLANT BED EDGE

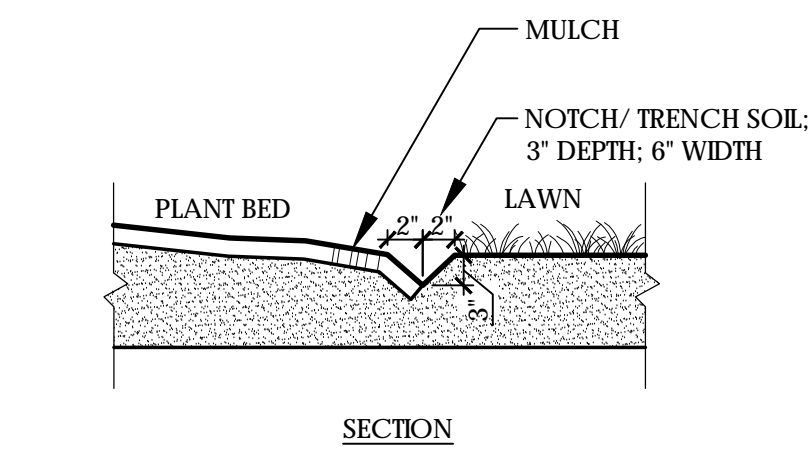

7 LAWN/ PLANT BED EDGE

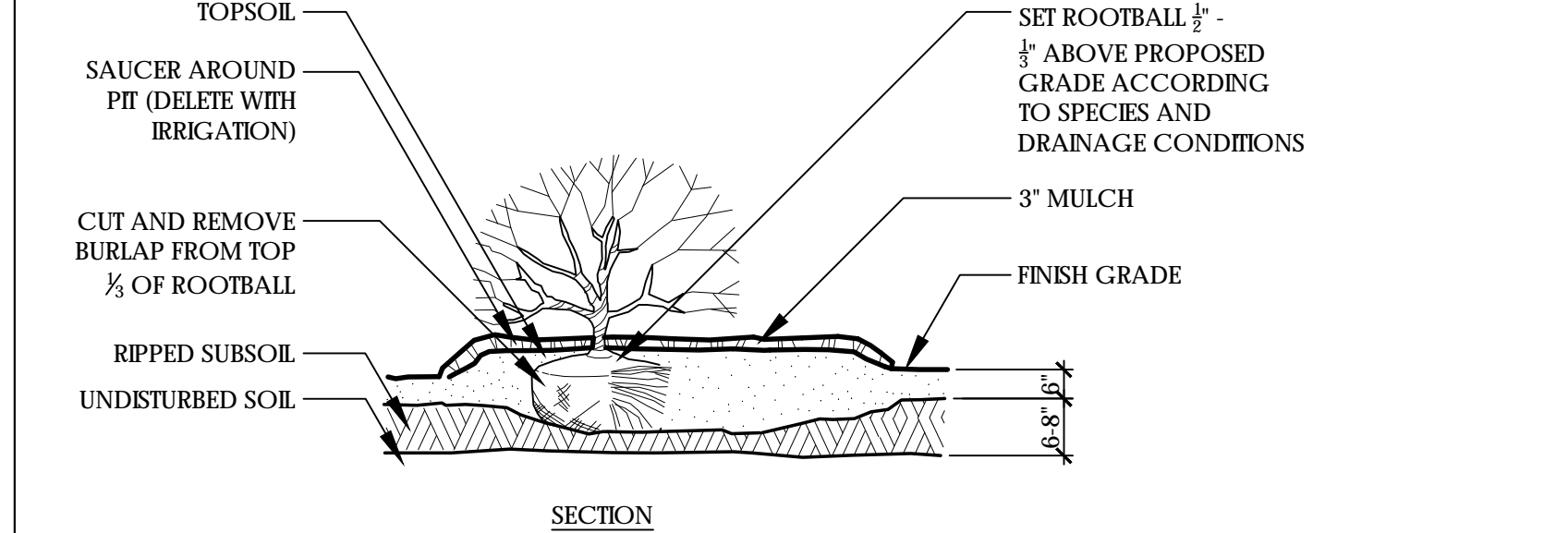

4 RAISED SHRUB PLANTING SCALE: NTS

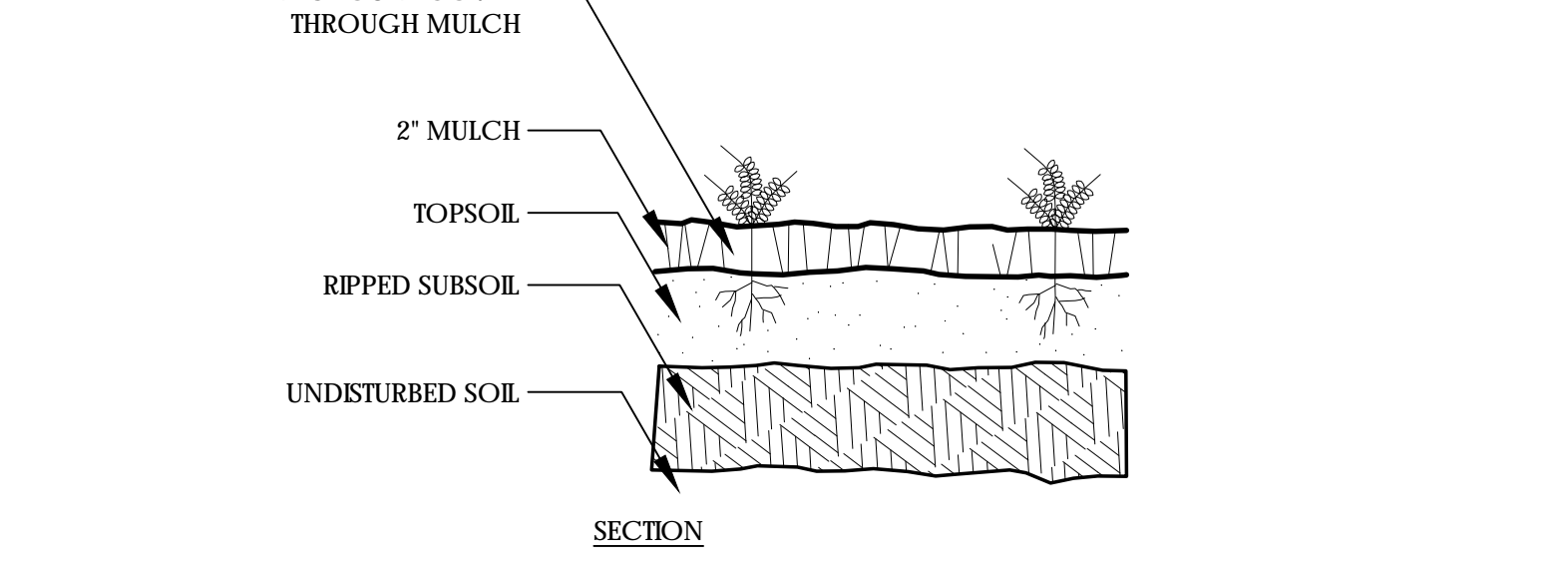

5 GROUNDCOVER PLANTING SCALE: NTS

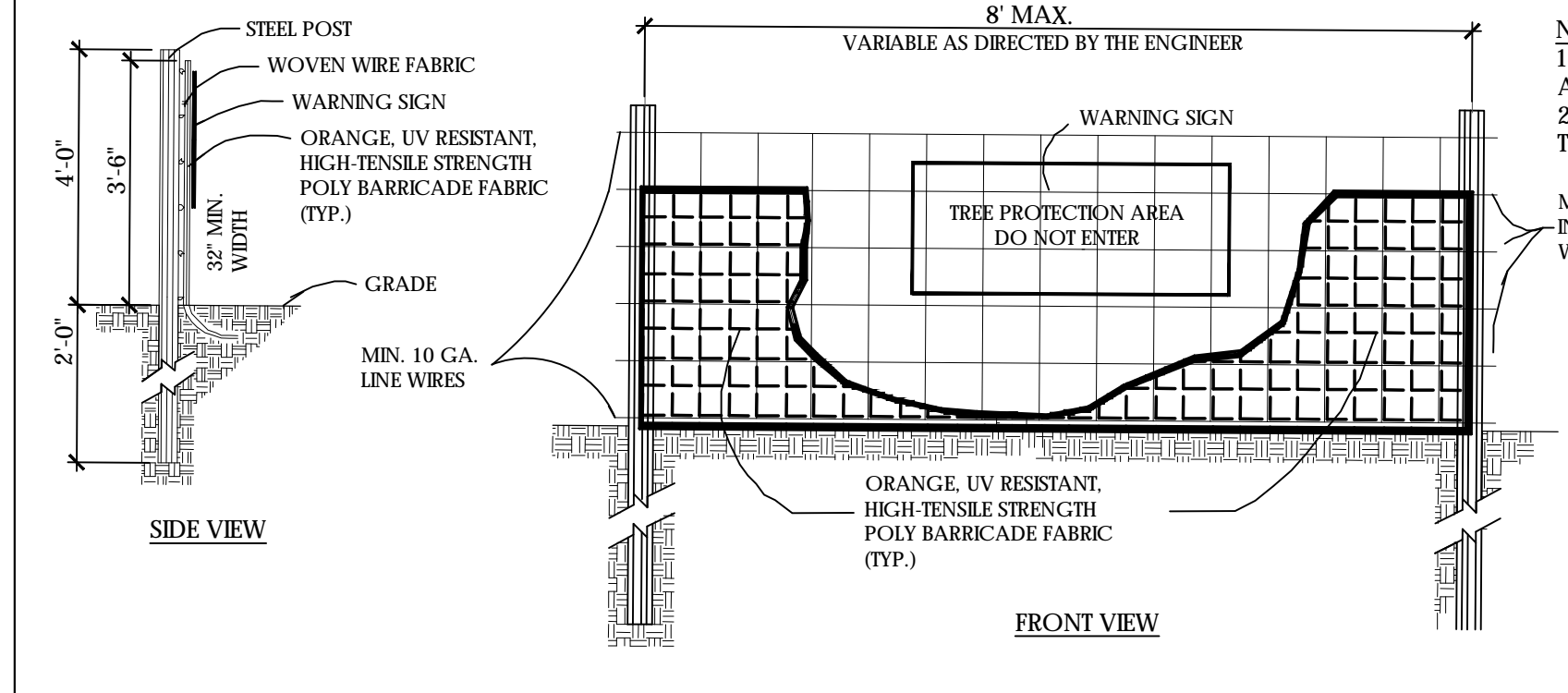

8 TREE PROTECTION FENCE NOTE: FOR TREE PROTECTION ONLY SCALE: NTS

**NOTES:**  
 1) PRIOR TO BEGINNING DEMOLITION ACTIVITIES, THE CONTRACTOR SHALL ERECT TREE PROTECTION FENCING AROUND ALL TREES DESIGNED TO REMAIN. THE PROTECTED GROUND AREA SHALL BE INDICATED ON THE PLANS.  
 2) NO CONSTRUCTION ACTIVITY OR STORAGE OF MATERIALS WILL BE ALLOWED IN THE PROTECTION GROUND AREA. TREE PROTECTION FENCING SHALL REMAIN IN PLACE THROUGHOUT CONSTRUCTION.

**NOTES:**  
 1. WARNING SIGNS TO BE MADE OF DURABLE WEATHERPROOF MATERIAL.  
 2. LETTERS TO BE 3" HIGH MIN. CLEARLY LEGIBLE AND SPACED AS DETAILED.  
 3. SIGNS SHALL BE PLACED AT 50' MAX INTERVALS.  
 4. PLACE A SIGN AT EACH END OF LINEAR TREE PROTECTION AND 50' ON CENTER THEREAFTER.  
 5. FOR TREE PROTECTION AREAS LESS THAN 200' IN PERIMETER, PROVIDE NO LESS THAN ONE SIGN PER PROTECTION AREA.  
 6. ATTACH SIGNS SECURELY TO FENCE POST AND FABRIC.  
 7. MAINTAIN TREE PROTECTION FENCE THROUGHOUT DURATION OF PROJECT.  
 8. ADDITIONAL SIGNS MAY BE REQUIRED BY CURRITUCK COUNTY INSPECTIONS DEPARTMENT BASED ON ACTUAL FIELD CONDITIONS.

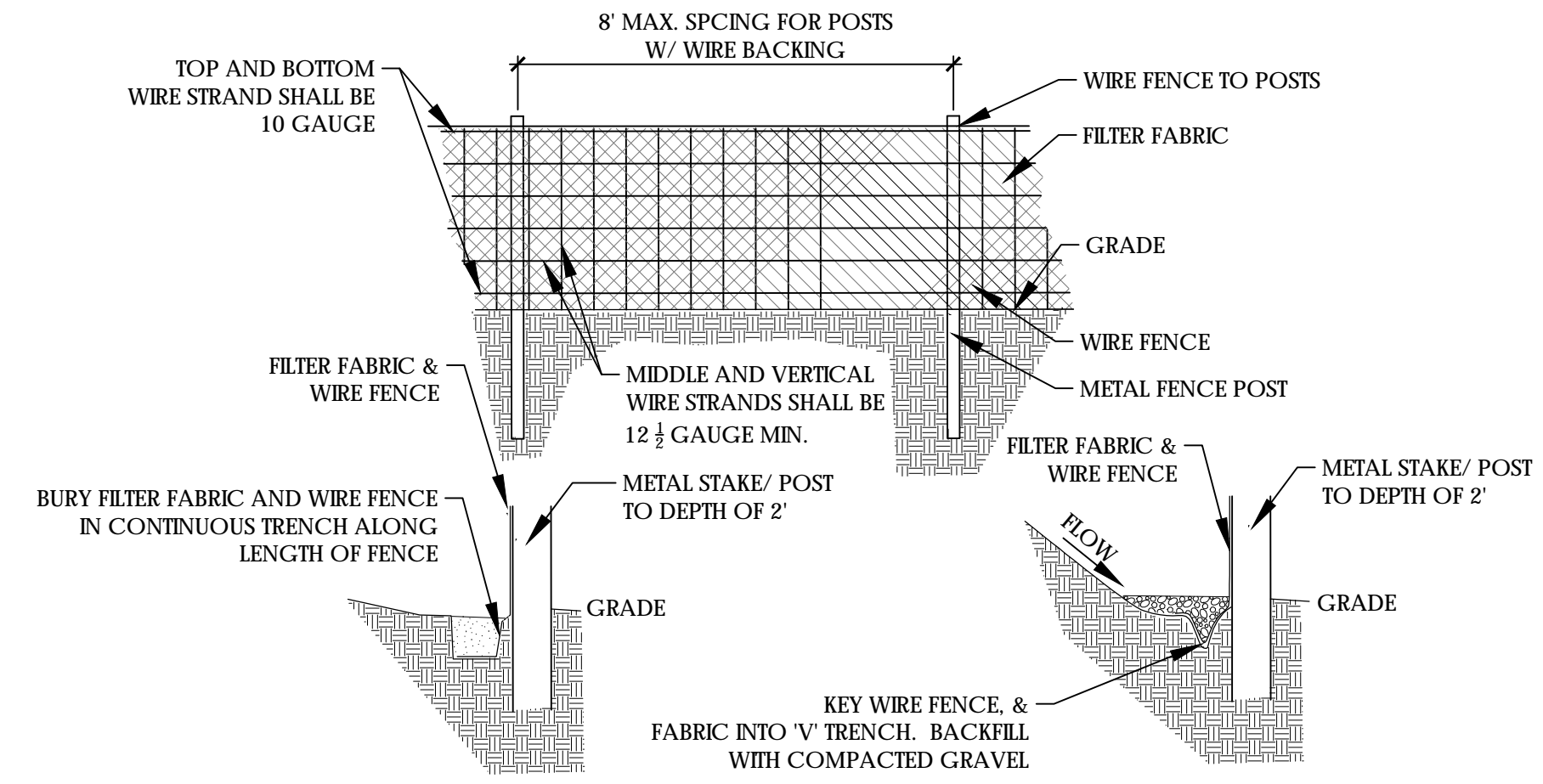

9 SILT PROTECTION FENCE NOTE: FOR SILT PROTECTION FENCE ONLY SCALE: NTS

**NOTES:**  
 1. USE A WIRE MINIMUM OF 32" IN HEIGHT AND WITH A MINIMUM OF 6 LINE WIRES WITH 12" SPACING.  
 2. USE FILTER FABRIC WITH A MINIMUM OF 36" HEIGHT AND FASTEN ADEQUATELY TO WIRE.  
 3. USE S-U SELF-FASTENER ANGLE STEEL POSTS.

**MAINTENANCE NOTES:**  
 1. USE SILT FENCE ONLY WHEN DRAINAGE AREA DOES NOT EXCEED 1/2 ACRE AND NEVER IN AREAS OF CONCENTRATED FLOW.  
 2. REMOVE SEDIMENT DEPOSITED AS NEEDED TO PROVIDE STORAGE VOLUME FOR THE NEXT RAIN AND TO REMOVE PRESSURE ON THE SILT FENCE.

Surface 678, P.A.  
 215 Morris Street, Suite 150  
 Durham, NC 27701  
 www.surface678.com  
 p: 919-416-1199  
 f: 919-416-1662

CONSULTANTS

**PACE COLLABORATIVE PC.**  
 1277 PERIMETER PKWY.  
 VIRGINIA BEACH, VA 23454  
 T: 757 499 7223

REGISTRATION

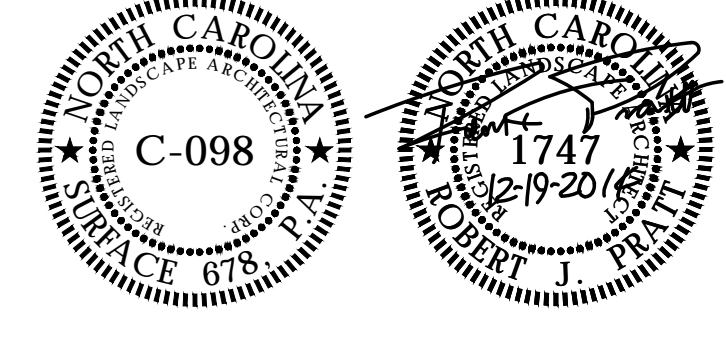

CLIENT



**WHALEHEAD CLUB**  
 CLUB ROAD  
 COROLLA, NC 27927

**CURRITUCK COUNTY**  
 153 COURTHOUSE ROAD, SUITE 204  
 CURRITUCK, NC 27929

HISTORIC COROLLA PARK  
 WHALEHEAD

CLUB ROAD  
 COROLLA, NC 27927

LANDSCAPE & PEDESTRIAN  
 IMPROVEMENTS - PHASE I

NO.	REVISION	DATE
1	SITE PLAN RESUBMITTAL	10.16.14
2	BID FOR CONSTRUCTION	12.19.14

ISSUE:  
**CONSTRUCTION DOCUMENTS**

PROJECT NO: A0000  
 DATE: DECEMBER 19, 2014  
 DRAWN: JI, KL, RP  
 CHECKED: RP, ED

SHEET TITLE:

## CONSULTANTS

**PACE COLLABORATIVE PC.**  
1277 PERIMETER PKWY.  
VIRGINIA BEACH, VA 23454  
T: 757 499 7223

## REGISTRATION

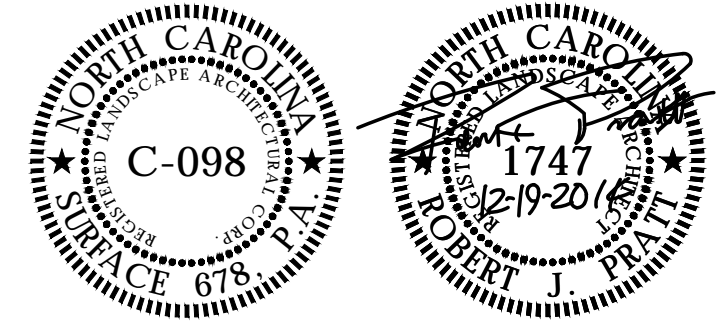

## CLIENT



**WHALEHEAD CLUB**  
CLUB ROAD  
COROLLA, NC 27927

**CURRITUCK COUNTY**  
153 COURTHOUSE ROAD, SUITE 204  
CURRITUCK, NC 27929

**HISTORIC COROLLA PARK**  
WHALEHEAD

CLUB ROAD  
COROLLA, NC 27927

**LANDSCAPE & PEDESTRIAN**  
IMPROVEMENTS - PHASE I

NO.	REVISION	DATE
1	SITE PLAN RESUBMITTAL	10.16.14
2	BID FOR CONSTRUCTION	12.19.14

## ISSUE: CONSTRUCTION DOCUMENTS

PROJECT NO: A0000  
DATE: DECEMBER 19, 2014  
DRAWN: JI, KL, RP  
CHECKED: RP, ED

SHEET TITLE:

DETAILS

L501

**NOTES:**  
1) ALL PRESSURE TREATED LUMBER IS TO HAVE THE AWPA UC5B IMMERSION WITH 2.50 PCF PRESERVATIVE RETENTION FOR USE IN SALT AND BRACKISH WATER.  
2) ALL FASTENERS ARE TO BE GALVANIZED G85 (Z550) COATING, TYP. FOR ALL CARRIAGE AND OR OTHER ANCHOR BOLTS USED ON BOARDWALK CONSTRUCTION.

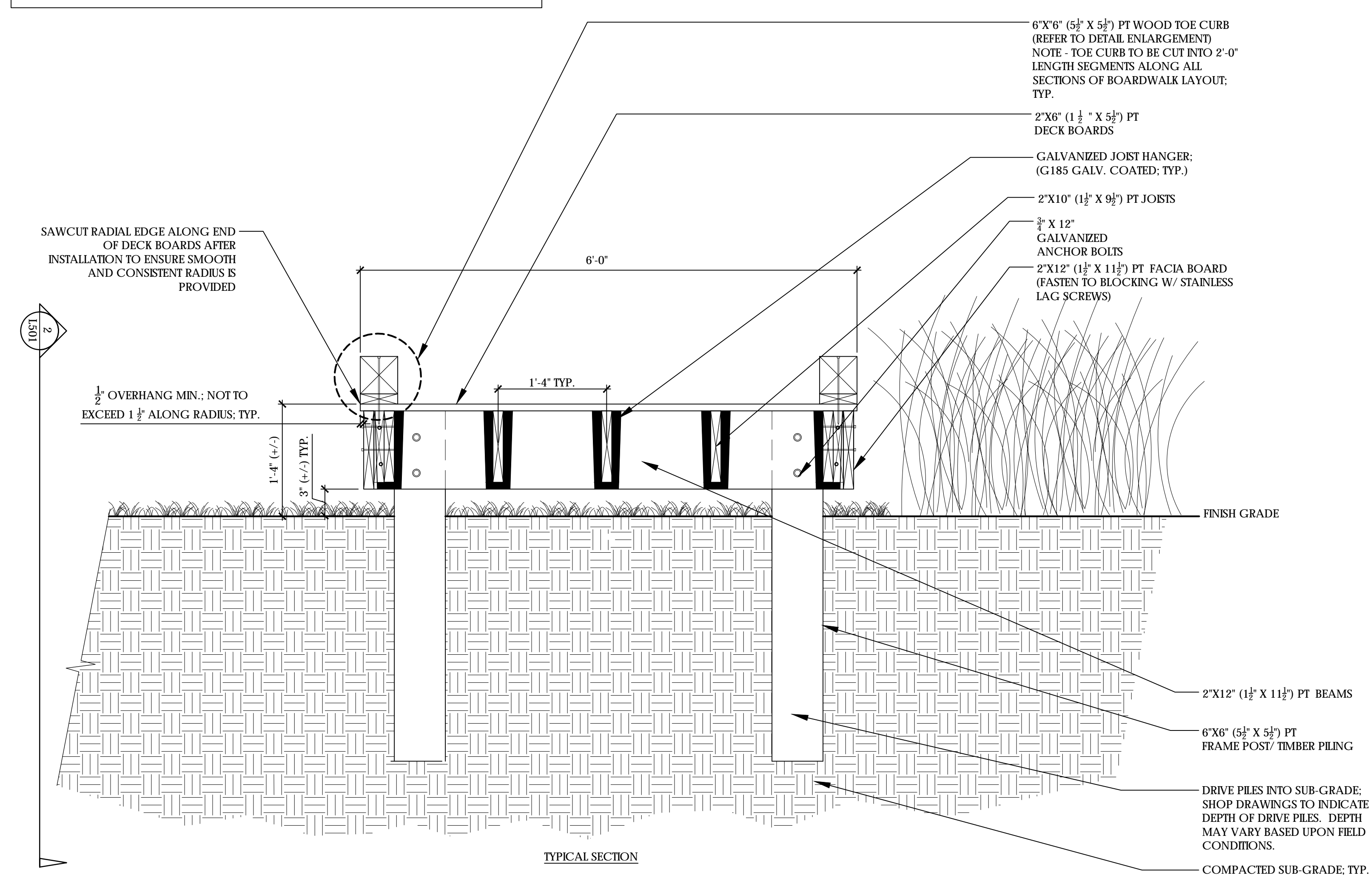

TYPICAL SECTION

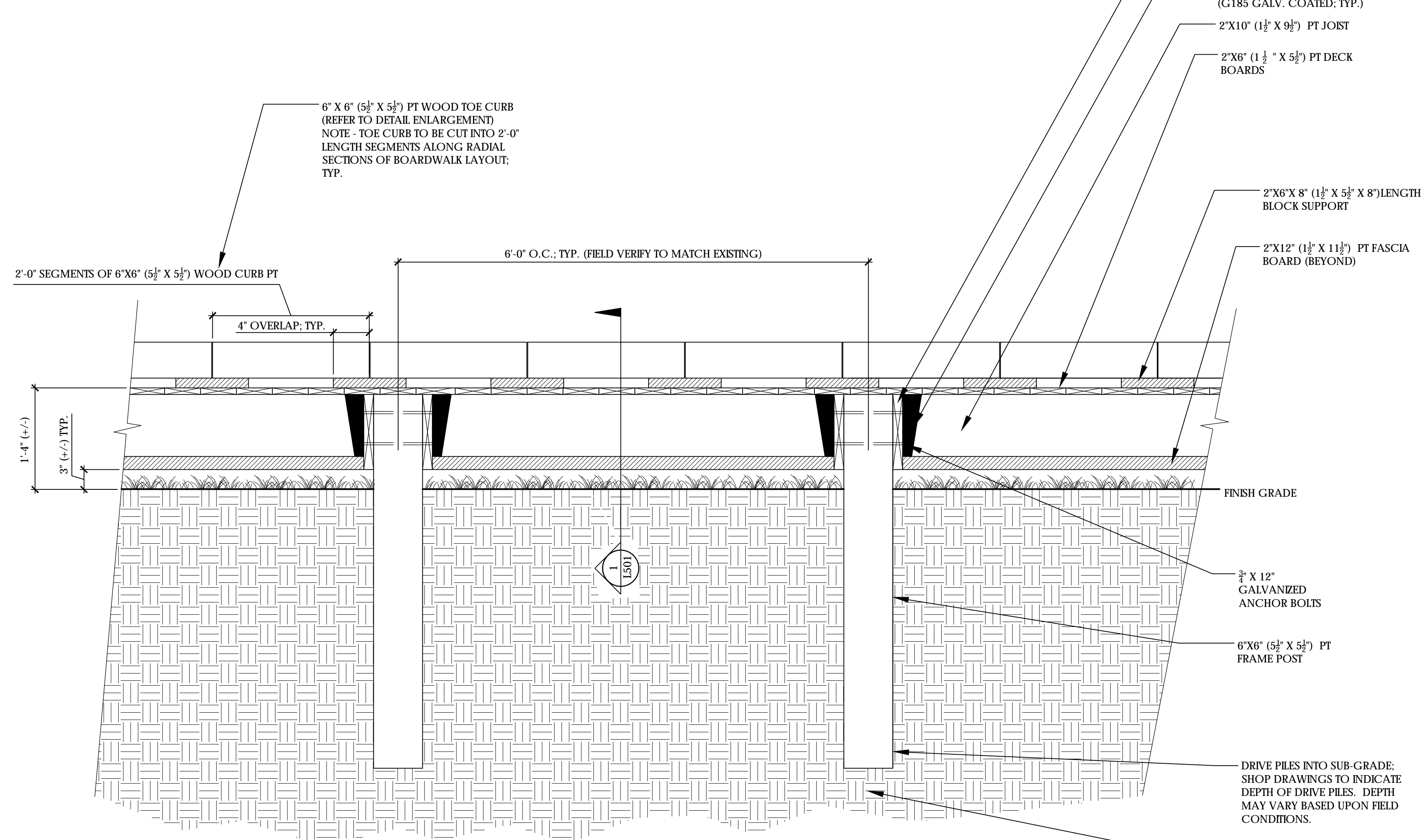

TYPICAL ELEVATION

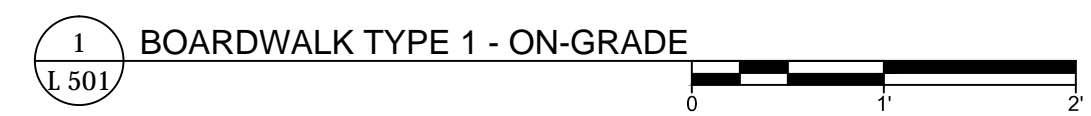

1 BOARDWALK TYPE 1 - ON-GRADE  
1/501



2 BOARDWALK TYPE 1 - ELEVATION  
1/501

\* CONTRACTOR IS TO PROVIDE SHOP DRAWINGS, SIGNED & SEALED BY A STRUCTURAL ENGINEER LICENSED IN THE STATE OF NC. FOR REVIEW & APPROVAL BY OWNER & LANDSCAPE ARCHITECT FOR ALL BOARDWALKS FOR REVIEW PRIOR TO CONSTRUCTION OR INSTALLATION.

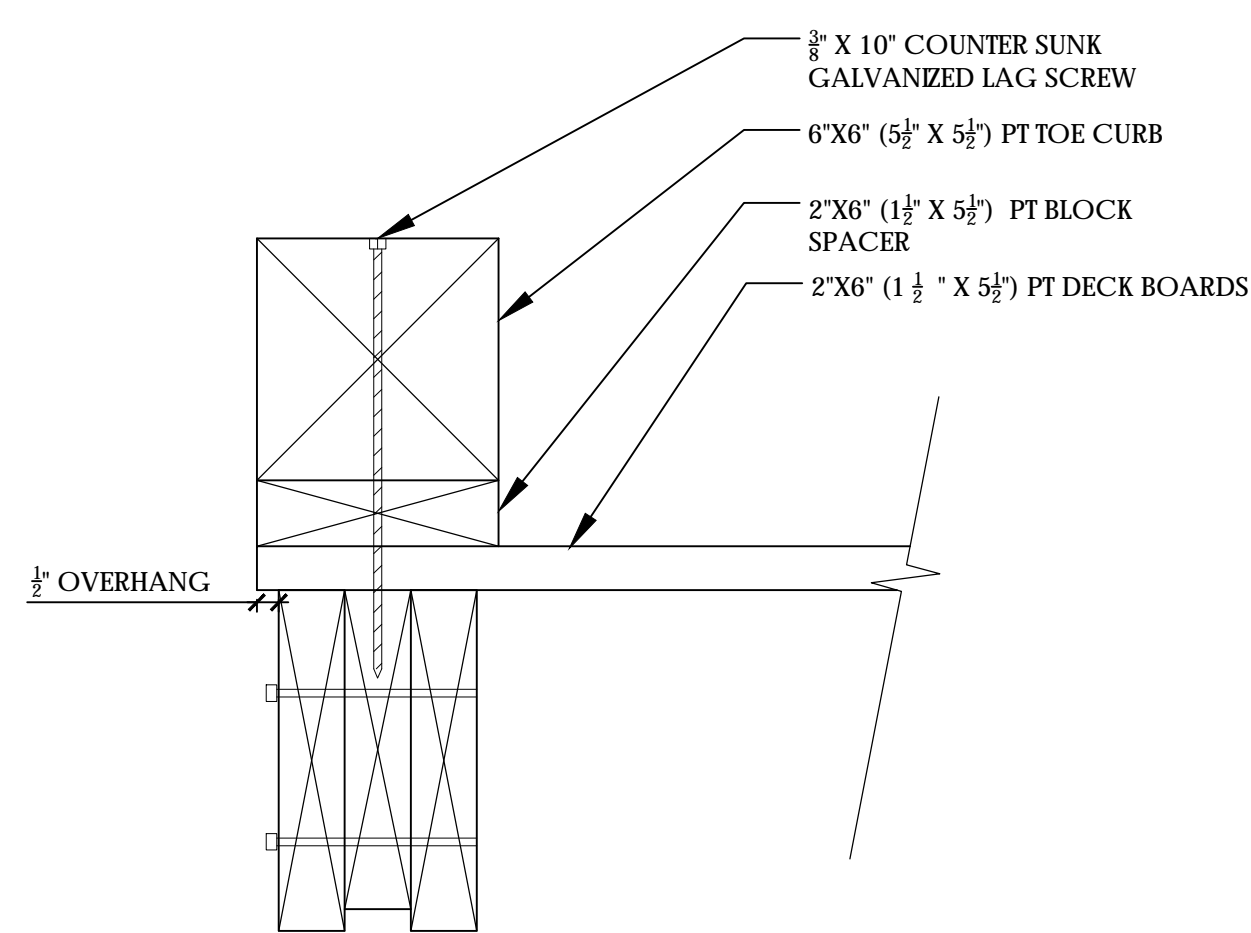

CONDITION AT BLOCK SUPPORT ENLARGEMENT  
NTS

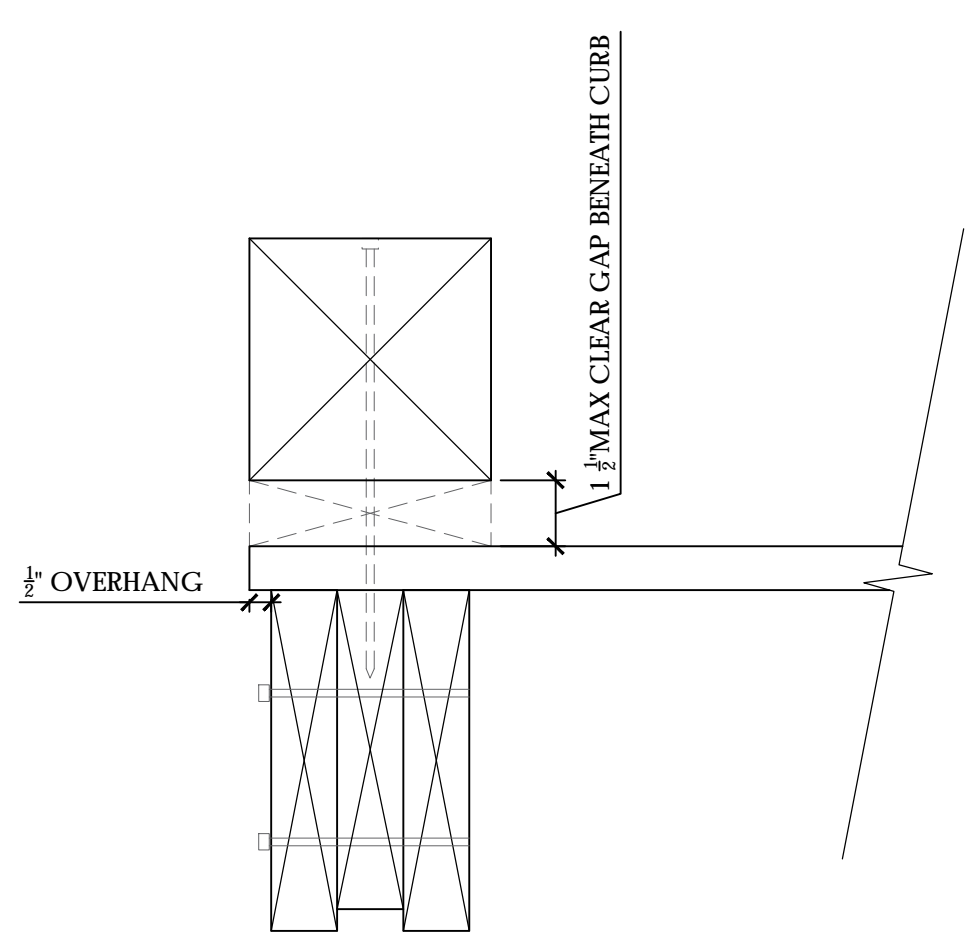

CONDITION AT 1 1/2" GAP ENLARGEMENT  
NTS

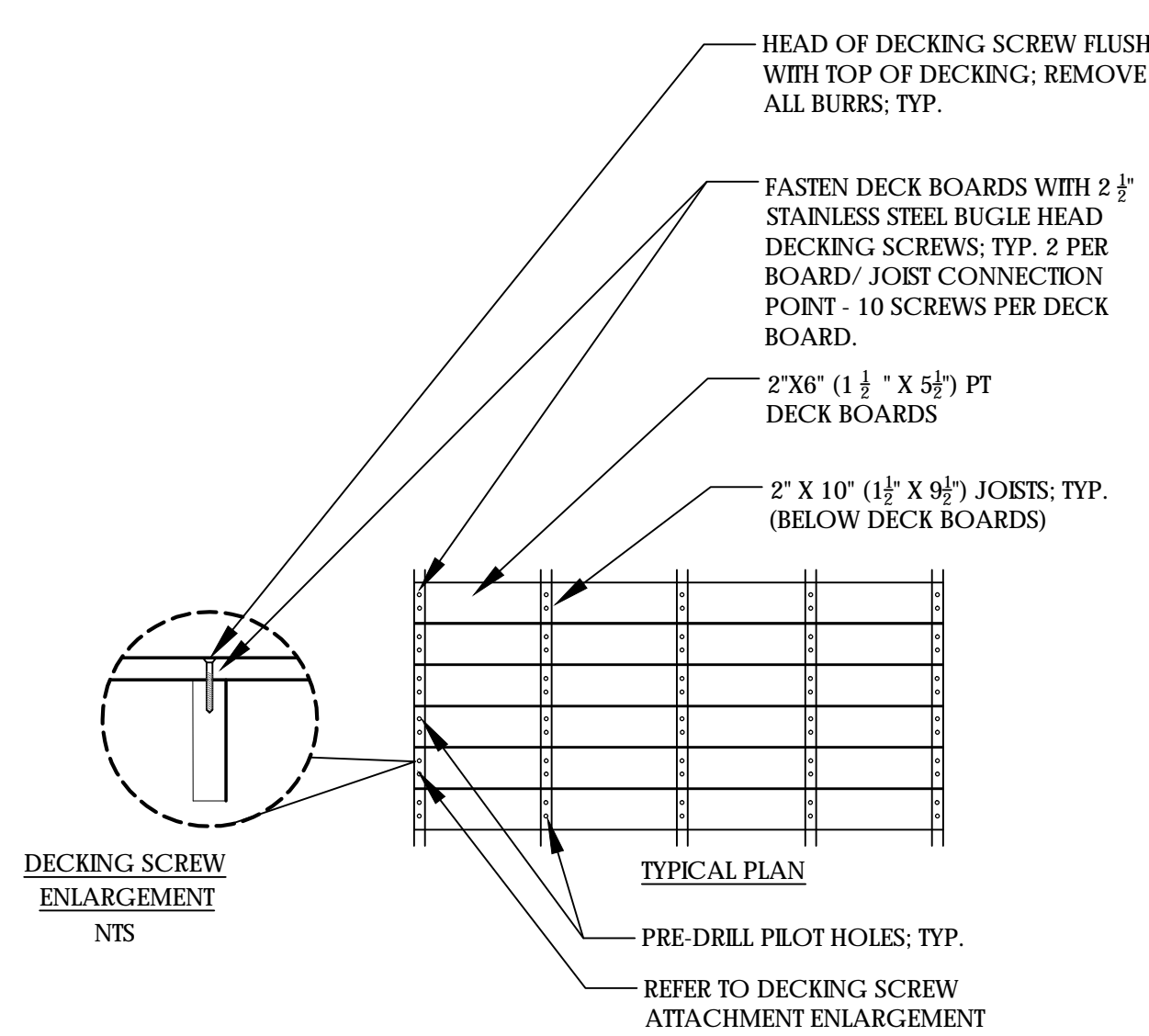

3 BOARDWALK DECKING DETAIL  
1/501

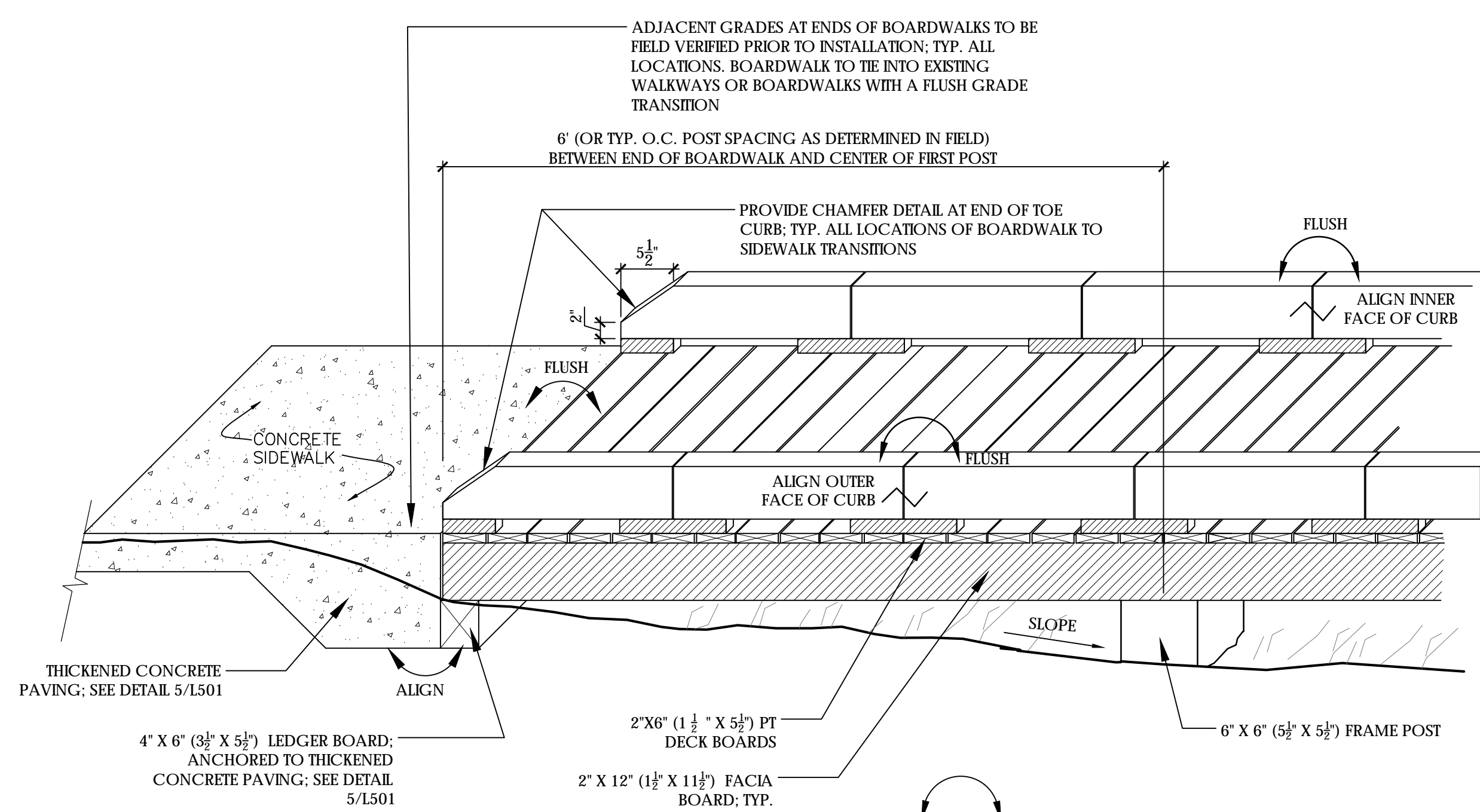

4 BOARDWALK/ SIDEWALK HEADER ATTACHMENT DETAIL  
1/501

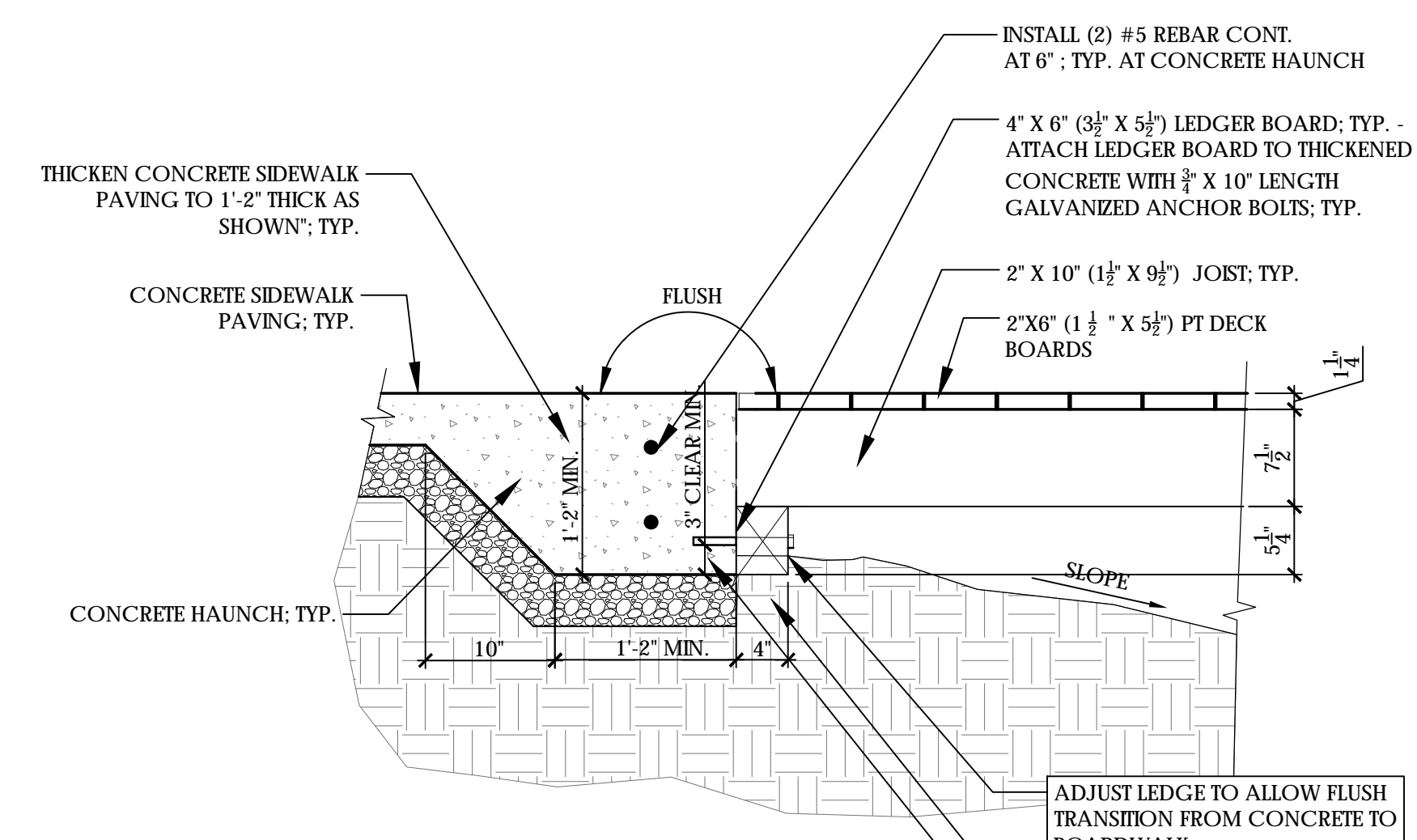

5 BOARDWALK/ SIDEWALK HEADER ATTACHMENT DETAIL  
1/501

\* CONTRACTOR IS TO PROVIDE SHOP DRAWINGS, SIGNED & SEALED BY A STRUCTURAL ENGINEER LICENSED IN THE STATE OF NC. FOR ALL BOARDWALKS FOR REVIEW PRIOR TO CONSTRUCTION OR INSTALLATION.



## ELECTRICAL SPECIFICATIONS

### SECTION 16010 – GENERAL PROVISIONS

#### PART 1 – GENERAL

1.1 Codes and standards – the latest effective publications of all applicable standards, codes, etc., as they apply, form part of these specifications as if were written fully herein and constitute minimum requirements. The following will be referred to throughout in abbreviated forms.

- A. National Electrical Code, (NFPA 70) (NEC).
- B. Institute of Electrical and Electronic Engineers (IEEE).
- C. National Electrical Manufacturer's Association (NEMA).
- D. American National Standards Institute (ANSI).
- E. Applicable local codes.
- F. Underwriter's Laboratories, Inc. (UL).
- G. National Fire Protection Association (NFPA).
- H. North Carolina Building Code

1.2 Scope of work – provide all work required for this division including all labor, materials, equipment, appurtenances and services to provide complete electrical systems as shown on the drawings and specified in this division of the specifications. The word "provide" shall mean "furnish and install complete and ready for use".

1.3 The Contractor shall visit the site prior to bid to determine the extent of the work. Lack of knowledge of existing conditions will not be considered a basis for change orders.

1.4 Drawings and specifications – the drawings are diagrammatic and indicate the general extent, character and arrangement of equipment, fixtures and conduit and wiring systems. It is the intention of these specifications and drawings to fully cover all work and materials for a complete, first class electrical installation, and any devices such as pull boxes and disconnect switches, usually employed in this class of work, though not specifically mentioned or shown on the drawings or in this specification, but which may be necessary for the satisfactory completion of the work, shall be furnished and installed by the Contractor as a part of his total work under this Division. Consult the specifications and drawings of all other trades and perform all electrical work required therein. Cooperate with all other Contractors or Subcontractors to furnish complete workable systems.

1.5 During construction, keep an accurate record of all deviations between the work as shown on the contract drawings and that which is actually installed on a set of blue line prints of the electrical drawings, and note changes thereon with red marks, in a neat and accurate manner. When all revisions have been shown on these prints to indicate the work as finally installed, the prints shall be delivered to the Owner, before final payment.

1.6 Permits, inspection and tests – the right is reserved to inspect and test any portion of the installation/equipment during the progress of its erection. This Contractor shall test all wiring for continuity and grounds before connecting any fixtures or devices. This Contractor shall test the entire system when the work is finally completed to insure that all portions are free from short circuits and grounds.

1.7 Secure and pay for all required permits and inspections. Inspection certificates from local authorities having jurisdiction shall be delivered to the Owner before final payment.

1.8 Submittals – submit shop drawings, product data and samples within thirty (30) days of award of contract and in accordance with the general conditions and supplementary conditions. Submittals are required for all items provided under this specification. Review of submittals by the Engineer and any associated action taken by the Engineer does not relieve the Contractor of any requirements set forth by the contract documents.

#### PART 2 – PRODUCTS

2.1 Manufacturing standards – materials shall be new and approved and labeled by UL wherever standards have been established by that agency. Defective equipment or equipment damaged in the course of installation or test shall be replaced or repaired in a manner meeting the approval of the Owner. All items of the same type and rating shall be identical.

2.2 Trade names – unless specifically identified otherwise, manufacturers' names and catalog numbers indicated herein and on the drawings are not intended to be proprietary designations. They are to indicate general type and quality of materials and equipment required. Equipment and materials by other manufacturers which in the opinion of the Engineer are of equal quality and which will produce the same results will be considered acceptable.

2.3 Obtain approved shop drawings showing wiring diagrams, connection diagrams, roughing-in and hookup details, from other involved Contractors for all equipment and comply therewith.

2.4 Grounding – the entire electrical system, including equipment frames, conduit, switches, controllers, wireways, neutral conductors, and all other such equipment shall be permanently and effectively grounded in accordance with the NEC. Provide a separate ground conductor in all branch circuit conduits sized in accordance with the NEC.

2.5 Schedule of work – the schedule of the electrical work shall be arranged to suit the progress of work by the other trades and shall in no way retard progress of construction of the project.

2.6 Storage and materials – space will be assigned to the Contractor by the Owner for the storage of materials. This Contractor will be responsible for the protection and safekeeping of materials, tools, and equipment. All materials and equipment shall be kept in its assigned place until the time of its installation. Excess materials, dirt and refuse shall be promptly removed from the work site.

2.7 Coordination – cooperate and coordinate efforts with all Contractors on the project.

2.8 Guarantee of work – Contractor guarantees by his acceptance of the contract that all work installed is free from any and all defects in workmanship and/or materials, and that the apparatus will develop capacities and characteristics specified, and that if, during the period of one year or as otherwise specified, from date of certificate of completion and acceptance of the work any such defects in workmanship, material or performance appear, he will, without cost to the Owner, remedy such defects within a reasonable time to be specified in notice. In default thereof, the Owner may have such work done and charge cost to Contractor. Equipment guarantees from date of "start-up" will not be recognized.

#### SECTION 16210 – RACEWAY, FITTINGS AND BOXES

A. Raceways – conduit shall be hot-dipped, zinc coated or sherardized rigid steel (RS), intermediate metal conduit (IMC), or Schedule 40 PolyVinyl Chloride (PVC).

B. Flexible conduit shall be galvanized, continuous spiral, single strip type. Flexible conduit shall be covered with PVC jacket in wet or damp locations. Provide suitable fittings with ground connector.

C. Fittings – all conduit entering or leaving outlet, junction or pull boxes, and cabinets and all conduit stubs shall have bushings. Provide insulating bushie

D. ngs where required by NEC.

1. Fittings for RS and IMC shall be threaded type.

D. Fittings for PVC shall be PVC, primed and glued.

E. Conduit run outside of building shall be buried a minimum of 24" below finished grade.

F. Conduit run underground may be polyvinyl chloride (PVC) or RS or IMC conduit protected with 2 coats of bitumastic paint. Convert PVC to RS or IMC before rising out of soil.

#### SECTION 16220 – CONDUCTORS

A. Conductors and insulation – wire and cable shall be soft drawn, annealed copper with 600 volt color coded insulation. Minimum wire size shall be #12 awg. Insulation for branch circuits and feeders shall be type THHN-2-THWN-2 or XHHW-2. Conductors No. 10 AWG and smaller diameter shall be solid.

B. Provide a separate ground conductor in all raceways sized in accordance with the NEC.

C. Joints and terminations – for conductors #12 and #10 all fixture and branch circuits joints in junction and outlet boxes shall be made with UL listed pressure type connectors rated at 600 volts and 105 degrees C. Connectors shall be Ideal Industries "Wing-Nut" or Buchanan "B-Cap", 3M "Scotch-Lok" connectors or equal.

#### SECTION 16230 – WIRING DEVICES

A. Photocell switch shall be hermetically sealed cadmium-sulfide cell with single pole double-throw (SPDT) contacts for control of mechanically held contactors rated 1000 watts and 120 volts. Provide switch in a high-impact-resistant noncorroding and nonconductive molded plastic housing with a locking-type receptacle. A time delay shall prevent accidental switching from transient light sources. Provide a directional lens in front of the cell to prevent fixed light sources from creating a turnoff condition. Aim switch according to manufacturer's recommendations.

#### SECTION 16311 – CIRCUIT BREAKERS

A. Circuit breakers shall be provided as indicated on drawings and be fully compatible with panelboards. Circuit breakers shall conform to latest UL and NEMA standards and shall bear UL labels.

B. Circuit breakers shall be single, double pole, or three pole thermalmagnetic quick-make, quick-break trip-free on overload or short circuit alternating current circuit breakers with trip ratings and frame size as shown on the drawings. Branch circuit breakers shall provide inverse time delayed tripping on overloads and instantaneous tripping on short circuits. Trip indication shall be clearly shown by the breaker handle taking position between ON and OFF when the breaker is tripped. Double and three-pole breakers shall be common trip type. Sub-feed breakers are not acceptable.

C. Circuit breakers shall be fully rated for the available fault current, series ratings are not acceptable, unless stated otherwise on drawings.

D. Circuit breakers shall be installed in conformance with panelboard manufacturer's recommendations.

## GENERAL ELECTRICAL NOTES

**GENERAL:** UNLESS SPECIFICALLY INDICATED OTHERWISE, ALL WORK SHOWN ON ELECTRICAL DRAWINGS IS NEW WORK TO BE PROVIDED UNDER THIS CONTRACT.

**COORDINATION:** COORDINATE AND COOPERATE WITH ALL TRADES ON THE PROJECT. THE CONTRACTOR SHALL REVIEW ALL CONTRACT DOCUMENTS INCLUDING CIVIL AND LANDSCAPE DRAWINGS AND SPECIFICATIONS. CONTRACTOR SHALL COORDINATE AND ADJUST ACCORDINGLY AS DIRECTED BY THE ENGINEER.

**INSPECTIONS:** ARRANGE ALL NECESSARY INSPECTIONS. DELIVER ALL REQUIRED INSPECTION CERTIFICATES TO THE OWNER.

**J-BOX LABELING:** LABEL ALL JUNCTION BOXES WITH PERMANENT MARKER IDENTIFYING CIRCUIT NUMBER AND PANELBOARD OF CIRCUITS WITHIN.

**PANEL DIRECTORY:** PROVIDE TYPEWRITTEN PANELBOARD DIRECTORY CARD IN EACH PANELBOARD WITH CIRCUIT LOAD INFORMATION CLEARLY IDENTIFIED.

**CONDUCTORS:** IN SITUATIONS WHERE CONDUCTOR SIZES AND/OR QUANTITIES OF PARALLEL SETS HAVE BEEN INCREASED DUE TO VOLTAGE DROP OR FOR OTHER REASONS, CONTRACTOR SHALL PROVIDE THE APPROPRIATE LUG SIZES/QUANTITIES WITHIN THE EQUIPMENT CONNECTED (SWITCHBOARD, PANELBOARD, DISCONNECT SWITCH, TRANSFER SWITCH ETC.) TO PERMIT SATISFACTORY CONNECTION OF THE INDICATED CONDUCTORS. WHERE SUFFICIENT LUG SIZES AND/OR QUANTITIES CANNOT BE PROVIDED TO ACCOMMODATE THE CONDUCTORS INDICATED, THEN PROVIDE REDUCING ADAPTERS, PIN TERMINALS, OR A JUNCTION BOX TO SPLICE LARGER CONDUCTORS TO APPROPRIATELY SIZED SMALLER CONDUCTORS TO FIT INTO THE LUGS PROVIDED. ALL CONDUCTORS SHALL BE SIZED IN ACCORDANCE WITH THE NEC.

**CONNECTION DETAILS:** SECURE APPROVED SHOP DRAWINGS SHOWING WIRING DIAGRAMS, ROUGH-IN AND HOOK UP DETAILS FROM OTHER INVOLVED CONTRACTORS FOR EQUIPMENT WHICH MUST BE CONNECTED ELECTRICALLY.

## ELECTRICAL DEMOLITION NOTES

**GENERAL:** DEMOLITION DRAWINGS ARE BASED ON EXISTING PLANS AND FIELD INVESTIGATION PRIOR TO DEMOLITION. VISIT THE EXISTING BUILDING PRIOR TO BID IN ORDER TO BECOME FAMILIAR WITH THE EXISTING CONDITIONS AND IN ORDER TO AVOID CONFLICTS.

**DASHED ITEMS:** ALL ITEMS SHOWN DASHED ON DEMOLITION PLANS ARE EXISTING AND SHALL BE REMOVED.

**SOLID ITEMS:** ALL ITEMS SHOWN SOLID ON DEMOLITION PLANS ARE EXISTING TO REMAIN.

**CIRCUITING TO REMAIN:** EXISTING CIRCUITING TO REMAIN SHALL BE REROUTED OR RECONNECTED, AS REQUIRED, WHERE AFFECTED BY NEW WORK IN ORDER TO MAINTAIN CONTINUITY OF THE CIRCUIT.

**EXISTING CONDUIT:** ALL EXISTING CONDUITS AND WIRING THAT WILL NOT BE REUSED SHALL BE REMOVED. ALL CONDUIT REMOVED SHALL BE REMOVED IN ITS ENTIRETY, INCLUDING FITTINGS, MOUNTING DEVICES, MOUNTING HARDWARE, ETC.

**REPAIR DAMAGE:** EXERCISE CARE IN REMOVAL OF DEMOLITION ITEMS. REPAIR, AT NO ADDITIONAL COST TO THE OWNER, ANY DAMAGE CAUSED TO EXISTING CONSTRUCTION AND/OR EQUIPMENT TO REMAIN.

**ASSOCIATED APPURTENANCES:** REMOVE ALL ELECTRICAL APPURTENANCES (DISCONNECTS, STARTERS, WIRING, CONDUIT, ETC.) ASSOCIATED WITH EQUIPMENT TO BE REMOVED BY OTHERS.

**DEMOLISHED MATERIALS:** ALL MATERIALS REMOVED UNDER DEMOLITION, NOT TO BE RELOCATED OR DESIGNATED TO BE TURNED OVER TO THE OWNER, SHALL BECOME THE PROPERTY OF THE CONTRACTOR AND SHALL BE REMOVED COMPLETELY FROM THE SITE.

**SCHEDULE OUTAGES:** ALL WORK AND ALL POWER OUTAGES ON THE EXISTING SITE SHALL BE SCHEDULED AT TIMES CONVENIENT TO THE OWNER.

**NOTIFICATION:** NOTIFY THE OWNER PRIOR TO TURNING OFF ANY CIRCUITS.

## ELECTRICAL LEGEND

### LIGHTING

- ☒ GROUND MOUNTED FLOODLIGHT
- IN-GRADE LIGHTING FIXTURE
- ☉ PHOTOCCELL, 1500W, 120V, SPST, MOUNT ON ROOF, AIM NORTH

### POWER

- ⊕ WP WEATHERPROOF JUNCTION BOX
- ⊕ HANDHOLE
- ⊕ PAD MOUNTED TRANSFORMER
- ⊕ INDICATES FRONT

AND → ELECTRICAL CIRCUIT RUN IN CONDUIT AND CIRCUIT HOMERUN TO PANELBOARD (PANEL AND CIRCUIT DESIGNATION AS INDICATED). AS A MINIMUM CONDITION, EACH SINGLE PHASE CIRCUIT SHALL HAVE 1 #12 PHASE CONDUCTOR, 1 #12 NEUTRAL CONDUCTOR AND 1 #12 GROUNDING CONDUCTOR IN 3/4" CONDUIT. PROVIDE ADDITIONAL PHASE CONDUCTORS AS REQUIRED FOR "MULTIPLE PHASED" ELECTRICAL LOADS. MULTIPLE SINGLE PHASE CONDUCTORS MAY BE GROUPED TOGETHER IN A COMMON CONDUIT IN ACCORDANCE WITH THE NEC AND AT THE CONTRACTOR'S DISCRETION. GROUNDING CONDUCTORS MAY BE SHARED AS ALLOWED BY THE NEC. NEUTRAL CONDUCTORS SHALL NOT BE SHARED. MULTI-POLE BREAKERS SHALL BE PROVIDED IN ACCORDANCE WITH THE NEC SHOULD MULTI-WIRE BRANCH CIRCUITS BE INSTALLED. CONDUIT LARGER THAN 1/2" AND CONDUCTORS LARGER THAN #12 SHALL BE AS INDICATED.

### GENERAL

#### PHOTO NOTATION

- ENUMERATION: PHOTO NUMBER
- SHEET WHERE PHOTO IS TAKEN
- SHEET WHERE PHOTO IS SHOWN

#### NEW WORK NOTE SYMBOL

#### DEMOLITION NOTE SYMBOL

## ABBREVIATIONS

- A AMPERE
- AFG ABOVE FINISHED GRADE
- AIC AMPERE INTERRUPTING CAPACITY
- BFG BELOW FINISHED GRADE
- C CONDUIT
- CKT CIRCUIT
- CB CIRCUIT BREAKER
- DNCP DOMINION NORTH CAROLINA POWER
- EC EMPTY CONDUIT
- ETR EXISTING TO REMAIN
- EXIST EXISTING
- GFI GROUND FAULT INTERRUPTER
- GND GROUND
- KAIC THOUSAND AMPERE INTERRUPTING CAPACITY
- KVA KILO-VOLT-AMPERES
- KW KILO-WATTS
- MCB MAIN CIRCUIT BREAKER
- MLO MAIN LUGS ONLY
- MTD MOUNTED
- NEC NATIONAL ELECTRICAL CODE
- NTS NOT TO SCALE
- OC ON CENTER
- ∅ PHASE
- PRI PRIMARY
- REQ'D REQUIRED
- SE SERVICE ENTRANCE
- SEC SECONDARY
- TPY TYPICAL
- UON UNLESS OTHERWISE NOTED
- V VOLT(S)
- W WATTS/WIRE
- WP WEATHERPROOF

# Surface

Surface 678, PA.  
215 Morris Street, Suite 150  
Durham, NC 27701

www.surface678.com  
p : 919-419-1199  
f : 919-419-1669

### CONSULTANTS

#### CLEARSCAPES

311-200 W. MARTIN ST.  
RALEIGH, NC 27601  
T: 919 821 2775

#### RIGGS WARD DESIGN LC.

2316 W MAIN ST.  
RICHMOND, VA 23220  
T: 804 254 1740

#### PACE COLLABORATIVE PC.

1277 PERIMETER PKWY.  
VIRGINIA BEACH, VA 23454  
T: 757 499 7223

### REGISTRATION

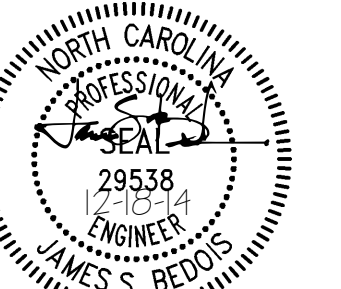

14094

### CLIENT



#### WHALEHEAD CLUB

CLUB ROAD  
COROLLA, NC 27927

#### CURRITUCK COUNTY

153 COURTHOUSE ROAD, SUITE  
204 CURRITUCK, NC 27929

## HISTORIC COROLLA PARK WHALEHEAD

CLUB ROAD  
COROLLA, NC 27927

## LANDSCAPE & PEDESTRIAN IMPROVEMENTS - PHASE I

NO.	REVISION	DATE
1	SITE PLAN RESUBMITTAL	10.16.14
2	BID FOR CONSTRUCTION	12.19.14

### ISSUE:

### CONSTRUCTION DOCUMENTS

PROJECT NO: A0000  
DATE: DECEMBER 19, 2014  
DRAWN: WRL  
CHECKED: JWS

### SHEET TITLE:

## ELECTRICAL GENERAL NOTES, LEGEND, ABBREVIATIONS & SPECIFICATIONS

# E001



### CONSULTANTS

**CLEARSCAPES**  
311-200 W. MARTIN ST.  
RALEIGH, NC 27601  
T: 919 821 2775

**RIGGS WARD DESIGN LC.**  
2315 W MAIN ST.  
RICHMOND, VA 23220  
T: 804 254 1740

**PACE COLLABORATIVE PC.**  
1277 PERIMETER PKWY.  
VIRGINIA BEACH, VA 23454  
T: 757 499 7223

### REGISTRATION

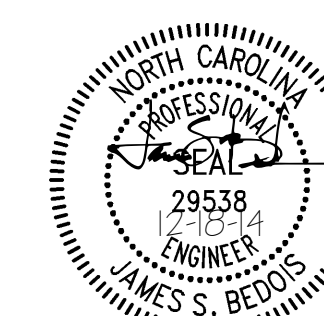

14094

### CLIENT



**WHALEHEAD CLUB**  
CLUB ROAD  
COROLLA, NC 27927

**CURRITUCK COUNTY**  
153 COURTHOUSE ROAD, SUITE  
204 CURRITUCK, NC 27929

**HISTORIC COROLLA PARK  
WHALEHEAD**

CLUB ROAD  
COROLLA, NC 27927

### LANDSCAPE & PEDESTRIAN IMPROVEMENTS - PHASE I

NO.	REVISION	DATE
1	SITE PLAN RESUBMITTAL	10.16.14
2	BID FOR CONSTRUCTION	12.19.14

### ISSUE: CONSTRUCTION DOCUMENTS

PROJECT NO: A0000  
DATE: DECEMBER 19, 2014  
DRAWN: WRL  
CHECKED: JWS

### SHEET TITLE:

**ELECTRICAL SITE  
PLAN**

**E101**

### EXISTING PANELBOARD S1 SCHEDULE (SQD HOMELINE)

200A MCB, 240/120 VOLT, 1 PHASE, 3 WIRE, 10 KAIC MINIMUM, SURFACE MOUNT, GROUND BUS

LOAD SERVED	LOAD (AMPS)		BKR TRIP	CKT NO.	PHASE		CKT NO.	BKR TRIP	LOAD (AMPS)		LOAD SERVED
	A	B			A	B			A	B	
SOUTHEAST TRAILER			50/2P	1			2	30/2P			NORTHEAST TRAILER
NORTHEAST TRAILER			30/1P	5			6	20/1P			SOUTHEAST TRAILER
SPARE			20/1P	7			8	20/1P	3.0		SIGN LIGHTING (NOTE 1)

NOTES:  
1. PROVIDE CIRCUIT BREAKER AND CONNECT LOAD INDICATED.

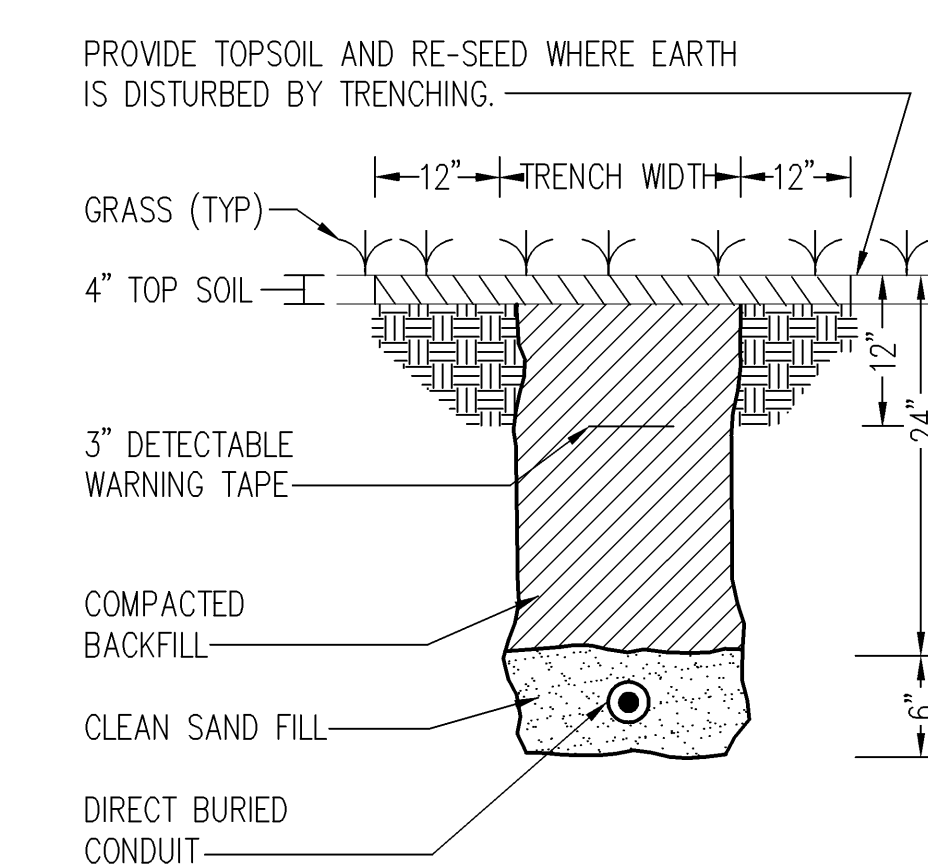

**TRENCH DETAIL - GRASS AREA**  
NO SCALE

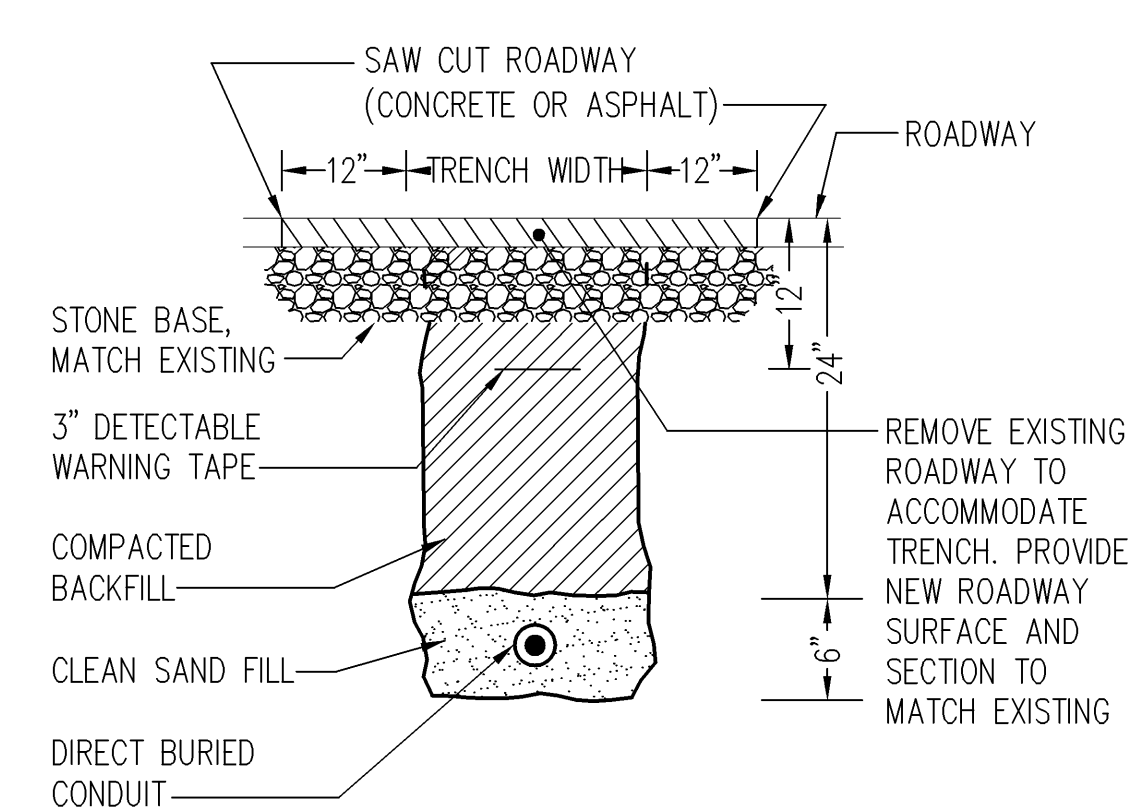

**TRENCH DETAIL - AT ROADWAY**  
NO SCALE



**PHOTO DETAIL**  
NO SCALE



**PHOTO DETAIL**  
NO SCALE

### NOTES THIS SHEET

- REMOVE EXISTING GROUND MOUNTED SIGN FLOOD LIGHT CIRCUIT FROM GUARD BUILDING AND LIGHTING FIXTURES SHALL REMAIN FOR REUSE.
- REMOVE EXISTING ABANDONED IN-GRADE FLOOD LIGHT AND ASSOCIATED APPURTENANCES COMPLETE.
- REMOVE EXISTING ABANDONED POLE BASE AND ASSOCIATED APPURTENANCES COMPLETE.
- DISCONNECT EXISTING ELECTRICAL SERVICE TO METER BASE AT GUARD BUILDING AND REMOVE ELECTRICAL SECONDARY SERVICE TO DNCP PAD MOUNT TRANSFORMER. VERIFY EXACT REQUIREMENTS AND COORDINATE SERVICE DISCONNECTION AT TRANSFORMER WITH DNCP.
- REMOVE EXISTING SEPTIC SYSTEM JUNCTION BOX AND ASSOCIATED APPURTENANCES COMPLETE.
- REMOVE EXISTING ABANDONED SERVICE RACK, METER BASE, SEPTIC SYSTEM CONTROL PANEL AND PANELBOARDS COMPLETE.

### NOTES THIS SHEET

- CONNECT EXISTING GROUND MOUNTED SIGN LIGHTS TO CIRCUIT INDICATED.

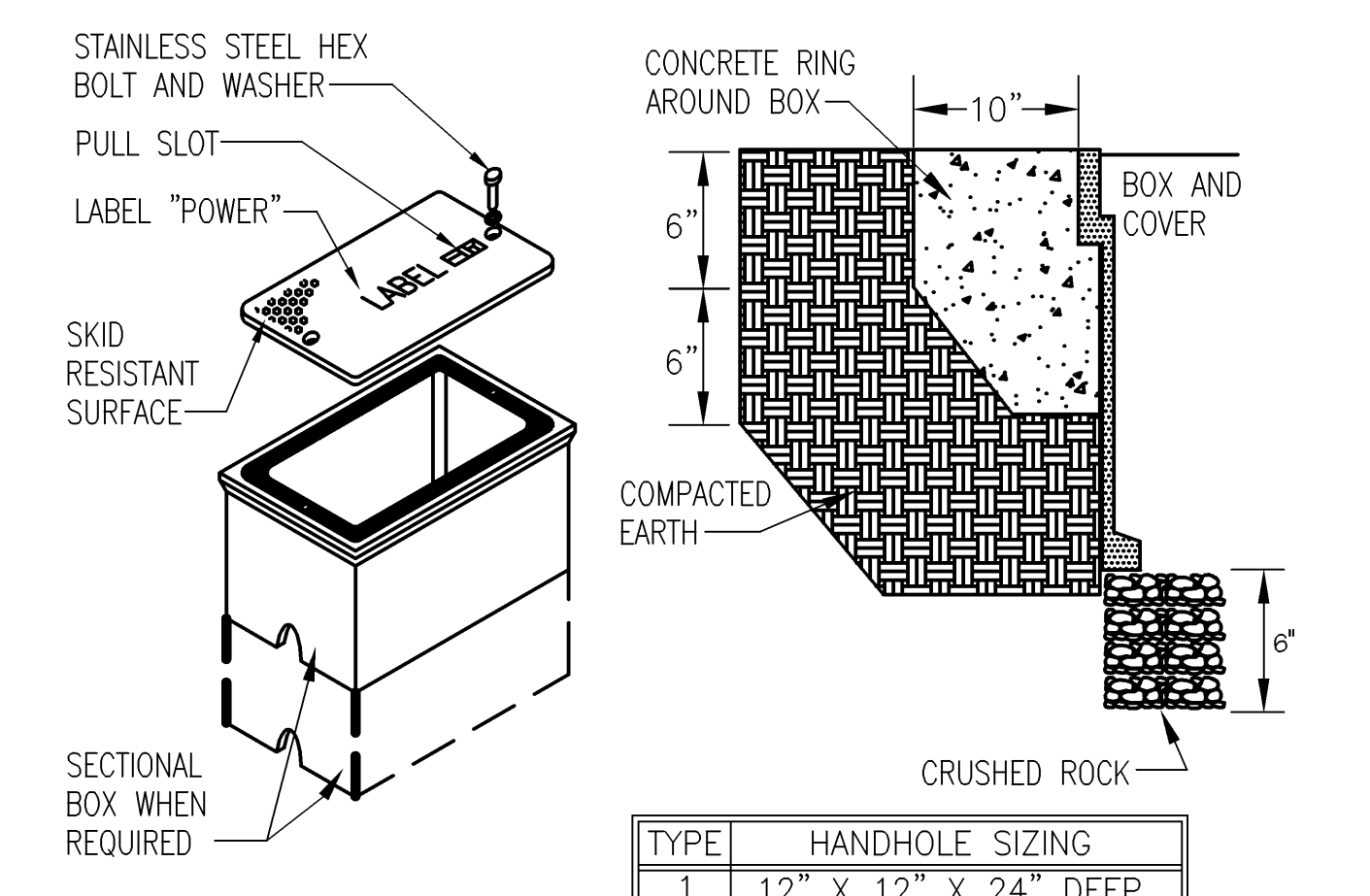

- HANDHOLE REQUIREMENTS**
- HOUSING SHALL BE A POLYMER CONCRETE REINFORCED WITH A HEAVY WEAVE FIBERGLASS REINFORCING WITH COMPRESSIVE STRENGTH OF NO LESS THAN 10,000 PSI.
  - COVER SHALL WITHSTAND A SERVICE LOAD OF NO LESS THAN 15,000 LBS OVER A 10" x 10" AREA FOR HEAVY DUTY, H2O LOADING.
  - PROVIDE STAINLESS STEEL BOLTS AND INSERTS.
  - PROVIDE WITH (2) 2 1/2" MOUSEHOLES.

**COMPOSITE/FIBERGLASS HANDHOLE**  
NO SCALE

### GRAPHIC SCALES

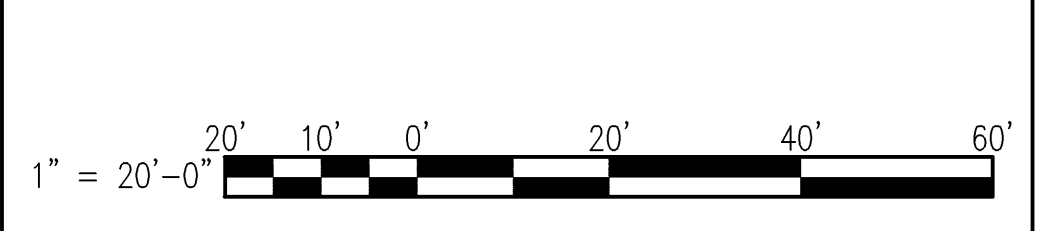

### ELECTRICAL SITE PLAN

SCALE: 1" = 20'-0"

