

HYDROSEEDING NOTES

SEED MIX : OUTER BANKS LAWN SEED MIXTURE
OR APPROVED EQUAL
100% BERMUDA

CONTRACTOR TO HAND SPREAD GRASS SEED LIBERALLY OVER THE DISTURBED AREA OF BACKFILL AND AREAS DAMAGED FROM WORK EQUIPMENT. COVER SEED WITH A BALE OF STRAW HAND SHAKEN TO COVER SEED AREA EVENLY.

GENERAL:
- FERTILIZER RATES SHOWN ARE GENERAL RECOMMENDATIONS; FREQUENCY AND AMOUNT OF FERTILIZATION CAN BEST BE DETERMINED THROUGH SITE SPECIFIC SOIL TESTING.
- MINIMUM GERMINATION RATE SHALL BE GREATER THAN 80%

- SATISFACTORY STABILIZATION AND EROSION CONTROL REQUIRES A COMPLETE VEGETATIVE COVER. EVEN SMALL BREACHES IN VEGETATIVE COVER CAN EXPAND RAPIDLY IF LEFT UNATTENDED. A SINGLE HEAVY RAIN IS OFTEN SUFFICIENT TO GREATLY ENLARGE BARE SPOTS, AND THE LONGER REPAIRS ARE DELAYED THE MORE COSTLY THEY BECOME. PROMPT ACTION WILL KEEP SEDIMENT LOSS AND REPAIR COST DOWN. NEW SEEDLINGS SHOULD BE INSPECTED FREQUENTLY AND MAINTENANCE PERFORMED AS NEEDED. IF RILLS AND GULLS DEVELOP THEY MUST BE FILLED, RE-SEED, AND MULCHED AS SOON AS POSSIBLE. DIVERSIONS MAY BE NEEDED UNTIL NEW PLANTS TAKE HOLD.

MAINTENANCE REQUIREMENTS EXTEND BEYOND THE SEEDING PHASE
- WEAR OR DAMAGED SPOTS MUST BE RELIEM, FERTILIZED, MULCHED AND RE-SEED AS PROMPTLY AS POSSIBLE. RE-FERTILIZATION MAY BE NEEDED TO MAINTAIN PRODUCTIVE STANDS.

LEGEND:

- - CALCULATED POINT
- 2.2 - SPOT ELEVATION (NAVD 88)
- ⊕ - BORING PIT
- B-1
- - PILES AND DEADMEN TO BE REMOVED
- - 6x6 PILES TO REMAIN
- ▨ - BOARDWALK TO REMAIN
- ▩ - BOARDWALK TO BE REMOVED

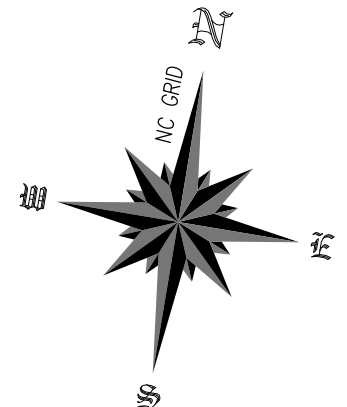

EXISTING FENCE BARRIER WITH TOP RAIL

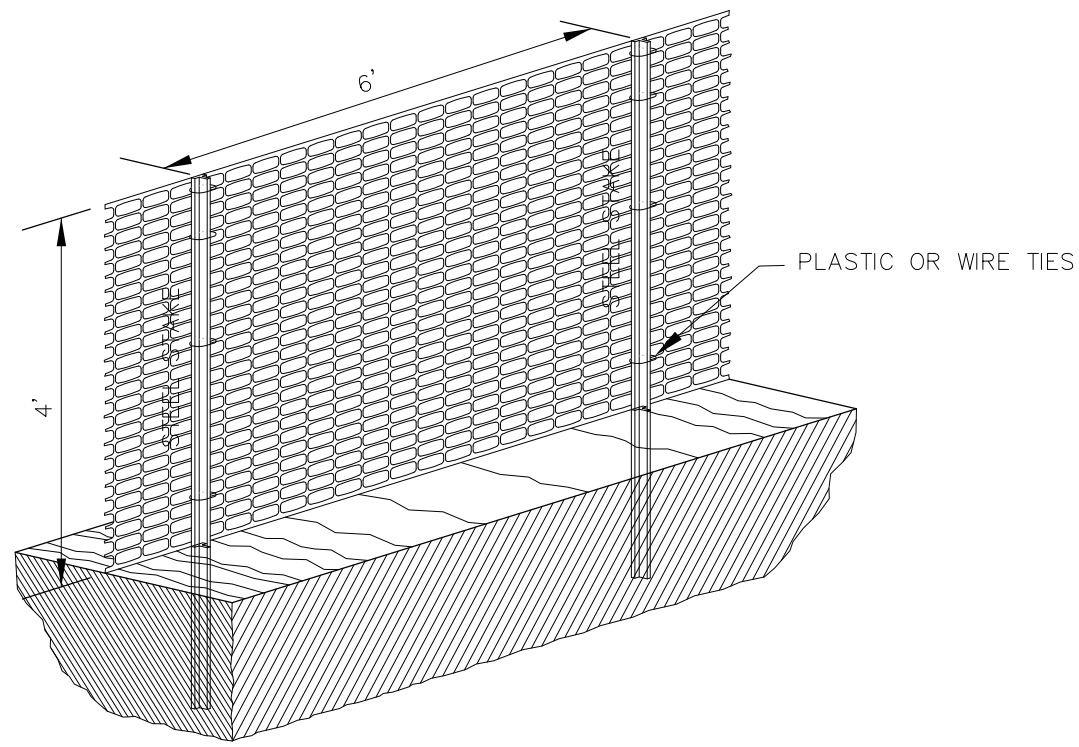

ORANGE SAFETY FENCE DETAIL
N.T.S.

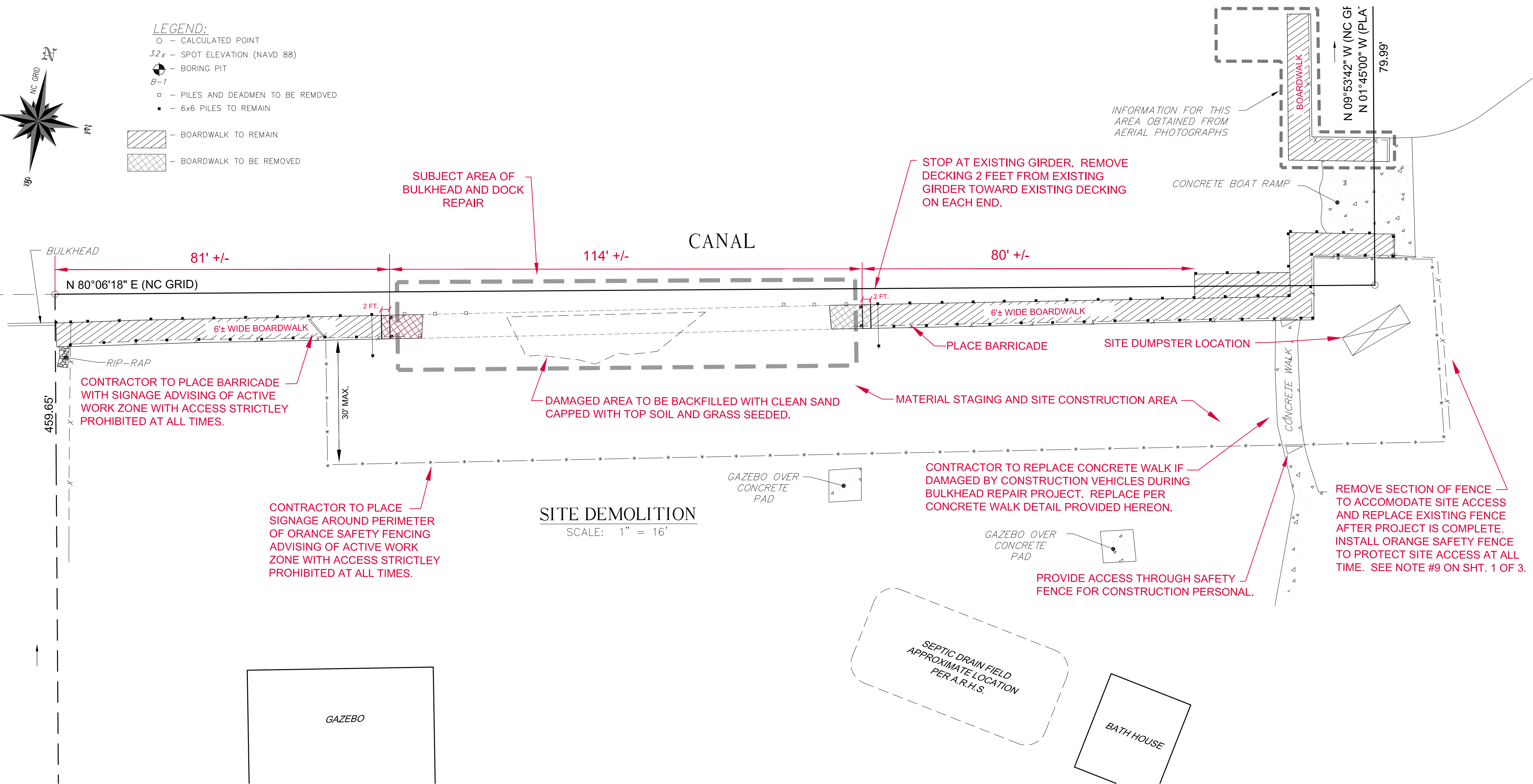

SITE DEMOLITION
SCALE: 1" = 16'

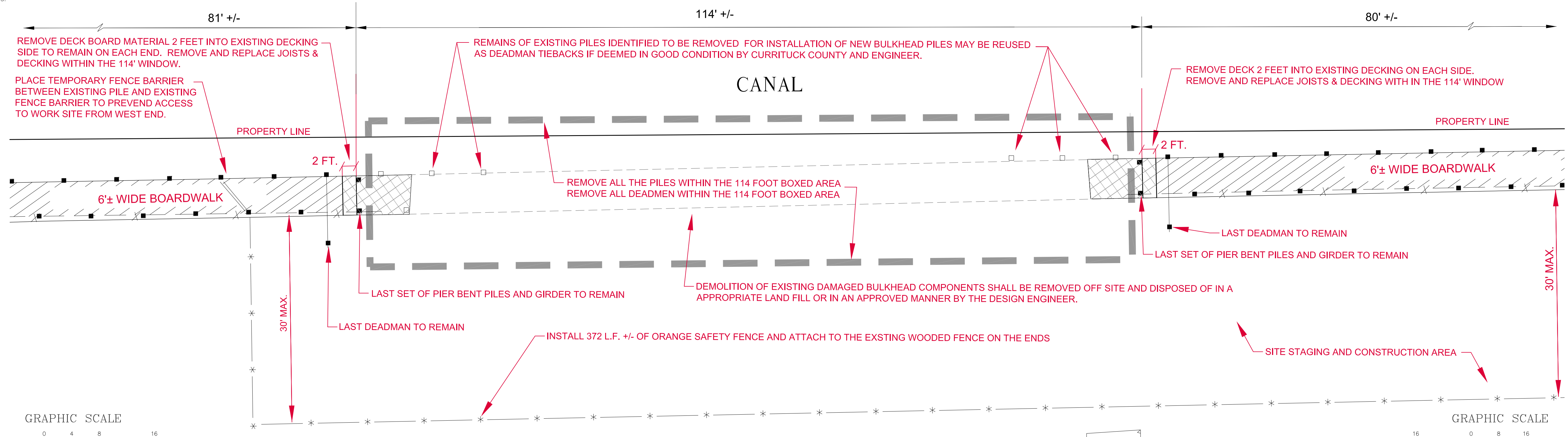

MAGNIFIED VIEW
SCALE: 1" = 8'

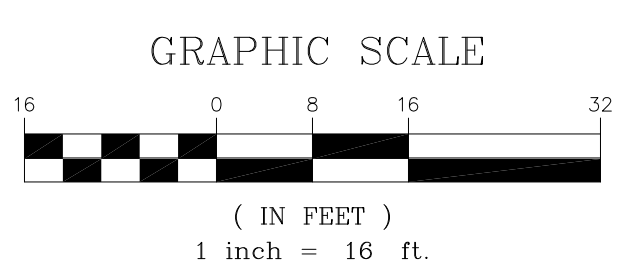
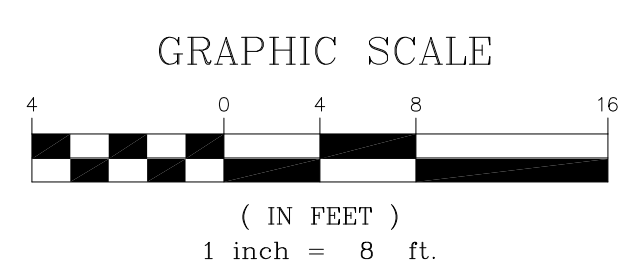

PRELIMINARY
NOT FOR CONSTRUCTION

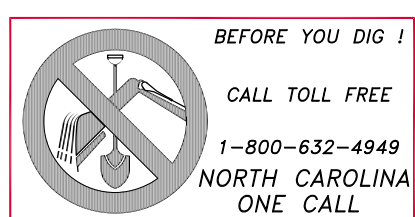

P.O. Box 1129
4425 Brockway
Kitty Hawk, NC 27949
(252)-261-4151
(252)-261-1333
C-0836

Coastal
ENGINEERING & SURVEYING, INC.
Civil - Structural
Site Development

THIS DOCUMENT IS THE PROPERTY OF COASTAL ENGINEERING & SURVEYING, INC. ALL RIGHTS ARE RESERVED. NO PART OF THIS DOCUMENT IS TO BE REPRODUCED OR TRANSMITTED IN ANY FORM OR BY ANY MEANS WITHOUT THE WRITTEN PERMISSION OF COASTAL ENGINEERING & SURVEYING, INC. COPYRIGHT LAWS WILL ENFORCE.

NO. DATE DESCRIPTION BY

DATE: 3/20/20 SCALE: AS SHOWN
CHECKED: CFG DRAWN: JCB/MMH
PROJECT NO: P722.20
CAD FILE: P722 SP1
SHEET: 2 of 3

CAROVA BEACH PARK BULKHEAD REPAIR
FOR: CURRITUCK COUNTY
FRUITVILLE BEACH TOWNSHIP CURRITUCK COUNTY NORTH CAROLINA
DEMOLITION PLAN