

LEGEND AND PLANT LIST					
QTY.	COMMON NAME	BOTANICAL NAME	SIZE/COND.	SPACING	REMARKS
15	Virginia Red Cedar	Juniperus virginiana	15 Gal. 6-7' Ht.	As Shown	Full/Dense
8	Sea Green Juniper	Juniperus spp.	3 Gal. Cont.	4' O.C.	Full/Well Branched
18	Pink Muhly Grass	Muhlenbergia capilaris	3 Gal. Cont.	3' O.C.	Full/Well Branched
18	Red Blanketflower	Gaillardia 'Mesa Red'	1 Gal. Cont.	2' O.C.	Staggered Rows

Seed Mix A		
8 ounces	Coreopsis	Coreopsis lanceolata
8 ounces	Gaillardia pulchella	Indian Blanket
8 ounces	Purple coneflower	Purple coneflower

Seed Mix B (Typical)		
8 ounces	Black eyed susan	Rudbeckia hirta
8 ounces	Goldenrod	Solidago sempervirens
8 ounces	Milkweed	Asclepias tuberosa
	White Yarrow	Achillea millefolium

Seed Mix B areas to receive 2,000 American Beach Grass plugs spaced at 3' on center.

**NOTES**

- ALL PLANTS SHALL MEET MINIMUM STANDARDS OUTLINED IN THE AMERICAN STANDARDS FOR NURSERY STOCK, (LATEST EDITION) PUBLISHED BY THE AMERICAN ASSOCIATION OF NURSERMEN, INC.
- PLANTS SHALL BE SOUND, HEALTHY AND WOODRUS, BE WELL BRANCHED AND DENSELY FOLIATED WHEN IN LEAF. PLANTS SHALL BE FREE OF DISEASE, PESTS, EGGS/LARVAE AND THEY SHALL BE FREE OF DAMAGE. DAMAGE INCLUDES, BUT IS NOT LIMITED TO SCRAPES ON THE BARK OR EVIDENCE OF GRUBBING FROM WORMS OR OTHER STAKING/BINDING MATERIAL.
- CONTAINER PLANTS SHALL BE FREE OF SEVERE ROOT BOUND CONDITIONS. CONTRACTOR TO LIGHTLY SCRAPE/LOOSEN OUTER ROOTS AT TIME OF PLANTING.
- ALL PLANTS SHALL BE PURCHASED FROM BONA-FIDE WHOLESALE NURSERIES AND/OR GROWERS.
- PLANTS SHALL BE COVERED BY TARP OR WITHIN ENCLOSED TRUCK DURING TRANSPORT TO SITE.
- SUBSTITUTIONS SHALL BE APPROVED BY THE OWNER OR THEIR DESIGNATED REPRESENTATIVE.
- DESIGNATED MULCH AREAS TO BE MULCHED WITH A 4" DEPTH OF CLEAN, UN-DYED, TRIPLE SHREDDED HARDWOOD MULCH.
- PLANT QUANTITIES SHOWN IN PLANTING LIST IS FOR CONTRACTOR CONFORMANCE ONLY. IT IS THE CONTRACTORS RESPONSIBILITY TO OBTAIN QUANTITIES BASED ON PLANTS SHOWN ON THE DRAWING.
- ANY EXISTING TREES AND PHYSICAL IMPROVEMENTS ARE SHOWN FOR REFERENCE ONLY. ADDITIONAL TREES/IMPROVEMENTS NOT SHOWN MAY EXIST ON SITE.
- ALL PLANTS TO RECEIVE A SOIL ADDITIVE AT TIME OF PLANTING. SOIL ADDITIVE SHALL CONSIST OF ONE PART TOPSOIL TO ONE PART SAND. BOTH SAND AND TOPSOIL SHALL BE FREE OF ROCKS OR OTHER MATERIAL AND SHALL BE THOROUGHLY MIXED PRIOR TO PLANTING.
- ALL PLANTS TO BE LIGHTLY DAMPED AFTER PLANTING TO ELIMINATE AIR POCKETS AND TO FIRMLY STABILIZE PLANTING.
- ALL MULCHED LANDSCAPE BEDS TO BE BORDERED BY A TRENCHED EDGE.
- ALL LANDSCAPED BEDS TO RECEIVE A 1 FOOT DEPTH OF CLEAN SAND PRIOR TO PLANTING.
- CONTRACTOR TO WARRANTY PLANTS FOR ONE YEAR.
- CONTRACTOR TO LOCATE ALL UTILITY SERVICE LINES (INCLUDING WATER) THAT SERVICE BUILDINGS PRIOR TO DEMOLITION/PLANTING.

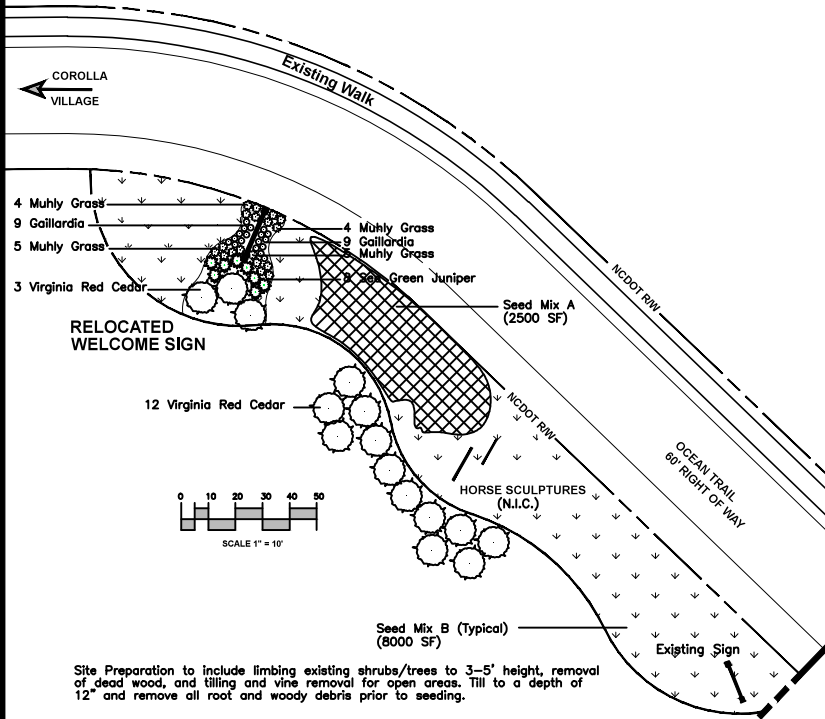

**County Line**

**ISSUED FOR BID**

**Corolla Beautification Project**  
Currituck County, North Carolina

October 1, 2017

DWG CBP 1

Designed by:

**LAUGHING GULL DESIGN STUDIO**  
LANDSCAPE ARCHITECTURE • LAND PLANNING • ENVIRONMENTAL CONSULTING  
KITTY HAWK, NORTH CAROLINA 27949  
PHONE (252) 261-8747

Greenspace

Landscape Planning & Design

Haga Head, NC 27859  
252-475-9240

**811**

Know what's below.  
Call before you dig.

