

ATLANTIC OCEAN

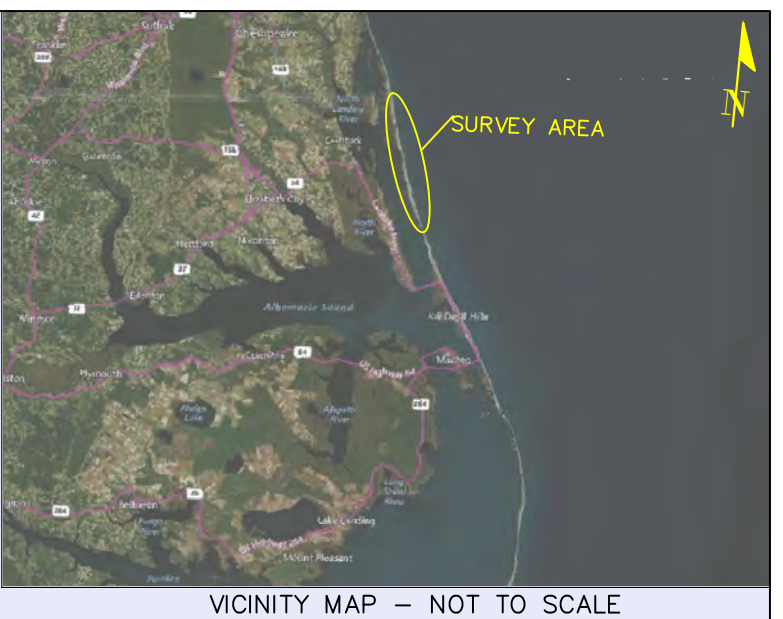

NORTH SURVEY LIMIT

SOUTH SURVEY LIMIT

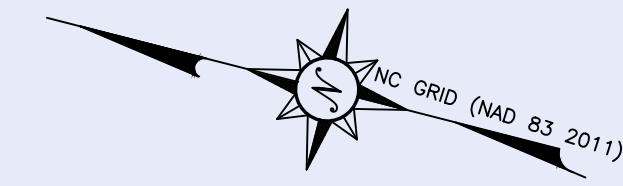
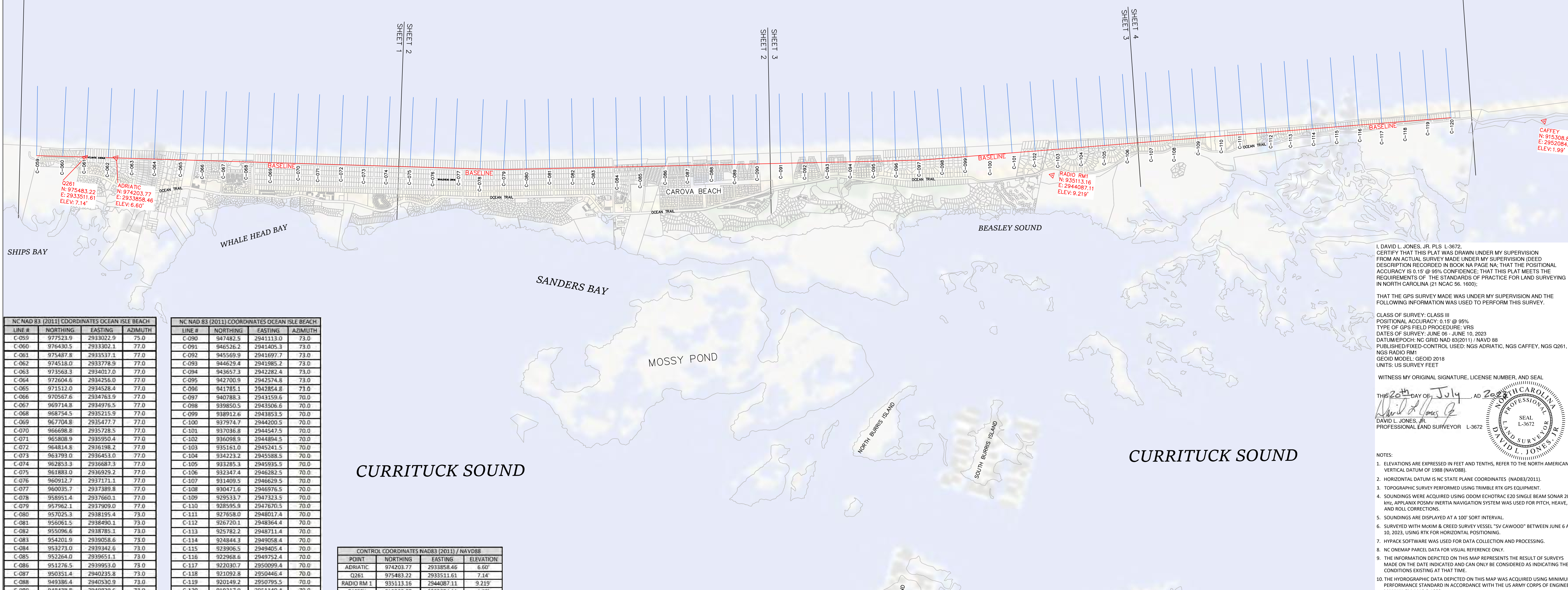

LINE #	NORTHING	EASTING	AZIMUTH
C-058	977523.9	2933022.9	75.0
C-059	976430.5	2933302.1	77.0
C-060	975487.8	2933537.1	77.0
C-061	974518.0	2933778.9	77.0
C-062	973563.3	2934017.0	77.0
C-063	972604.6	2934256.0	77.0
C-064	971512.0	2934528.4	77.0
C-065	970567.6	2934763.9	77.0
C-066	969714.8	2934976.5	77.0
C-067	968754.5	2935215.9	77.0
C-068	967704.8	2935477.7	77.0
C-069	966698.8	2935728.5	77.0
C-070	965808.9	2935950.4	77.0
C-071	964814.8	2936198.2	77.0
C-072	963793.0	2936451.0	77.0
C-073	962833.3	2936687.3	77.0
C-074	961883.0	2936929.2	77.0
C-075	960912.7	2937171.1	77.0
C-076	960035.7	2937389.8	77.0
C-077	958951.4	2937660.1	77.0
C-078	957962.1	2937909.0	77.0
C-079	957025.3	2938195.4	73.0
C-080	956061.5	2938490.1	73.0
C-081	955096.6	2938785.1	73.0
C-082	954201.9	2939058.6	73.0
C-083	953273.0	2939342.6	73.0
C-084	952264.0	2939651.1	73.0
C-085	951276.5	2939953.0	73.0
C-086	950351.4	2940235.8	73.0
C-087	949386.4	2940530.9	73.0
C-088	948438.8	2940820.6	73.0

LINE #	NORTHING	EASTING	AZIMUTH
C-090	947482.5	2941113.0	73.0
C-091	946526.2	2941405.3	73.0
C-092	945569.9	2941697.7	73.0
C-093	944629.4	2941985.2	73.0
C-094	943657.3	2942282.4	73.0
C-095	942700.9	2942574.8	73.0
C-096	941785.1	2942854.8	73.0
C-097	940788.3	2943159.6	70.0
C-098	939850.5	2943506.6	70.0
C-099	938912.6	2943853.5	70.0
C-100	937974.7	2944200.5	70.0
C-101	937036.8	2944547.5	70.0
C-102	936098.9	2944894.5	70.0
C-103	935161.0	2945241.5	70.0
C-104	934223.2	2945588.5	70.0
C-105	933285.3	2945935.5	70.0
C-106	932347.4	2946282.5	70.0
C-107	931409.5	2946629.5	70.0
C-108	930471.6	2946976.5	70.0
C-109	929533.7	2947323.5	70.0
C-110	928595.9	2947670.5	70.0
C-111	927658.0	2948017.4	70.0
C-112	926720.1	2948364.4	70.0
C-113	925782.2	2948711.4	70.0
C-114	924844.3	2949058.4	70.0
C-115	923906.5	2949405.4	70.0
C-116	922968.6	2949752.4	70.0
C-117	922030.7	2950099.4	70.0
C-118	921092.8	2950446.4	70.0
C-119	920154.9	2950793.5	70.0
C-120	919217.0	2951140.4	70.0

POINT	NORTHING	EASTING	ELEVATION
ADRIATIC	974203.77	2933858.46	6.60'
Q261	975483.22	2933511.61	7.14'
RADIO RM1	935113.16	2944087.11	9.219'
CAFFEY	915308.87	2952084.11	1.99'

I, DAVID L. JONES, JR. PLS L-3672, CERTIFY THAT THIS PLAT WAS DRAWN UNDER MY SUPERVISION FROM AN ACTUAL SURVEY MADE UNDER MY SUPERVISION (DEED DESCRIPTION RECORDED IN BOOK NA PAGE NA; THAT THE POSITIONAL ACCURACY IS 0.15' @ 95% CONFIDENCE; THAT THIS PLAT MEETS THE REQUIREMENTS OF THE STANDARDS OF PRACTICE FOR LAND SURVEYING IN NORTH CAROLINA (21 NCAC 56.1600); THAT THE GPS SURVEY WAS MADE UNDER MY SUPERVISION AND THE FOLLOWING INFORMATION WAS USED TO PERFORM THIS SURVEY.

CLASS OF SURVEY: CLASS III
 POSITIONAL ACCURACY: 0.15' @ 95%
 TYPE OF GPS FIELD PROCEDURE: VRS
 DATES OF SURVEY: JUNE 06 - JUNE 10, 2023
 DATUM/EPOCH: NC GRID NAD 83(2011) / NAVD 88
 PUBLISHED/FIXED-CONTROL USED: NGS ADRIATIC, NGS CAFFEY, NGS Q261, & NGS RADIO RM1
 GEOID MODEL: GEOID 2018
 UNITS: US SURVEY FEET

WITNESS MY ORIGINAL SIGNATURE, LICENSE NUMBER, AND SEAL
 THIS 20th DAY OF July, AD 2023

 DAVID L. JONES, JR.
 PROFESSIONAL LAND SURVEYOR L-3672

- NOTES:
- ELEVATIONS ARE EXPRESSED IN FEET AND TENTHS, REFER TO THE NORTH AMERICAN VERTICAL DATUM OF 1988 (NAVD88).
 - HORIZONTAL DATUM IS NC STATE PLANE COORDINATES (NAD83/2011).
 - TOPOGRAPHIC SURVEY PERFORMED USING TRIMBLE RTK GPS EQUIPMENT.
 - SOUNDINGS WERE ACQUIRED USING ODOM ECHOTRAC E20 SINGLE BEAM SONAR 200 kHz, APPLANIX POSMV INERTIA NAVIGATION SYSTEM WAS USED FOR PITCH, HEAVE, AND ROLL CORRECTIONS.
 - SOUNDINGS ARE DISPLAYED AT A 100' SORT INTERVAL.
 - SURVEYED WITH MCKIM & CREED SURVEY VESSEL "SV CAWOOD" BETWEEN JUNE 6 AND 10, 2023, USING RTK FOR HORIZONTAL POSITIONING.
 - HYPACK SOFTWARE WAS USED FOR DATA COLLECTION AND PROCESSING.
 - NC ONMAP PARCEL DATA FOR VISUAL REFERENCE ONLY.
 - THE INFORMATION DEPICTED ON THIS MAP REPRESENTS THE RESULT OF SURVEYS MADE ON THE DATE INDICATED AND CAN ONLY BE CONSIDERED AS INDICATING THE CONDITIONS EXISTING AT THAT TIME.
 - THE HYDROGRAPHIC DATA DEPICTED ON THIS MAP WAS ACQUIRED USING MINIMUM PERFORMANCE STANDARD IN ACCORDANCE WITH THE US ARMY CORPS OF ENGINEERS MANUAL EM 1110-2-1003.

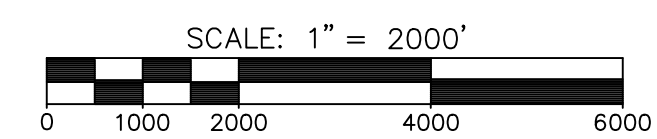

MCKIM & CREED
 243 NORTH FRONT STREET
 WILMINGTON, NORTH CAROLINA 28401
 TELEPHONE: (910) 343-1048
 FAX: (910) 251-8282
 NORTH CAROLINA FIRM LICENSE NUMBER: F-1222

BEACH MONITORING SURVEY
 FOR
COUNTY OF CURRITUCK
 COASTAL PROTECTION ENGINEERING OF NORTH CAROLINA, Inc.
 CITY OF CAROVA BEACH, COUNTY OF CURRITUCK, NORTH CAROLINA
 10 JULY 2023

JOB NUMBER: 08342-0002
 SCALE: 1" = 2000'
 CAD NUMBER: VT-083420002.2023-070
 DJL:
 PARTY CHIEF: DJL
 CAD TECH: MAH
 FIELD BOOK/PAGE: W1972/53-66, W2165/17-42
 DRAWING NUMBER: 2023-070
OVERVIEW



SHEET 1
SHEET 2

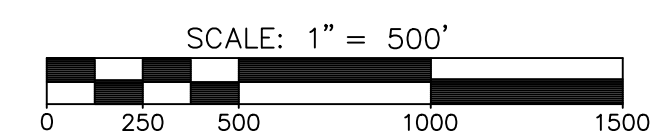
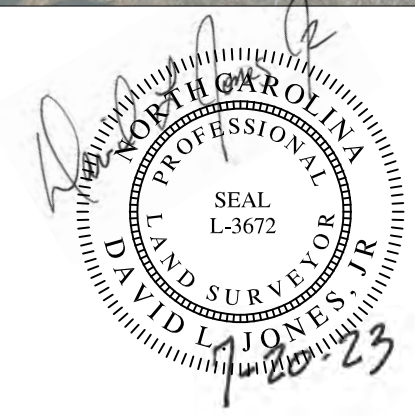

MCKIM & CREED
243 NORTH FRONT STREET
WILMINGTON, NORTH CAROLINA 28401
TELEPHONE: (910) 343-1048
FAX: (910) 251-8282
NORTH CAROLINA FIRM LICENSE NUMBER: F-1222

BEACH MONITORING SURVEY
FOR
COUNTY OF CURRITUCK
COASTAL PROTECTION ENGINEERING OF NORTH CAROLINA, Inc.
CITY OF CAROVA BEACH, COUNTY OF CURRITUCK, NORTH CAROLINA
10 JULY 2023

JOB NUMBER: 08342-0002
SCALE: 1" = 500'
CAD NUMBER: VT-083420002.2023-070
DLJ: DLJ
PARTY CHIEF: JTL
CAD TECH: MAH
FIELD BOOK/PAGE: W1972/53-66, W2165/17-42
DRAWING NUMBER: 2023-070
SHEET 1 OF 4

SHEET 1
SHEET 2

SHEET 2
SHEET 3

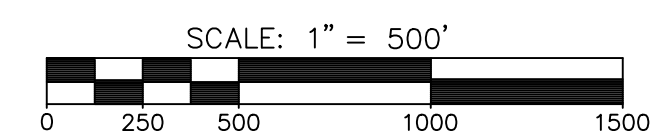
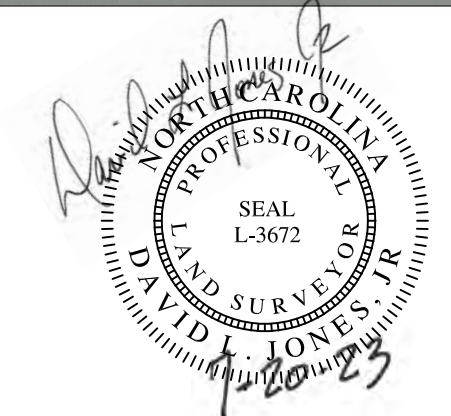
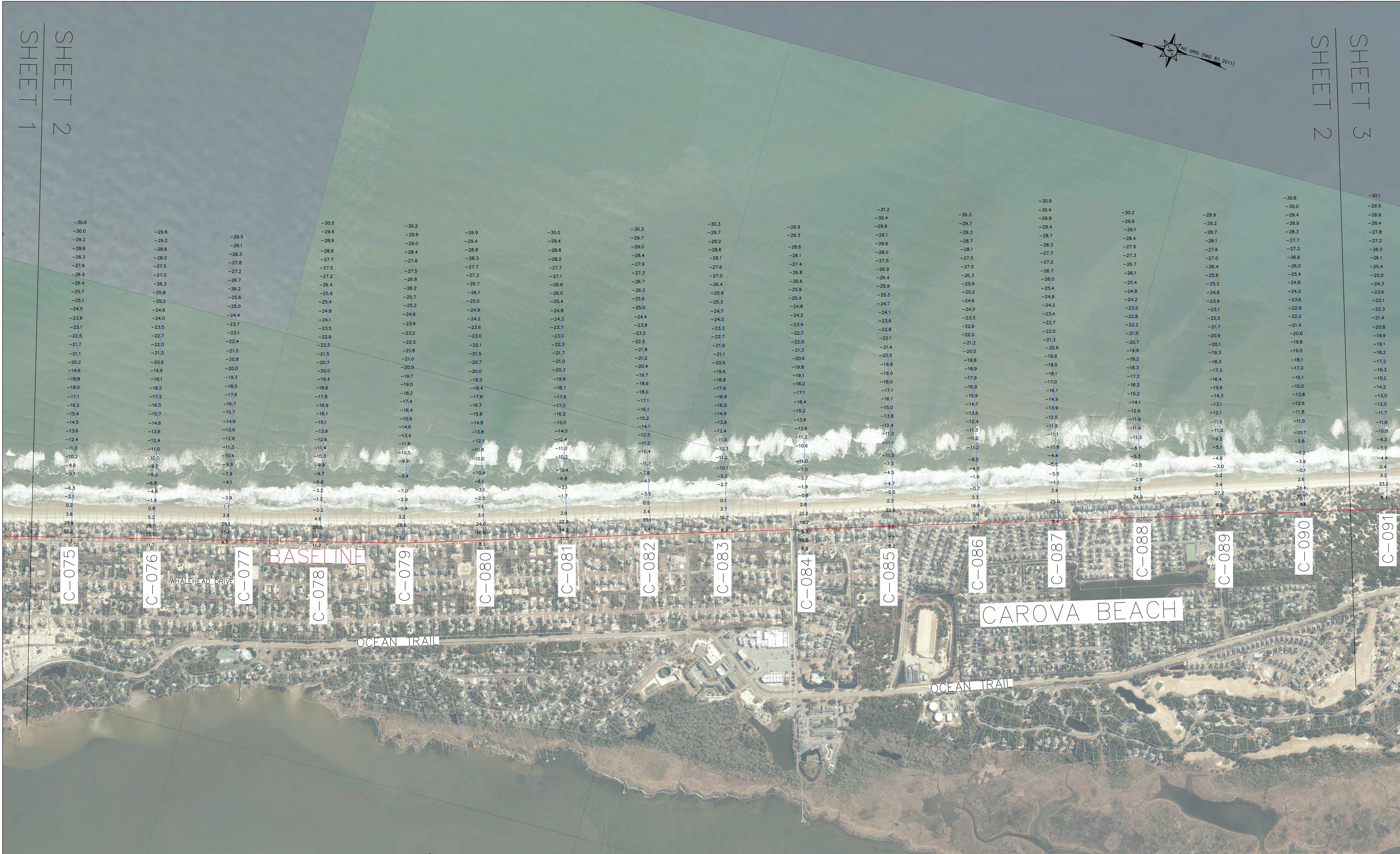

MCKIM & CREED
243 NORTH FRONT STREET
WILMINGTON, NORTH CAROLINA 28401
TELEPHONE: (910) 343-1048
FAX: (910) 251-8282
NORTH CAROLINA FIRM LICENSE NUMBER: F-1222

BEACH MONITORING SURVEY
FOR
COUNTY OF CURRITUCK
COASTAL PROTECTION ENGINEERING OF NORTH CAROLINA, Inc.
CITY OF CAROVA BEACH, COUNTY OF CURRITUCK, NORTH CAROLINA
10 JULY 2023

JOB NUMBER: 08342-0002
SCALE: 1" = 500'
CAD NUMBER: VT-083420002.2023-070
DLJ: DLJ
PARTY CHIEF: JTL
CAD TECH: MAH
FIELD BOOK/PAGE: W1972/53-66, W2165/17-42
DRAWING NUMBER: 2023-070
SHEET 2 OF 4



SHEET 4
SHEET 3

SHEET 3
SHEET 2

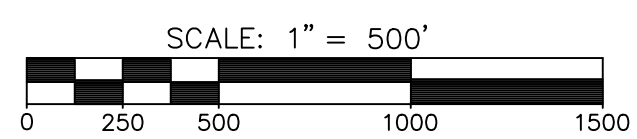
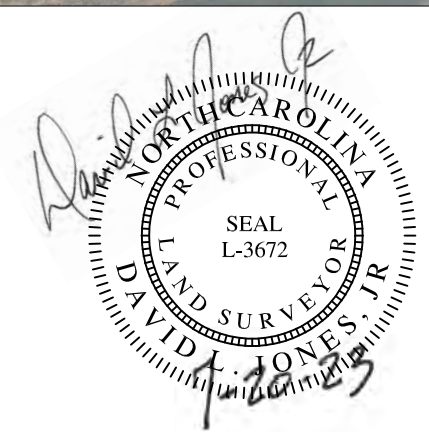

MCKIM & CREED
 243 NORTH FRONT STREET
 WILMINGTON, NORTH CAROLINA 28401
 TELEPHONE: (910) 343-1048
 FAX: (910) 251-8282
 NORTH CAROLINA FIRM LICENSE NUMBER: F-1222

BEACH MONITORING SURVEY
 FOR
COUNTY OF CURRITUCK
 COASTAL PROTECTION ENGINEERING OF NORTH CAROLINA, Inc.
 CITY OF CAROVA BEACH, COUNTY OF CURRITUCK, NORTH CAROLINA
 10 JULY 2023

JOB NUMBER: 08342-0002
 SCALE: 1" = 500'
 CAD NUMBER: VT-083420002.2023-070
 DLJ:
 PARTY CHIEF: JTL
 CAD TECH: MAH
 FIELD BOOK/PAGE: W1972/53-66_W2165/17-42
 DRAWING NUMBER: 2023-070
SHEET 3 OF 4

SHEET 4
SHEET 3

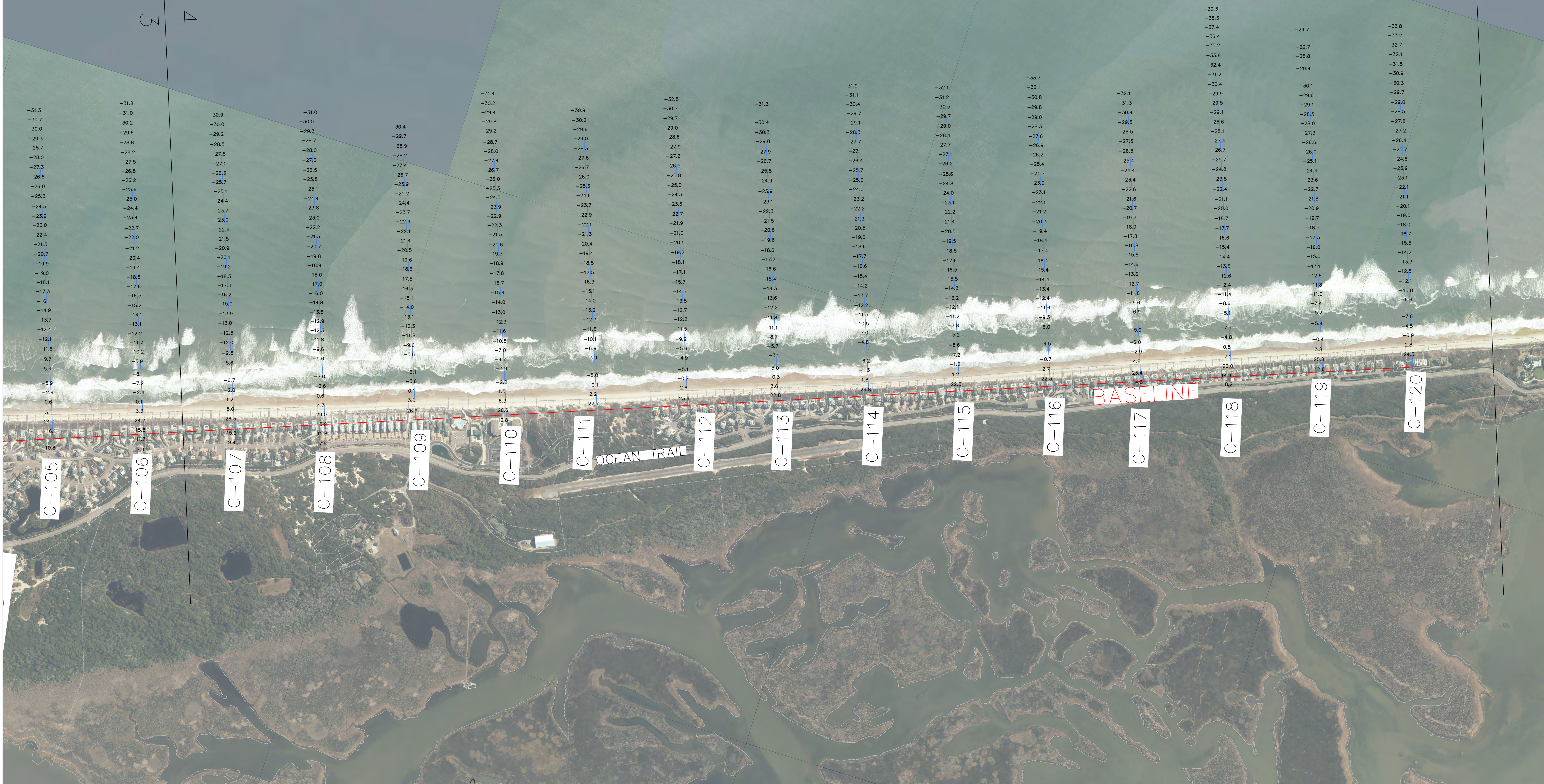

C-105 C-106 C-107 C-108 C-109 C-110 C-111 C-112 C-113 C-114 C-115 C-116 C-117 C-118 C-119 C-120

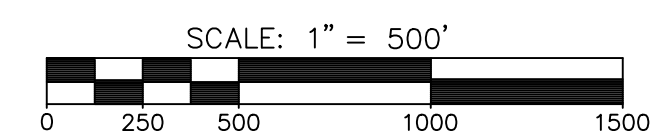

MCKIM & CREED
243 NORTH FRONT STREET
WILMINGTON, NORTH CAROLINA 28401
TELEPHONE: (910) 343-1048
FAX: (910) 251-8282
NORTH CAROLINA FIRM LICENSE NUMBER: F-1222

BEACH MONITORING SURVEY
FOR
COUNTY OF CURRITUCK
COASTAL PROTECTION ENGINEERING OF NORTH CAROLINA, Inc.
CITY OF CAROVA BEACH, COUNTY OF CURRITUCK, NORTH CAROLINA
10 JULY 2023

JOB NUMBER: 08342-0002
SCALE: 1" = 500'
CAD NUMBER: VT-083420002.2023-070
DLJ: DLJ
PARTY CHIEF: JTL
CAD TECH: MAH
FIELD BOOK/PAGE: W1972/53-66, W2165/17-42
DRAWING NUMBER: 2023-070
SHEET 4 OF 4